

- Legend**
- ■ ■ City Boundary
  - ▭ Proposed Development Boundary
  - ▨ Proposed Road Development
  - ▭ Mammal Survey Area
  - Badger Signs
  - ▨ Areas of Dense Vegetation- Partially Inaccessible

San áireamh tá sonraíocht Shuirbhéireacht Ordánais Éireann arna atáirgeadh faoi Cheadúnas OSI Uimh. 2010/18CCMA/Comhairle Contae na Gaillimhe. Sáraitonn atáirgeadh neamh-daralthe cóipeacht Shuirbhéireacht Ordánais Éireann agus Rialtas na hÉireann. © Suirbhéireacht Ordánais Éireann, 2010.

© Suirbhéireacht Ordánais Éireann. Gach ceart ar chosaint. Uimhír cheadúnais 2010/18CCMA/Comhairle Contae na Gaillimhe.

Includes Ordnance Survey Ireland data reproduced under OSI Licence number 2010/18CCMA/Galway County Council. Unauthorised reproduction infringes Ordnance Survey Ireland and Government of Ireland copyright. © Ordnance Survey Ireland, 2010.

© Ordnance Survey Ireland. All rights reserved. Licence number 2010/18CCMA/Galway County Council.

**Clients**

Comhairle Chontae na Gaillimhe  
Galway County Council

**Galway City Transport Project**

**ARUP**

Corporate House  
City East Business Park  
Ballybirt, Galway, Ireland

Tel +353 (0)91 460675  
www.N6GalwayCity.ie  
www.arup.ie

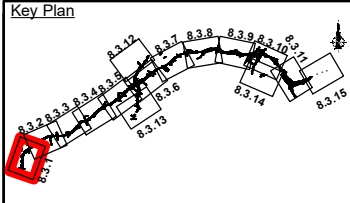

**Consultant**

**ARUP**

Corporate House  
City East Business Park  
Ballybirt, Galway, Ireland

Tel +353 (0)91 460675  
www.N6GalwayCity.ie  
www.arup.ie

**Job Title**

**N6 Galway City Ring Road**

**Scale: 1:5,000**

**Date: September 2018**

I1	28/09/2018	AG	MH	EMC
Issue	Date	By	Chkd	Appd

**Drawing Title**

Mammal Survey Study Area and Results

Sheet 01 of 15

Drawing Status

**For Information**

Job No	Drawing No	Issue
233985-00	Figure 8.3.1	I1

**EIA REPORT**

- Legend**
- ■ ■ ■ City Boundary
  - Proposed Development Boundary
  - ▬ Proposed Road Development
  - ▭ Mammal Survey Area
  - Badger Signs
  - ▨ Areas of Dense Vegetation- Partially Inaccessible

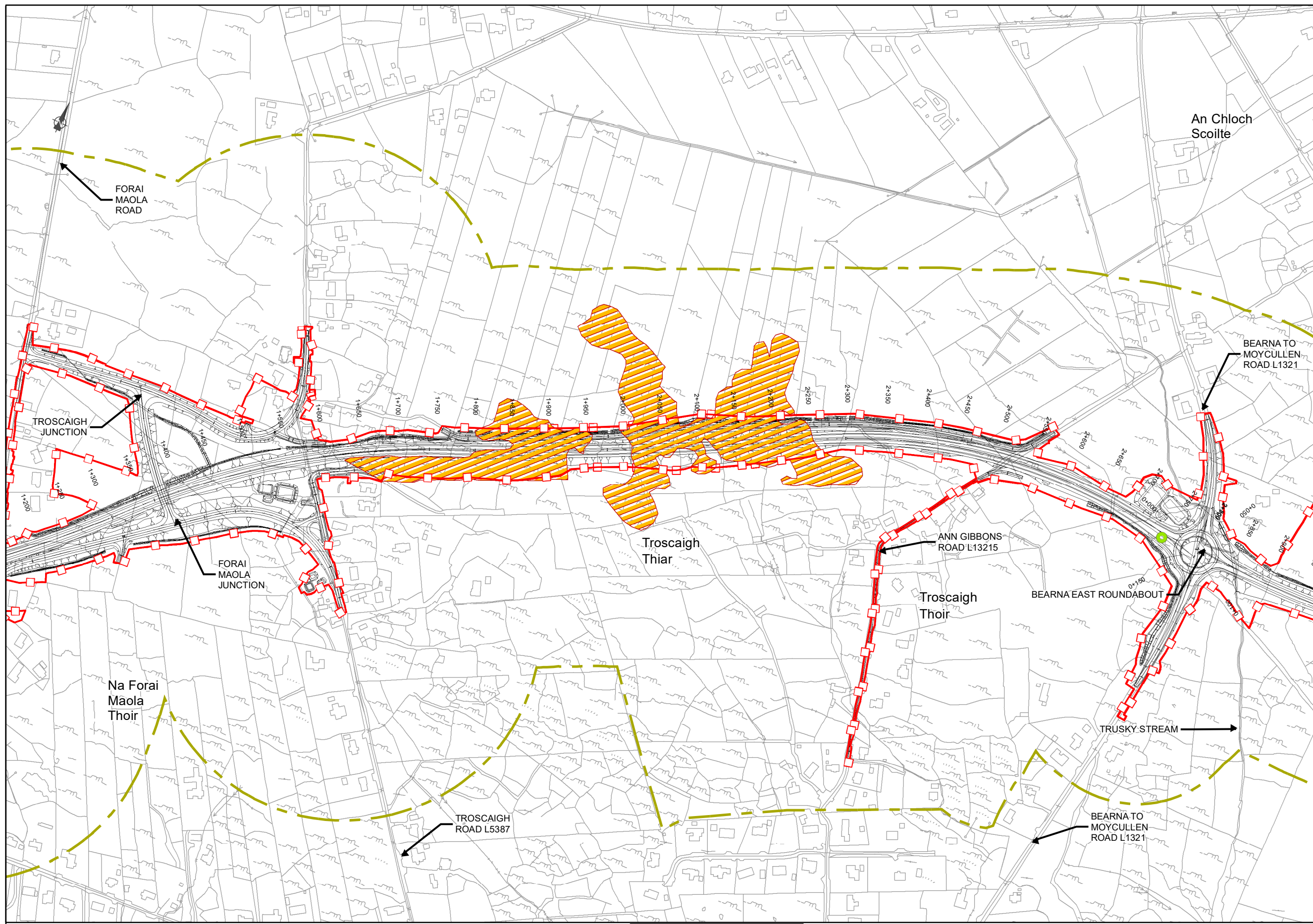

San áireamh tá sonraíocht Shuirbhéireacht Ordánais Éireann arna atáirgeadh faoi Cheadúnas OSI Uimh. 2010/18CCMA/Comhairle Contae na Gaillimhe. Sáraíonn atáirgeadh neamh-daralthe cóipeacht Shuirbhéireacht Ordánais Éireann agus Rialtas na hÉireann. © Suirbhéireacht Ordánais Éireann, 2010.  
 © Suirbhéireacht Ordánais Éireann. Gach ceart ar chosaint.  
 Uimhreachúnais 2010/18CCMA/Comhairle Contae na Gaillimhe.  
 Includes Ordnance Survey Ireland data reproduced under OSI Licence number 2010/18CCMA/Galway County Council.  
 Unauthorised reproduction infringes Ordnance Survey Ireland and Government of Ireland copyright. © Ordnance Survey Ireland, 2010.  
 © Ordnance Survey Ireland. All rights reserved. Licence number 2010/18CCMA/Galway County Council.

Clients

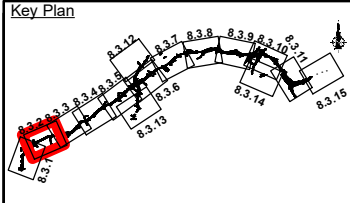

Consultant

Corporate House  
City East Business Park  
Ballybit, Galway, Ireland

Tel +353 (0)91 460675  
www.N6GalwayCity.ie  
www.arup.ie

Job Title  
**N6 Galway City Ring Road**

Scale: **1:5,000**

Date: **September 2018**

I1	28/09/2018	AG	MH	EMC
Issue	Date	By	Chkd	Appd

Drawing Title  
**Mammal Survey Study Area and Results**  
 Sheet 02 of 15  
 Drawing Status

**For Information**

Job No	Drawing No	Issue
<b>233985-00</b>	<b>Figure 8.3.2</b>	<b>11</b>

**EIA REPORT**

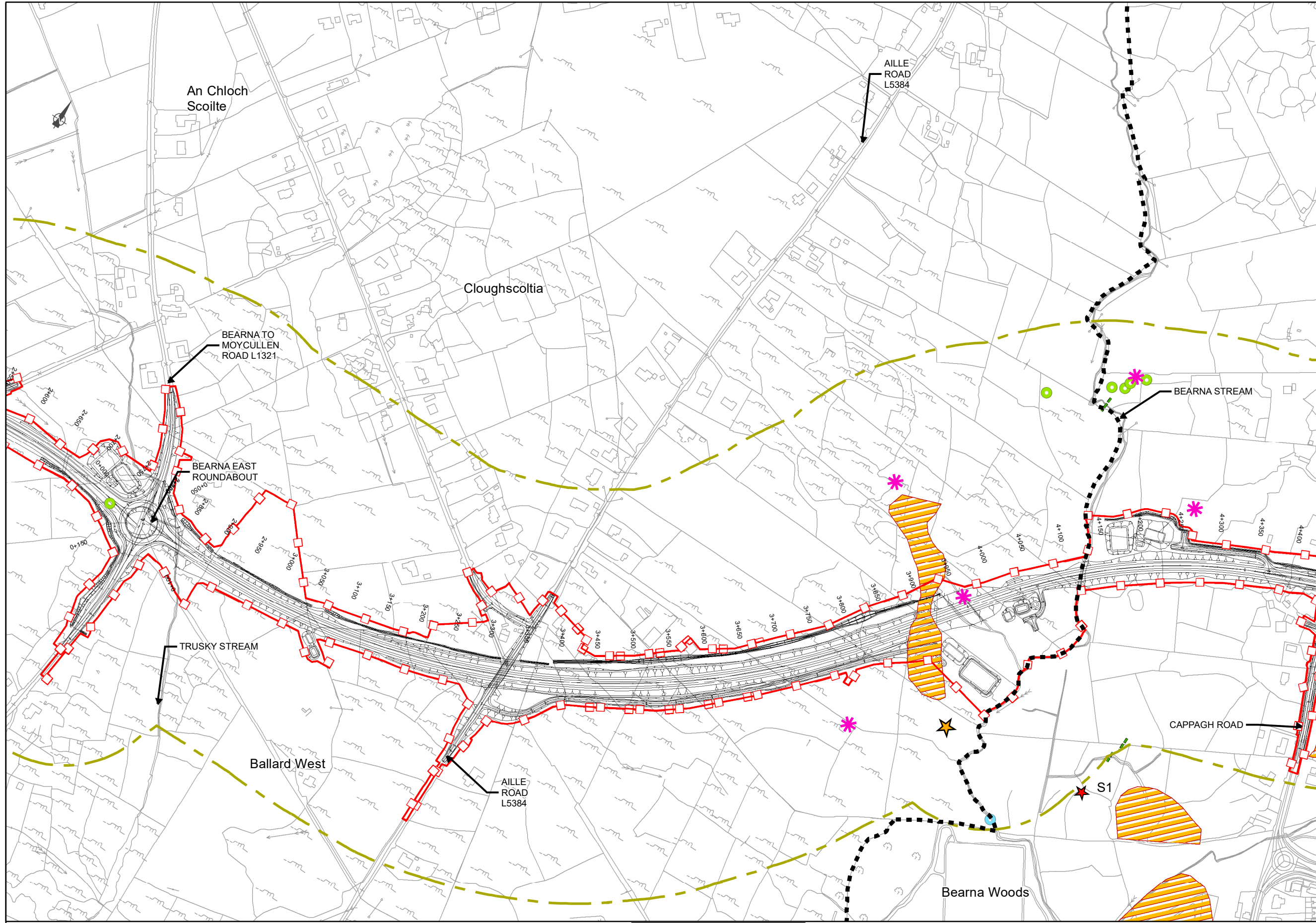

- Legend**
- City Boundary
  - - - Proposed Development Boundary
  - ▬ Proposed Road Development
  - ▭ Mammal Survey Area
  - Otter Signs
  - Badger Signs
  - ★ Inactive Badger sett
  - Badger Trail
  - ✱ Irish Hare
  - ★ Fox earth
  - ▨ Areas of Dense Vegetation- Partially Inaccessible

San áireamh tá sonraíocht Shuirbhíreacht Ordánais Éireann arna atáirgeadh faoi Cheadúnas OSI Uimh. 2010/18CCMA/Comhairle Contae na Gaillimhe. Sáraíonn atáirgeadh neamh-darthe cóipeacht Shuirbhíreacht Ordánais Éireann agus Rialtas na hÉireann. © Suirbhíreacht Ordánais Éireann, 2010.

© Suirbhíreacht Ordánais Éireann. Gach ceart ar chosaint. Uimhr cheadúnais 2010/18CCMA/Comhairle Contae na Gaillimhe.

Includes Ordnance Survey Ireland data reproduced under OSI Licence number 2010/18CCMA/Galway County Council. Unauthorised reproduction infringes Ordnance Survey Ireland and Government of Ireland copyright. © Ordnance Survey Ireland, 2010.

© Ordnance Survey Ireland. All rights reserved. Licence number 2010/18CCMA/Galway County Council.

**Clients**

Comhairle Chontae na Gaillimhe  
Galway County Council

**Galway City Transport Project**

Galway City Transport Project

**Ar Roinn Iompair Turasoireachta agus Spóirt**  
Department Transport, Tourism and Sport

**TII**  
Transport Infrastructure Ireland

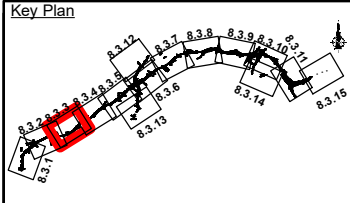

**Consultant**

**ARUP**

Corporate House  
City East Business Park  
Ballybit, Galway, Ireland

Tel +353 (0)91 460675  
www.N6GalwayCity.ie  
www.arup.ie

**Job Title**  
N6 Galway City Ring Road

**Scale:** 1:5,000

**Date:** September 2018

I1	28/09/2018	AG	MH	EMC
Issue	Date	By	Chkd	Appd

**Drawing Title**  
Mammal Survey Study Area and Results  
Sheet 03 of 15  
Drawing Status

**For Information**

Job No	Drawing No	Issue
233985-00	Figure 8.3.3	11

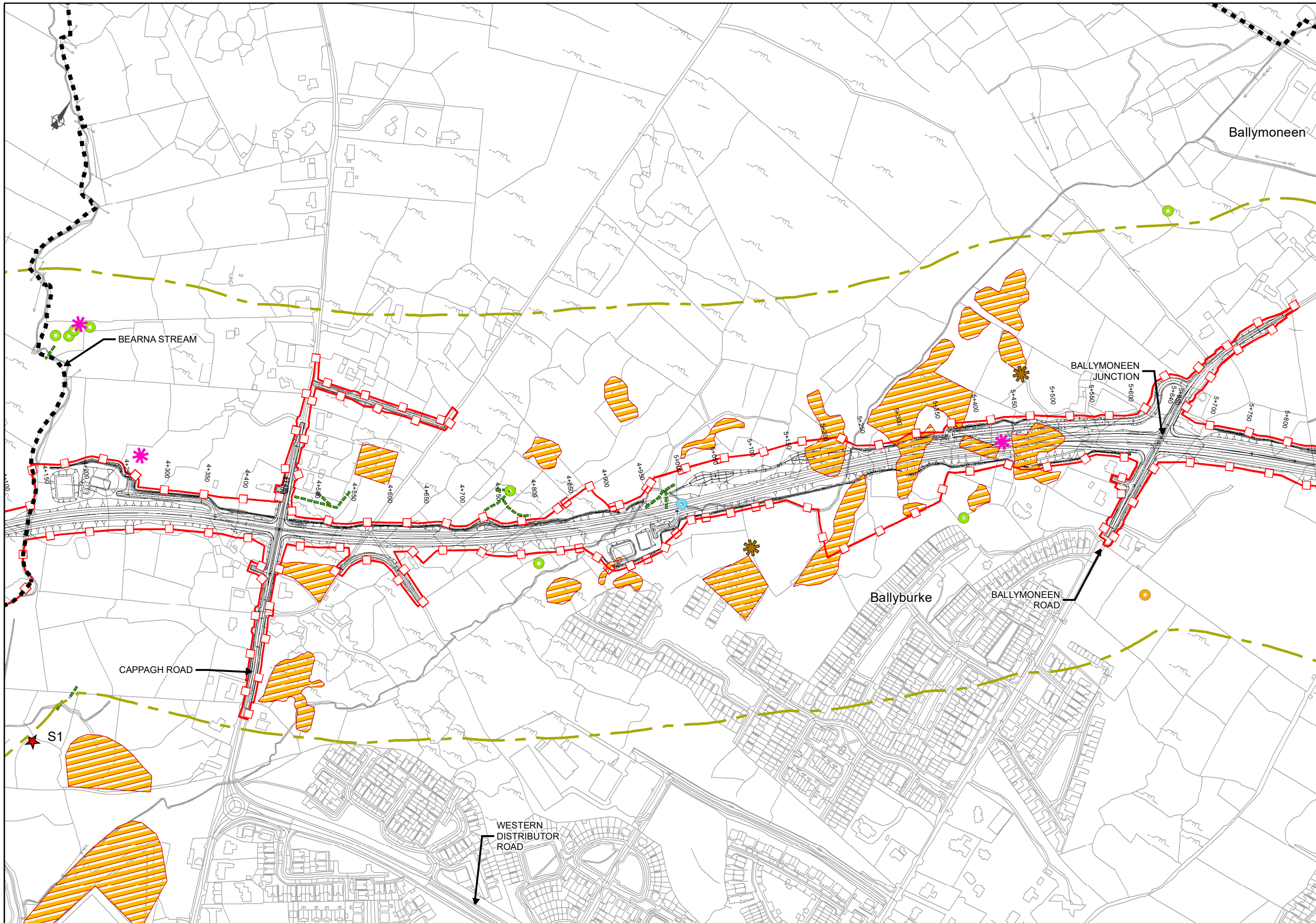

**EIA REPORT**

- Legend**
- City Boundary
  - Proposed Development Boundary
  - Proposed Road Development
  - Mammal Survey Area
  - Otter Signs
  - Badger Signs
  - Inactive Badger sett
  - Badger Trail
  - Irish Hare
  - Fox
  - Fox Signs
  - Areas of Dense Vegetation- Partially Inaccessible

San áireamh tá sonraíocht Shuirbhéireacht Ordánais Éireann arís atáirgeadh faoi Cheadúnas OSI Uimh. 2010/18CCMA/Comhairle Contae na Gaillimhe. Sáraitonn atáirgeadh neamh-daralthe cóipeacht Shuirbhéireacht Ordánais Éireann agus Rialtas na hÉireann. © Suirbhéireacht Ordánais Éireann, 2010.

© Suirbhéireacht Ordánais Éireann. Gach ceart ar chosaint. Uimh. cheadúnais 2010/18CCMA/Comhairle Contae na Gaillimhe.

Includes Ordnance Survey Ireland data reproduced under OSI Licence number 2010/18CCMA/Galway County Council. Unauthorised reproduction infringes Ordnance Survey Ireland and Government of Ireland copyright. © Ordnance Survey Ireland, 2010.

© Ordnance Survey Ireland. All rights reserved. Licence number 2010/18CCMA/Galway County Council.

**Clients**

Comhairle Chontae na Gaillimhe  
Galway County Council

**Galway City Transport Project**

AN ROINN Iompair  
Turasoireachta agus Spóirt  
Department of Transport, Tourism and Sport

**TII**  
Transport Infrastructure Ireland

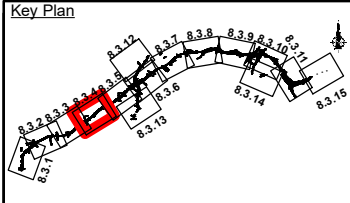

**Consultant**

**ARUP**

Corporate House  
City East Business Park  
Ballybrin, Galway, Ireland

Tel +353 (0)91 460675  
www.N6GalwayCity.ie  
www.arup.ie

**Job Title**  
N6 Galway City Ring Road

**Scale:** 1:5,000

**Date:** September 2018

I1	28/09/2018	AG	MH	EMC
Issue	Date	By	Chkd	Appd

**Drawing Title**  
Mammal Survey Study Area and Results  
Sheet 04 of 15  
Drawing Status

**For Information**

Job No	Drawing No	Issue
233985-00	Figure 8.3.4	I1

**EIA REPORT**

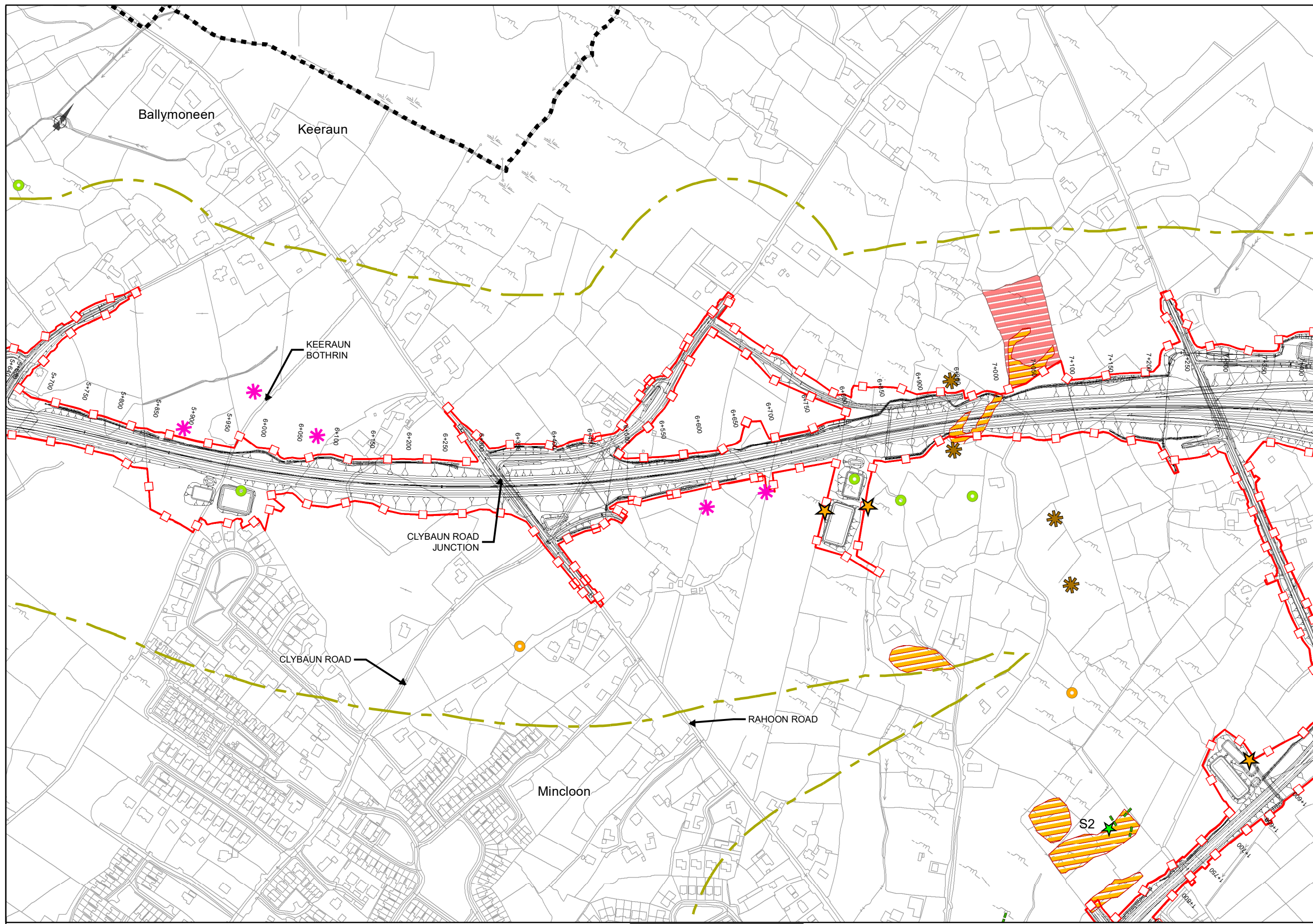

- Legend**
- ■ ■ City Boundary
  - Proposed Development Boundary
  - ▬ Proposed Road Development
  - ▭ Mammal Survey Area
  - Badger Signs
  - ★ Active Badger sett
  - Badger Trail
  - ✱ Irish Hare
  - ✱ Fox
  - Fox Signs
  - ★ Fox earth
  - ▨ Areas of Dense Vegetation- Partially Inaccessible
  - ▨ Access Denied for the Purpose of Mammal Surveys

San áireamh tá sonraíocht Shuirbhíreacht Ordánais Éireann arís atáirgeadh faoi Cheadúnas OSI Uimh. 2010/18CCMA/Comhairle Contae na Gaillimhe. Sáraíonn atáirgeadh neamh-daralthe cóipeacht Shuirbhíreacht Ordánais Éireann agus Rialtas na hÉireann. © Suirbhíreacht Ordánais Éireann, 2010.

© Suirbhíreacht Ordánais Éireann. Gach ceart ar chosaint. Uimhir cheadúnais 2010/18CCMA/Comhairle Contae na Gaillimhe.

Includes Ordnance Survey Ireland data reproduced under OSI Licence number 2010/18CCMA/Galway County Council. Unauthorised reproduction infringes Ordnance Survey Ireland and Government of Ireland copyright. © Ordnance Survey Ireland, 2010.

© Ordnance Survey Ireland. All rights reserved. Licence number 2010/18CCMA/Galway County Council.

Clients

Comhairle Chontae na Gaillimhe  
Galway County Council

AN6  
Galway City Transport Project

GA  
An Roinn Iompair  
Turasoireachta agus Spóirt  
Department of Transport, Tourism and Sport

TII  
Transport Infrastructure Ireland

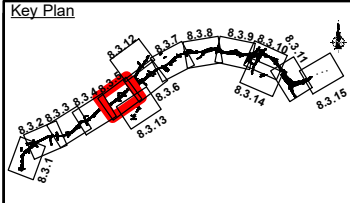

Consultant

**ARUP**

Corporate House  
City East Business Park  
Ballybrin, Galway, Ireland

Tel +353 (0)91 460675  
www.N6GalwayCity.ie  
www.arup.ie

Job Title  
**N6 Galway City Ring Road**

Scale: **1:5,000**

Date: **September 2018**

I1	28/09/2018	AG	MH	EMC
Issue	Date	By	Chkd	Appd

Drawing Title  
**Mammal Survey Study Area and Results**

Sheet 05 of 15

Drawing Status

**For Information**

Job No	Drawing No	Issue
<b>233985-00</b>	<b>Figure 8.3.5</b>	<b>11</b>

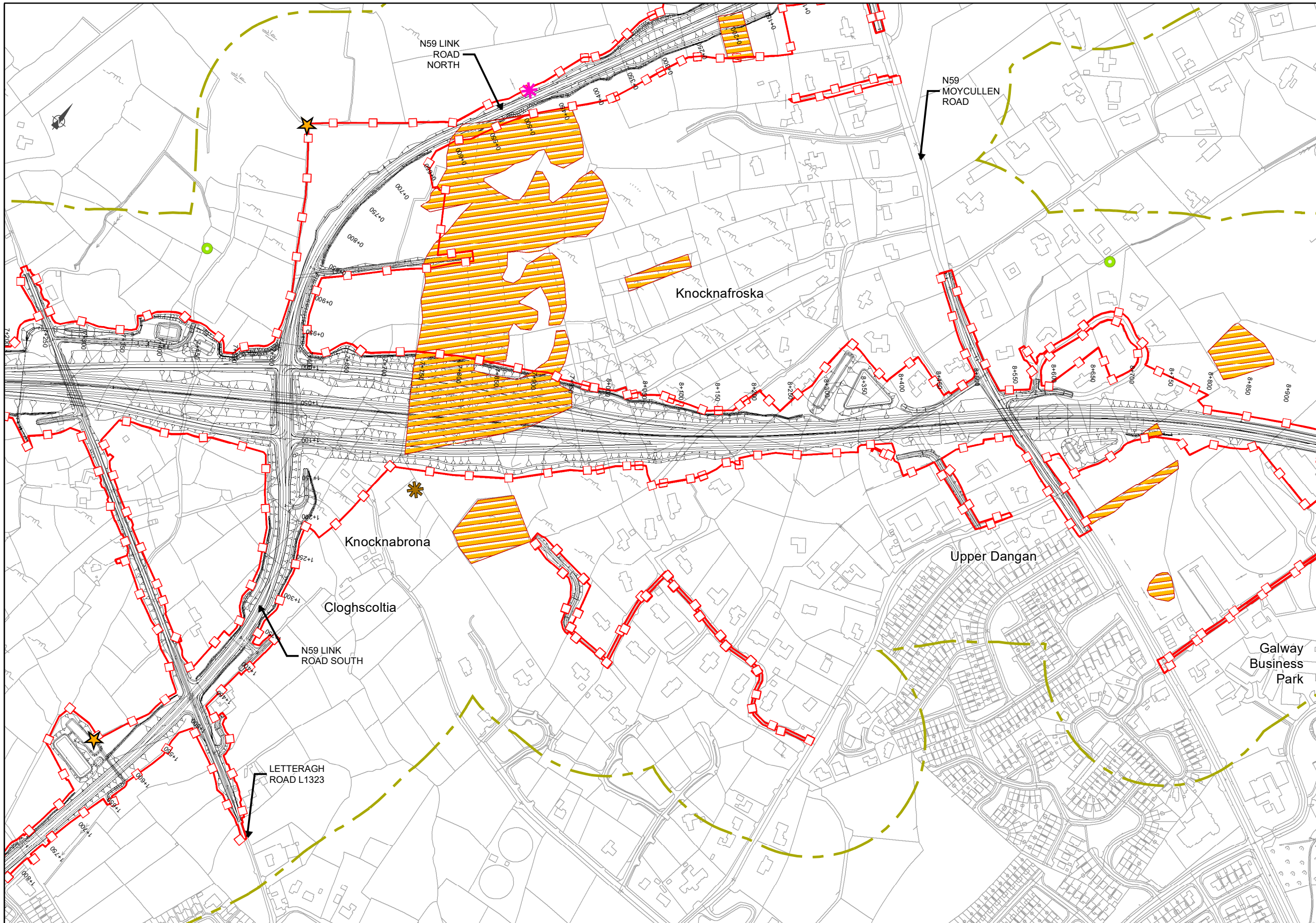

**EIA REPORT**

- Legend**
- ■ ■ ■ City Boundary
  - Proposed Development Boundary
  - ▨ Proposed Road Development
  - ▭ Mammal Survey Area
  - Badger Signs
  - ✱ Irish Hare
  - ✱ Fox
  - ★ Fox earth
  - ▨ Areas of Dense Vegetation- Partially Inaccessible

San áireamh tá sonraíocht Shuirbhéireacht Ordánais Éireann arna atáirgeadh faoi Cheadúnas OSI Uimh. 2010/18CCMA/Comhairle Contae na Gaillimhe. Sáraíonn atáirgeadh neamh-daralthe cóipeacht Shuirbhéireacht Ordánais Éireann agus Rialtas na hÉireann. © Suirbhéireacht Ordánais Éireann, 2010.  
 © Suirbhéireacht Ordánais Éireann. Gach ceart ar chosaint.  
 Uimh. cheadúnais 2010/18CCMA/Comhairle Contae na Gaillimhe.  
 Includes Ordnance Survey Ireland data reproduced under OSI Licence number 2010/18CCMA/Galway County Council.  
 Unauthorised reproduction infringes Ordnance Survey Ireland and Government of Ireland copyright. © Ordnance Survey Ireland, 2010.  
 © Ordnance Survey Ireland. All rights reserved. Licence number 2010/18CCMA/Galway County Council.

**Clients**

Comhairle Chontae na Gaillimhe  
Galway County Council

AN6  
Galway City Transport Project

GA  
An Roinn Iompair  
Turasoireachta agus Spóirt  
Department of Transport, Tourism and Sport

TII  
Transport Infrastructure Ireland

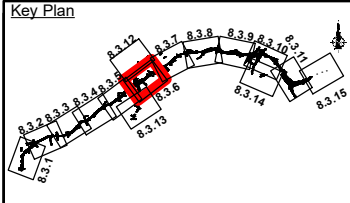

**Consultant**

**ARUP**

Corporate House  
City East Business Park  
Ballybirt, Galway, Ireland

Tel +353 (0)91 460675  
www.N6GalwayCity.ie  
www.arup.ie

**Job Title**  
N6 Galway City Ring Road

**Scale:** 1:5,000

**Date:** September 2018

I1	28/09/2018	AG	MH	EMC
Issue	Date	By	Chkd	Appd

**Drawing Title**  
Mammal Survey Study Area and Results  
Sheet 06 of 15  
Drawing Status

**For Information**

Job No	Drawing No	Issue
233985-00	Figure 8.3.6	11

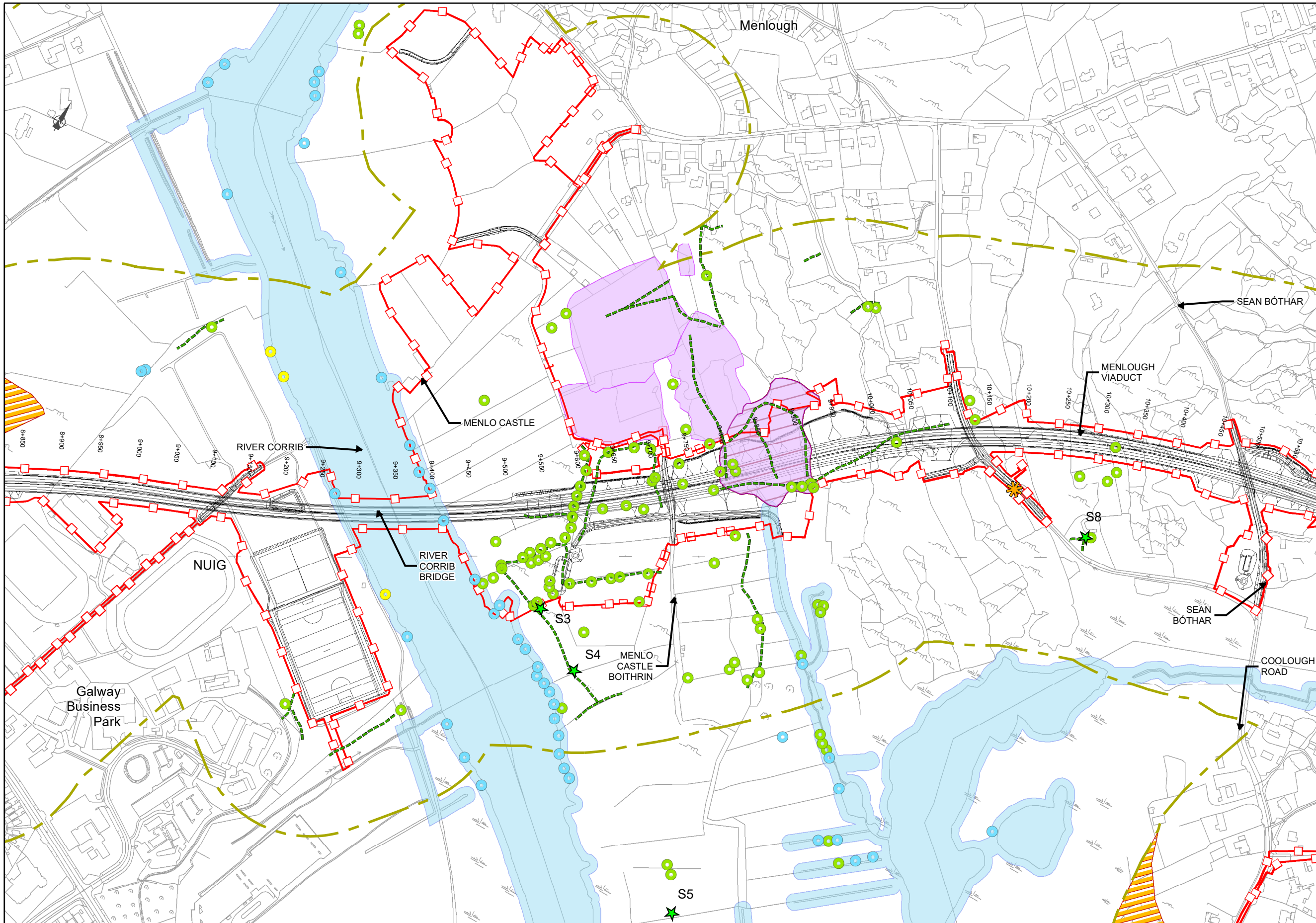

**EIA REPORT**

- Legend**
- ■ ■ ■ City Boundary
  - Proposed Development Boundary
  - ▬ Proposed Road Development
  - ▭ Mammal Survey Area
  - 2014 River Corrib Otter Survey Area
  - Otter Signs
  - Badger Signs
  - ★ Active Badger sett
  - Badger Trail
  - ✱ Irish Stoat
  - Squirrel Signs
  - ▨ Wood Mouse Signs
  - Mink Signs
  - ▨ Areas of Dense Vegetation- Partially Inaccessible

San áireamh tá sonraíocht Shuirbhíreacht Ordánais Éireann arís atáirgeadh faoi Cheadúnas OSI Uimh. 2010/18CCMA/Comhairle Contae na Gaillimhe. Sáraíonn atáirgeadh neamhdarálthe cóipeacht Shuirbhíreacht Ordánais Éireann agus Rialtas na hÉireann. © Suirbhíreacht Ordánais Éireann, 2010.

© Suirbhíreacht Ordánais Éireann. Gach ceart ar chosaint. Uimhí cheadúnais 2010/18CCMA/Comhairle Contae na Gaillimhe.

Includes Ordnance Survey Ireland data reproduced under OSI Licence number 2010/18CCMA/Galway County Council. Unauthorised reproduction infringes Ordnance Survey Ireland and Government of Ireland copyright. © Ordnance Survey Ireland, 2010.

© Ordnance Survey Ireland. All rights reserved. Licence number 2010/18CCMA/Galway County Council.

**Clients**

Comhairle Chontae na Gaillimhe  
Galway County Council

AN6  
Galway City Transport Project

GA  
An Roinn Iompair  
Turasoireachta agus Spóirt  
Department of Transport, Tourism and Sport

TII  
Transport Infrastructure Ireland

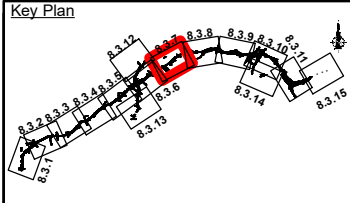

**Consultant**

**ARUP**

Corporate House  
City East Business Park  
Ballybirt, Galway, Ireland

Tel +353 (0)91 460675  
www.N6GalwayCity.ie  
www.arup.ie

**Job Title**  
N6 Galway City Ring Road

**Scale:** 1:5,000

**Date:** September 2018

I1	28/09/2018	AG	MH	EMC
Issue	Date	By	Chkd	Appd

**Drawing Title**  
Mammal Survey Study Area and Results  
Sheet 07 of 15  
Drawing Status

**For Information**

Job No	Drawing No	Issue
233985-00	Figure 8.3.7	11

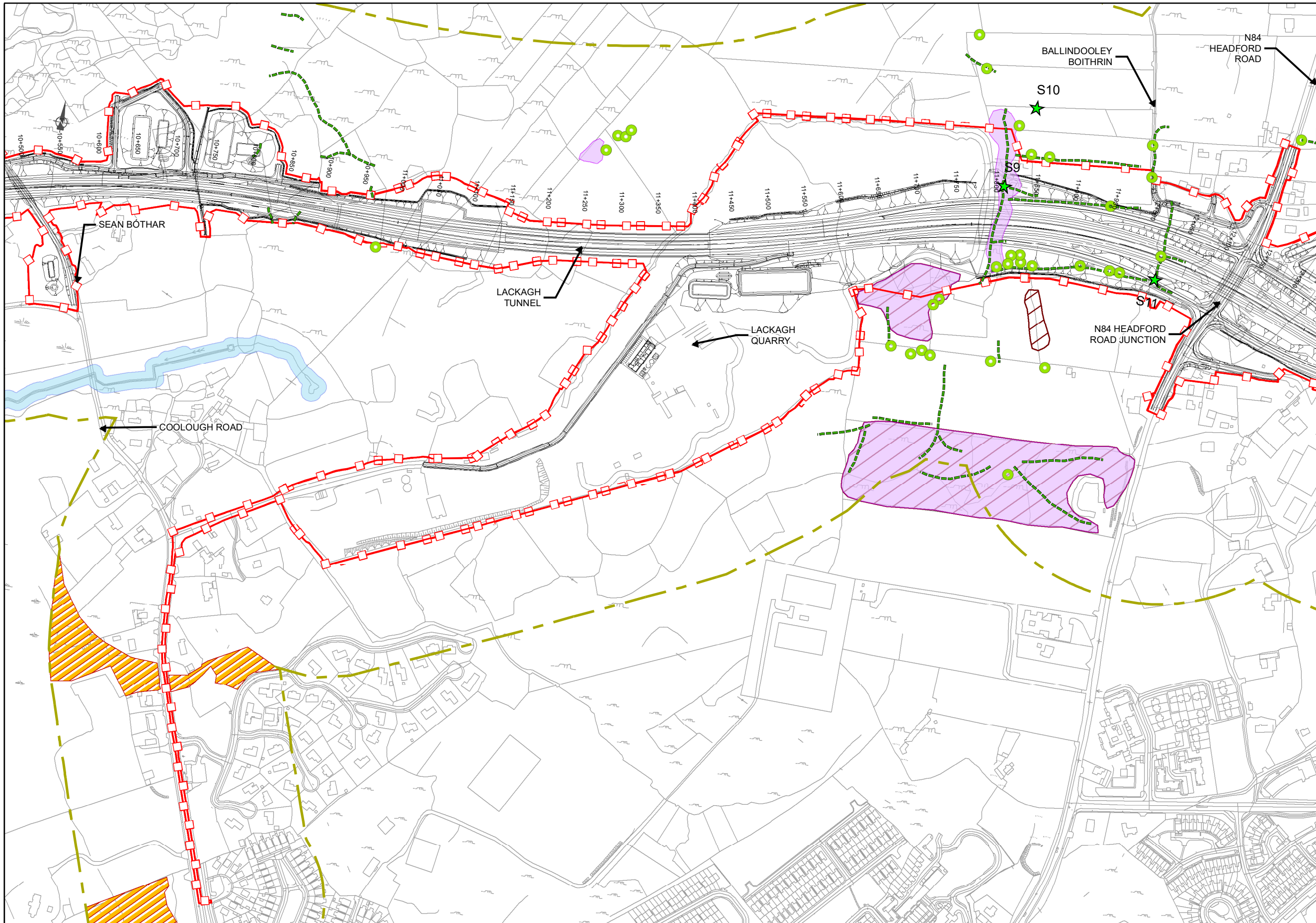

**EIA REPORT**

- Legend**
- ■ ■ City Boundary
  - Proposed Development Boundary
  - ▬ Proposed Road Development
  - ▭ Mammal Survey Area
  - 2014 River Corrib Otter Survey Area
  - Badger Signs
  - ★ Active Badger sett
  - Badger Trail
  - Squirrel Signs
  - ▨ Wood Mouse Signs
  - ▨ Areas of Dense Vegetation- Partially Inaccessible

San áireamh tá sonraíocht Shuirbhíreacht Ordánais Éireann arís atáirgeadh faoi Cheadúnas OSI Uimh. 2010/18CCMA/Comhairle Contae na Gaillimhe. Sáraíonn atáirgeadh neamhdarálthe cóipeacht Shuirbhíreacht Ordánais Éireann agus Rialtas na hÉireann. © Suirbhíreacht Ordánais Éireann, 2010.

© Suirbhíreacht Ordánais Éireann. Gach ceart ar chosaint. Uimh. cheadúnais 2010/18CCMA/Comhairle Contae na Gaillimhe.

Includes Ordnance Survey Ireland data reproduced under OSI Licence number 2010/18CCMA/Galway County Council. Unauthorised reproduction infringes Ordnance Survey Ireland and Government of Ireland copyright. © Ordnance Survey Ireland, 2010.

© Ordnance Survey Ireland. All rights reserved. Licence number 2010/18CCMA/Galway County Council.

**Clients**

Comhairle Chontae na Gaillimhe  
Galway County Council

AN6  
Galway City Transport Project

GA  
An Roinn Iompair  
Turasoireachta agus Spóirt  
Department of Transport, Tourism and Sport

TII  
Transport Infrastructure Ireland

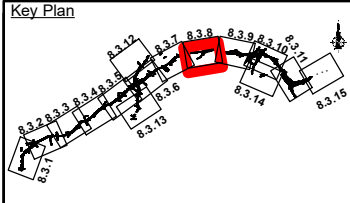

**Consultant**

**ARUP**

Corporate House  
City East Business Park  
Ballybirt, Galway, Ireland

Tel +353 (0)91 460675  
www.N6GalwayCity.ie  
www.arup.ie

**Job Title**  
N6 Galway City Ring Road

**Scale:** 1:5,000

**Date:** September 2018

I1	28/09/2018	AG	MH	EMC
Issue	Date	By	Chkd	Appd

**Drawing Title**  
Mammal Survey Study Area and Results  
Sheet 08 of 15  
Drawing Status

**For Information**

Job No	Drawing No	Issue
233985-00	Figure 8.3.8	11



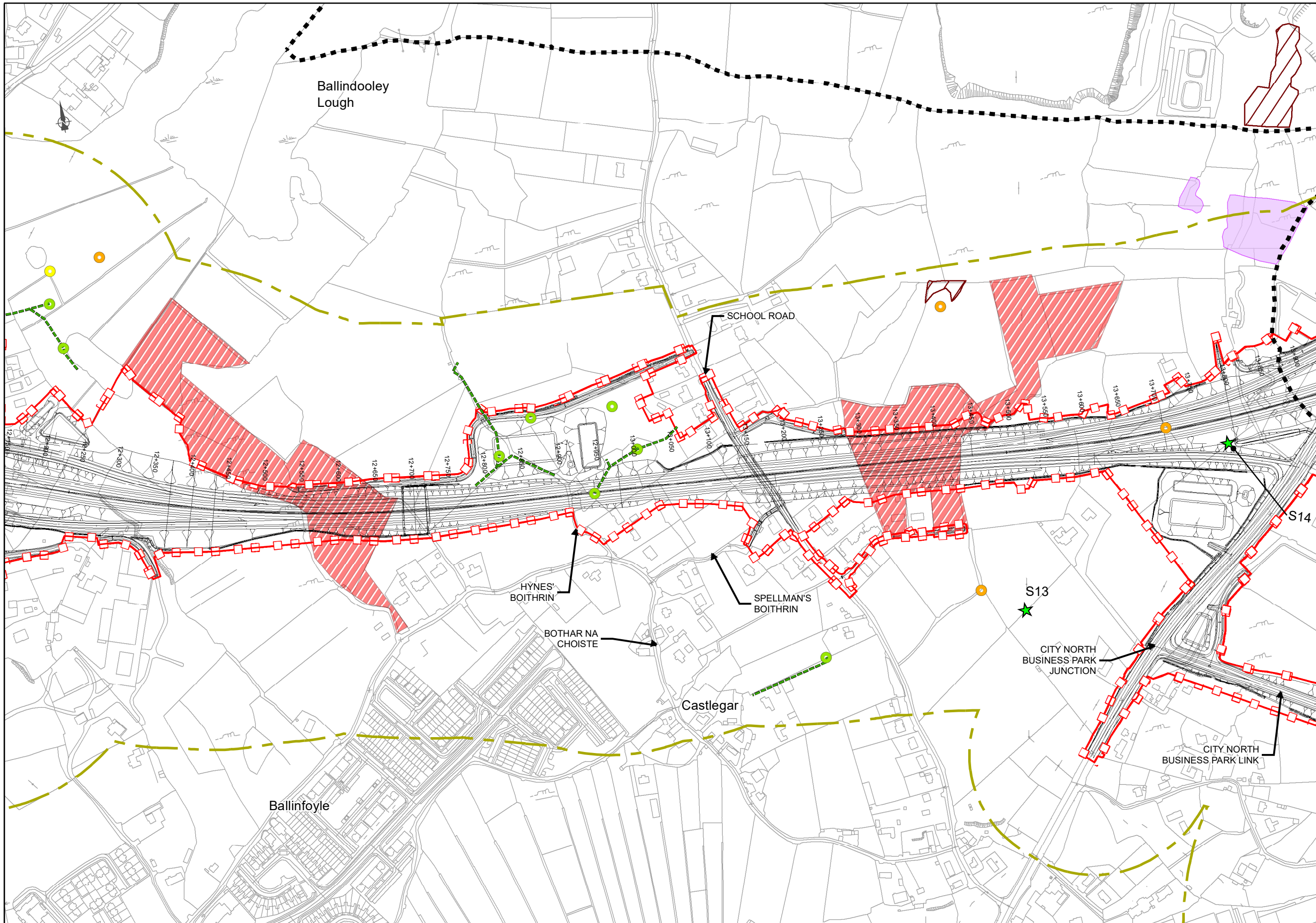

**EIA REPORT**

- Legend**
- City Boundary
  - - - Proposed Development Boundary
  - ▨ Proposed Road Development
  - ▭ Mammal Survey Area
  - Badger Signs
  - ★ Active Badger sett
  - Badger Trail
  - ▭ Squirrel Signs
  - ▨ Wood Mouse Signs
  - Fox Signs
  - Mink Signs
  - ▨ Access Denied for the Purpose of Mammal Surveys

San áireamh tá sonraíocht Shuirbhéireacht Ordánais Éireann arís atáirgeadh faoi Cheadúnas OSI Uimh. 2010/18CCMA/Comhairle Contae na Gaillimhe. Sáraíonn atáirgeadh neamhdarálthe cóipeacht Shuirbhéireacht Ordánais Éireann agus Rialtas na hÉireann. © Suirbhéireacht Ordánais Éireann, 2010.

© Suirbhéireacht Ordánais Éireann. Gach ceart ar chosaint. Uimhreachúnas 2010/18CCMA/Comhairle Contae na Gaillimhe.

Includes Ordnance Survey Ireland data reproduced under OSI Licence number 2010/18CCMA/Galway County Council. Unauthorised reproduction infringes Ordnance Survey Ireland and Government of Ireland copyright. © Ordnance Survey Ireland, 2010.

© Ordnance Survey Ireland. All rights reserved. Licence number 2010/18CCMA/Galway County Council.

**Clients**

Comhairle Chontae na Gaillimhe  
Galway County Council

AN6  
Galway City Transport Project

GA  
An Roinn Iompair  
Turasoireachta agus Spóirt  
Department of Transport, Tourism and Sport

TII  
Transport Infrastructure Ireland

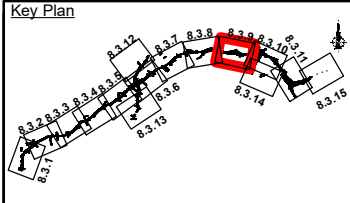

**Consultant**

**ARUP**

Corporate House  
City East Business Park  
Ballybit, Galway, Ireland

Tel +353 (0)91 460675  
www.N6GalwayCity.ie  
www.arup.ie

**Job Title**  
N6 Galway City Ring Road

**Scale:** 1:5,000

**Date:** September 2018

I1	28/09/2018	AG	MH	EMC
Issue	Date	By	Chkd	Appd

**Drawing Title**  
Mammal Survey Study Area and Results  
Sheet 09 of 15  
Drawing Status

**For Information**

Job No	Drawing No	Issue
233985-00	Figure 8.3.9	11

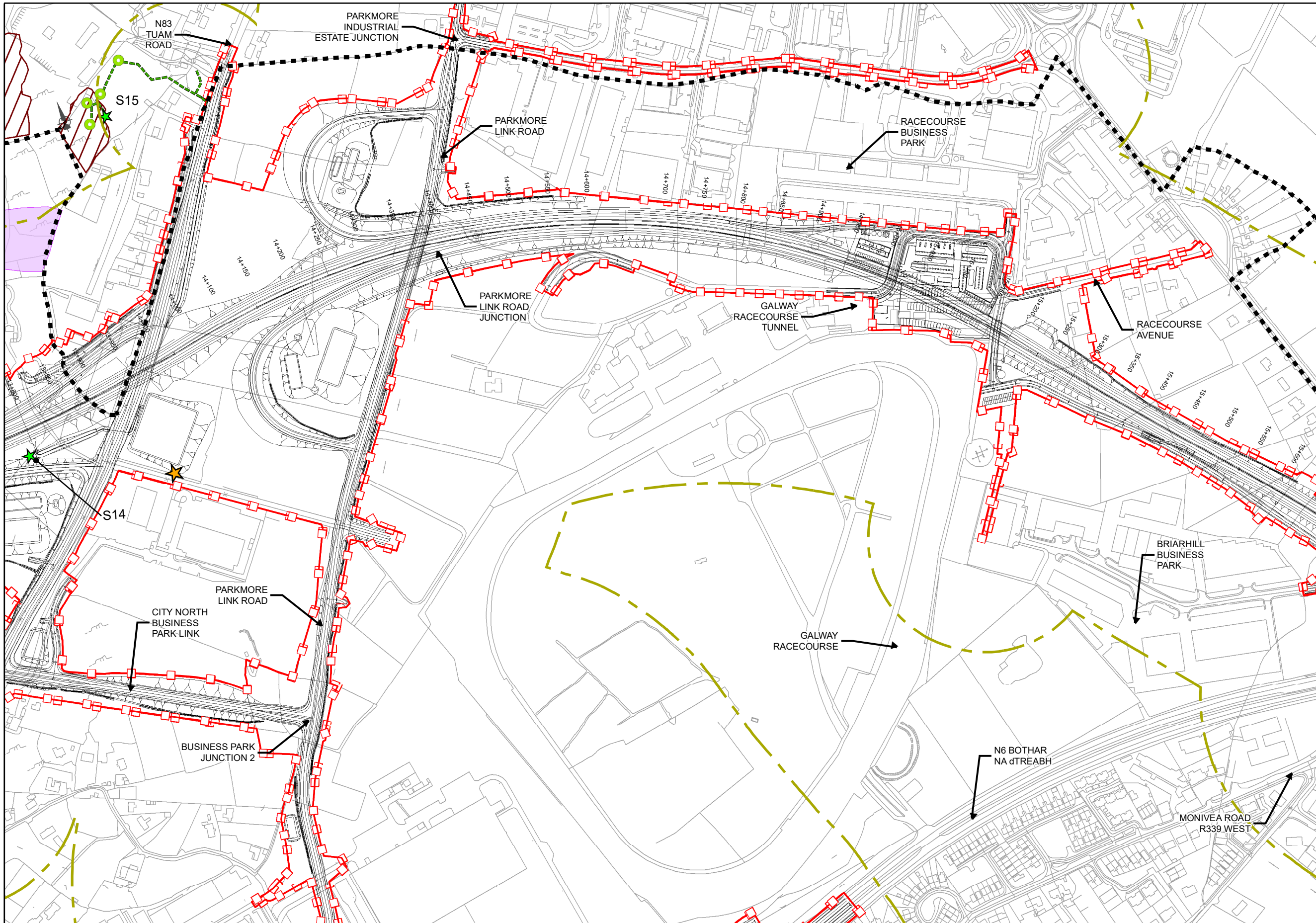

**EIA REPORT**

- Legend**
- City Boundary
  - - - Proposed Development Boundary
  - ▨ Proposed Road Development
  - ▭ Mammal Survey Area
  - Badger Signs
  - ★ Active Badger sett
  - Badger Trail
  - ▭ Squirrel Signs
  - ▨ Wood Mouse Signs
  - ★ Fox earth

San áireamh tá sonraíocht Shuirbhíreacht Ordánais Éireann arís atáirgeadh faoi Cheadúnas OSI Uimh. 2010/18CCMA/Comhairle Contae na Gaillimhe. Sáraíonn atáirgeadh neamh-darálthe cóipeacht Shuirbhíreacht Ordánais Éireann agus Rialtas na hÉireann. © Suirbhíreacht Ordánais Éireann, 2010.  
 © Suirbhíreacht Ordánais Éireann. Gach ceart ar chosaint.  
 Uimhír cheadúnais 2010/18CCMA/Comhairle Contae na Gaillimhe.  
 Includes Ordnance Survey Ireland data reproduced under OSI Licence number 2010/18CCMA/Galway County Council.  
 Unauthorised reproduction infringes Ordnance Survey Ireland and Government of Ireland copyright. © Ordnance Survey Ireland, 2010.  
 © Ordnance Survey Ireland. All rights reserved. Licence number 2010/18CCMA/Galway County Council.

**Clients**

Comhairle Chontae na Gaillimhe  
Galway County Council

**Galway City Transport Project**

**ARUP**

Corporate House  
City East Business Park  
Ballybrit, Galway, Ireland

Tel +353 (0)91 460675  
www.N6GalwayCity.ie  
www.arup.ie

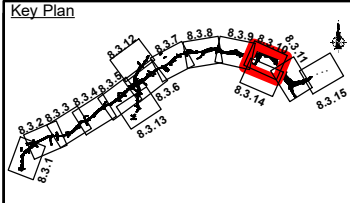

**Consultant**

**ARUP**

Corporate House  
City East Business Park  
Ballybrit, Galway, Ireland

Tel +353 (0)91 460675  
www.N6GalwayCity.ie  
www.arup.ie

**Job Title**  
N6 Galway City Ring Road

**Scale:** 1:5,000

**Date:** September 2018

I1	28/09/2018	AG	MH	EMC
Issue	Date	By	Chkd	Appd

**Drawing Title**  
Mammal Survey Study Area and Results  
Sheet 10 of 15  
Drawing Status

**For Information**

Job No	Drawing No	Issue
233985-00	Figure 8.3.10	11

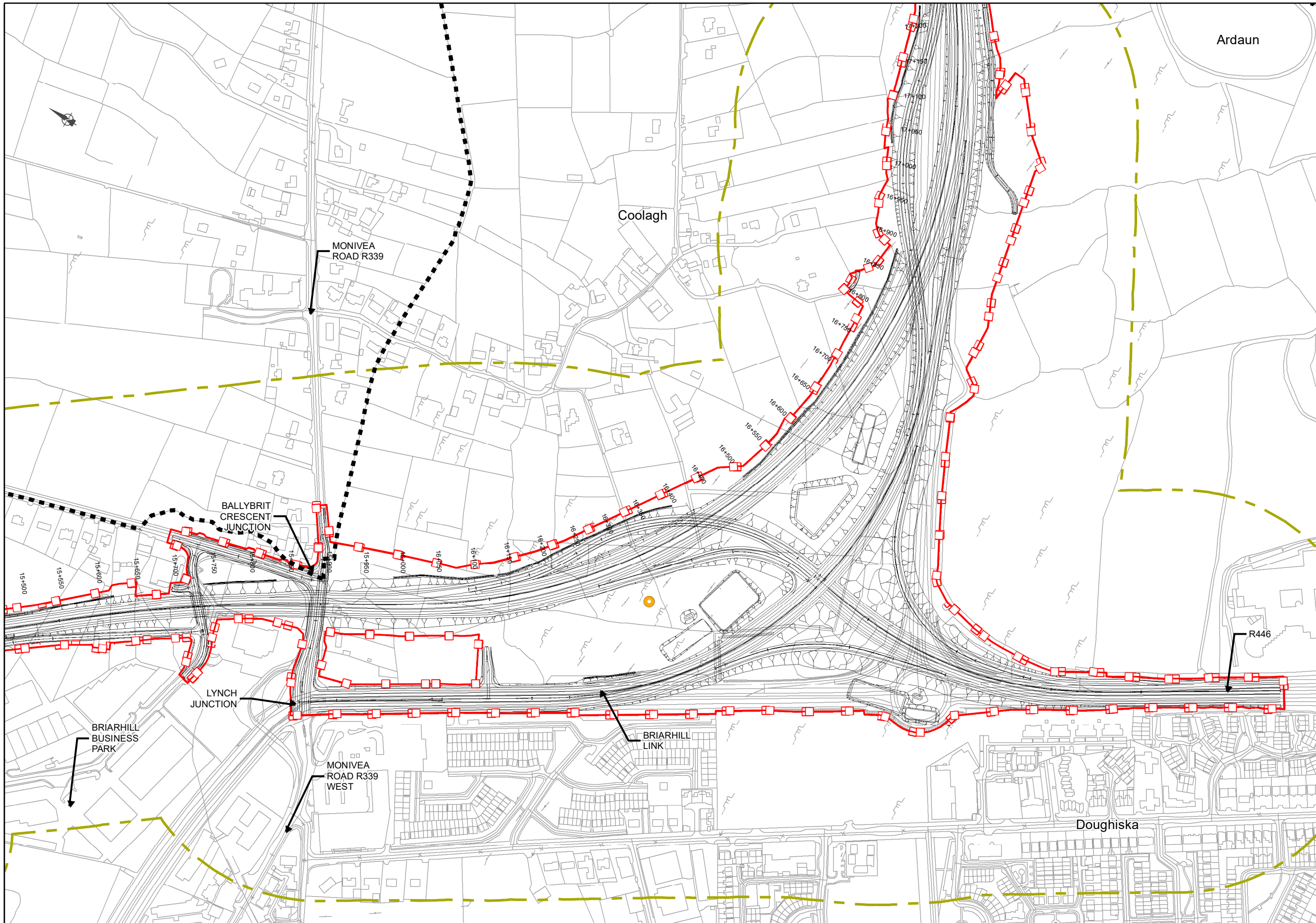

**EIA REPORT**

- Legend**
- City Boundary
  - Proposed Development Boundary
  - Proposed Road Development
  - Mammal Survey Area
  - Fox Signs

San áireamh tá sonraíocht Shuirbhíreacht Ordánais Éireann arna atáirgeadh faoi Cheadúnas OSI Uimh. 2010/18CCMA/Comhairle Contae na Gaillimhe. Sáraíonn atáirgeadh neamh-daralthe cóipeacht Shuirbhíreacht Ordánais Éireann agus Rialtas na hÉireann. © Suirbhíreacht Ordánais Éireann, 2010.

© Suirbhíreacht Ordánais Éireann. Gach ceart ar chosaint. Uimhír cheadúnais 2010/18CCMA/Comhairle Contae na Gaillimhe.

Includes Ordnance Survey Ireland data reproduced under OSI Licence number 2010/18CCMA/Galway County Council. Unauthorised reproduction infringes Ordnance Survey Ireland and Government of Ireland copyright. © Ordnance Survey Ireland, 2010.

© Ordnance Survey Ireland. All rights reserved. Licence number 2010/18CCMA/Galway County Council.

Clients

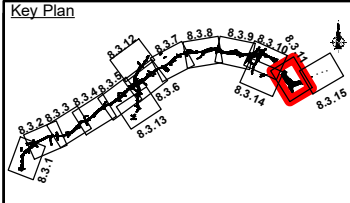

Consultant

Corporate House  
City East Business Park  
Ballybrit, Galway, Ireland

Tel +353 (0)91 460675  
www.N6GalwayCity.ie  
www.arup.ie

Job Title  
**N6 Galway City Ring Road**

Scale: **1:5,000**

Date: **September 2018**

I1	28/09/2018	AG	MH	EMC
Issue	Date	By	Chkd	Appd

Drawing Title  
**Mammal Survey Study Area and Results**

Sheet 11 of 15

Drawing Status

**For Information**

Job No	Drawing No	Issue
<b>233985-00</b>	<b>Figure 8.3.11</b>	<b>11</b>

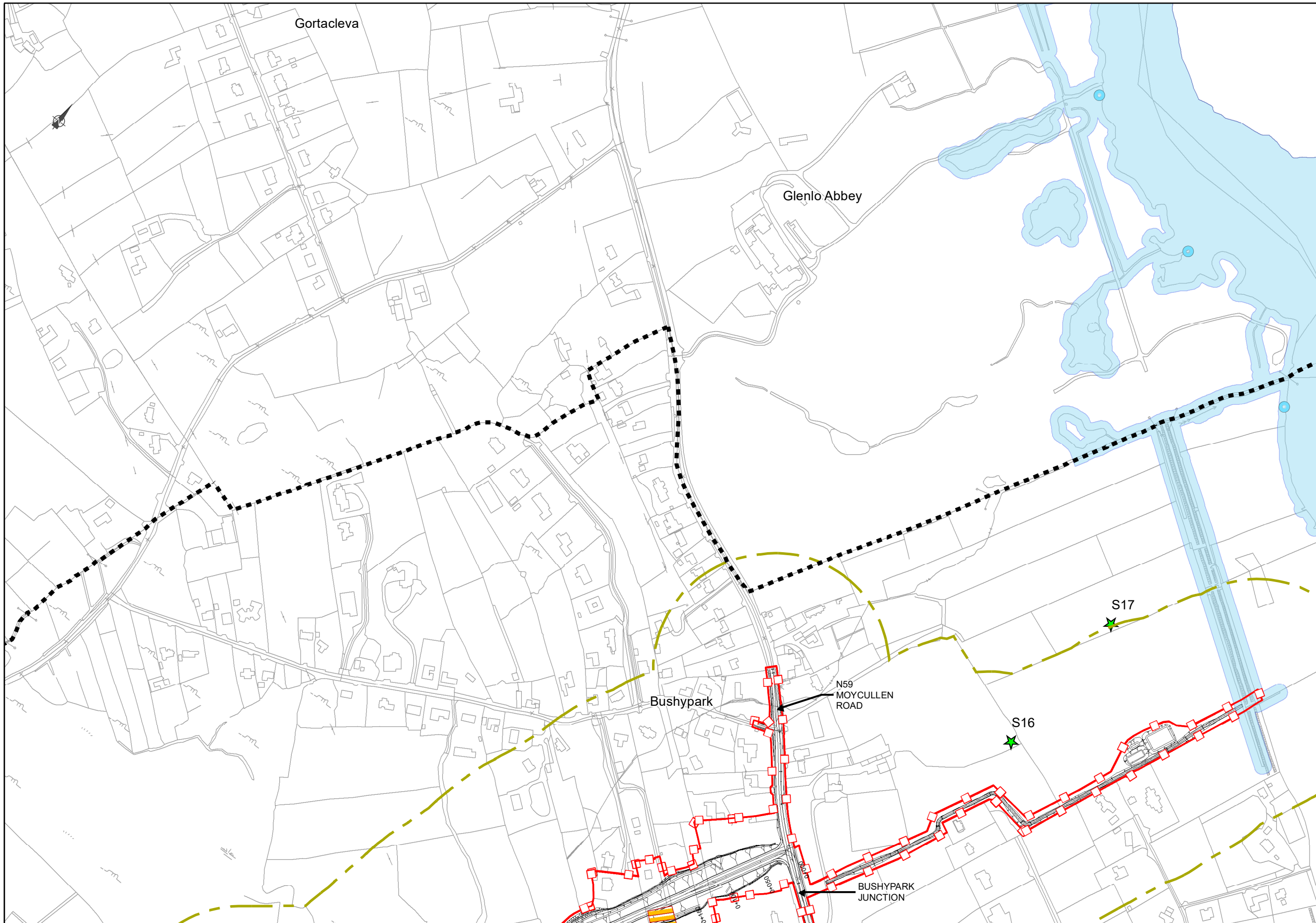

**EIA REPORT**

- Legend**
- ■ ■ ■ City Boundary
  - Proposed Development Boundary
  - ▬ Proposed Road Development
  - ▭ Mammal Survey Area
  - 2014 River Corrib Otter Survey Area
  - Otter Signs
  - ★ Active Bager sett
  - ▨ Areas of Dense Vegetation- Partially Inaccessible

San áireamh tá sonraíocht Shuirbhéireacht Ordánais Éireann arís atáirgeadh faoi Cheadúnas OSI Uimh. 2010/18CCMA/Comhairle Contae na Gaillimhe. Sáraíonn atáirgeadh neamh-daralthe cóipeacht Shuirbhéireacht Ordánais Éireann agus Rialtas na hÉireann. © Suirbhéireacht Ordánais Éireann, 2010.

© Suirbhéireacht Ordánais Éireann. Gach ceart ar chosaint. Uimhír cheadúnais 2010/18CCMA/Comhairle Contae na Gaillimhe.

Includes Ordnance Survey Ireland data reproduced under OSI Licence number 2010/18CCMA/Galway County Council. Unauthorised reproduction infringes Ordnance Survey Ireland and Government of Ireland copyright. © Ordnance Survey Ireland, 2010.

© Ordnance Survey Ireland. All rights reserved. Licence number 2010/18CCMA/Galway County Council.

Clients

Comhairle Chontae na Gaillimhe  
Galway County Council

AN6  
Galway City  
Transport Project

GA  
An Roinn Iompair  
Turasoireachta agus Spóirt  
Department of Transport, Tourism and Sport

TIIV  
Transport Infrastructure  
Investment Vehicle

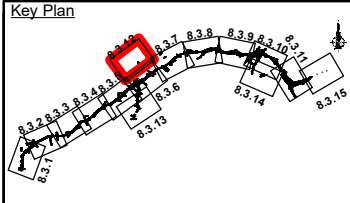

Consultant

**ARUP**

Corporate House  
City East Business Park  
Ballybrit, Galway, Ireland

Tel +353 (0)91 460675  
www.N6GalwayCity.ie  
www.arup.ie

Job Title  
**N6 Galway City Ring Road**

Scale: **1:5,000**

Date: **September 2018**

I1	28/09/2018	AG	MH	EMC
Issue	Date	By	Chkd	Appd

Drawing Title  
**Mammal Survey Study Area and Results**

Sheet 12 of 15

Drawing Status

**For Information**

Job No	Drawing No	Issue
<b>233985-00</b>	<b>Figure 8.3.12</b>	<b>11</b>

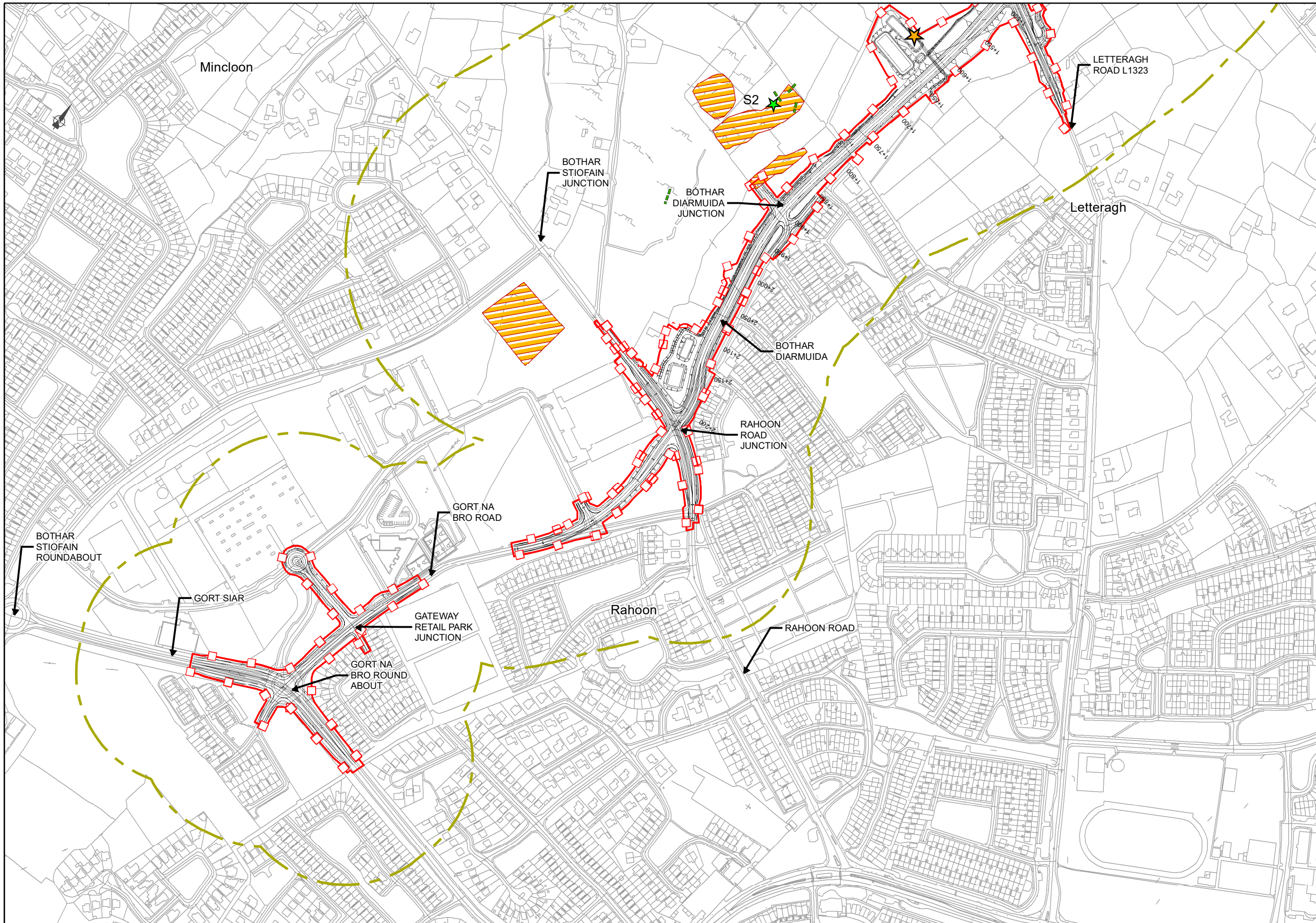

**EIA REPORT**

- Legend**
- ■ ■ ■ City Boundary
  - Proposed Development Boundary
  - ▬ Proposed Road Development
  - ▭ Mammal Survey Area
  - ★ Active Bager sett
  - Badger Trail
  - ★ Fox earth
  - ▨ Areas of Dense Vegetation- Partially Inaccessible

San áireamh tá sonraíocht Shuirbhíreacht Ordánais Éireann arna atáirgeadh faoi Cheadúnas OSI Uimh. 2010/18CCMA/Comhairle Contae na Gaillimhe. Sáráiríonn atáirgeadh neamh-daralthe cóipeacht Shuirbhíreacht Ordánais Éireann agus Rialtas na hÉireann. © Suirbhíreacht Ordánais Éireann, 2010.

© Suirbhíreacht Ordánais Éireann. Gach ceart ar chosaint. Uimh. cheadúnais 2010/18CCMA/Comhairle Contae na Gaillimhe.

Includes Ordnance Survey Ireland data reproduced under OSI Licence number 2010/18CCMA/Galway County Council. Unauthorised reproduction infringes Ordnance Survey Ireland and Government of Ireland copyright. © Ordnance Survey Ireland, 2010.

© Ordnance Survey Ireland. All rights reserved. Licence number 2010/18CCMA/Galway County Council.

**Clients**

Comhairle Chontae na Gaillimhe  
Galway County Council

Galway City Transport Project

Galway City Council

Galway City Transport Project

Galway City Council

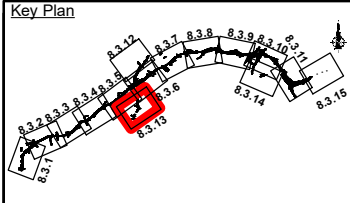

**Consultant**

**ARUP**

Corporate House  
City East Business Park  
Ballybrin, Galway, Ireland

Tel +353 (0)91 460675  
www.N6GalwayCity.ie  
www.arup.ie

**Job Title**

**N6 Galway City Ring Road**

**Scale: 1:5,000**

**Date: September 2018**

I1	28/09/2018	AG	MH	EMC
Issue	Date	By	Chkd	Appd

**Drawing Title**

Mammal Survey Study Area and Results

Sheet 13 of 15

Drawing Status

**For Information**

Job No	Drawing No	Issue
233985-00	Figure 8.3.13	I1

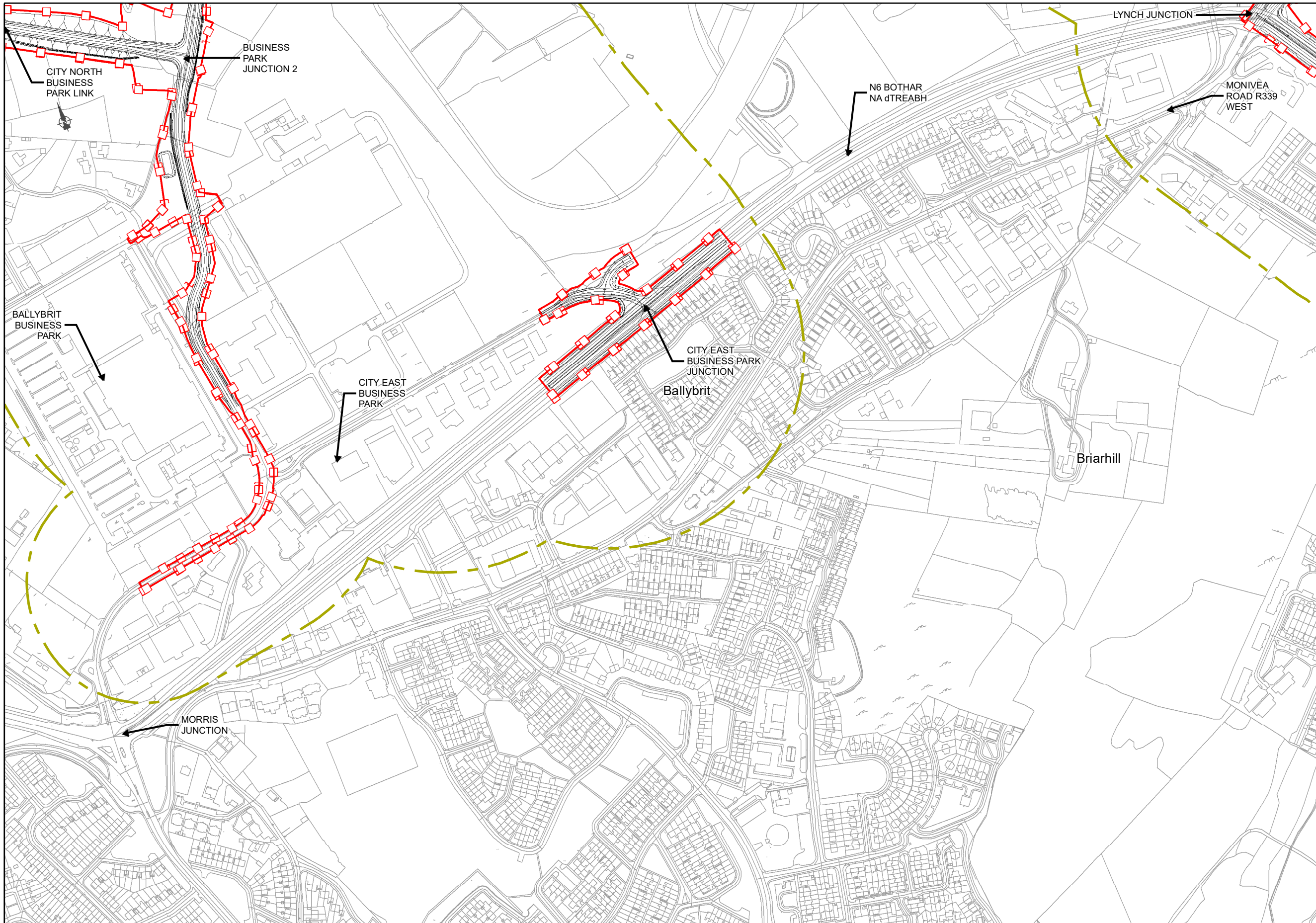

**EIA REPORT**

- Legend**
- ■ ■ ■ City Boundary
  - ▭ Proposed Development Boundary
  - ▨ Proposed Road Development
  - ▭ Mammal Survey Area

San áireamh tá sonraíocht Shuirbhéireacht Ordánais Éireann arís atáirgeadh faoi Cheadúnas OSI Uimh. 2010/18CCMA/Comhairle Contae na Gaillimhe. Sáraíonn atáirgeadh neamh-daralthe cóipeacht Shuirbhéireacht Ordánais Éireann agus Rialtas na hÉireann. © Suirbhéireacht Ordánais Éireann, 2010.

© Suirbhéireacht Ordánais Éireann. Gach ceart ar chosaint. Uimh. cheadúnais 2010/18CCMA/Comhairle Contae na Gaillimhe.

Includes Ordnance Survey Ireland data reproduced under OSI Licence number 2010/18CCMA/Galway County Council. Unauthorised reproduction infringes Ordnance Survey Ireland and Government of Ireland copyright. © Ordnance Survey Ireland, 2010.

© Ordnance Survey Ireland. All rights reserved. Licence number 2010/18CCMA/Galway County Council.

**Clients**

Comhairle Chontae na Gaillimhe  
Galway County Council

AN6  
Galway City Transport Project

GA  
An Roinn Iompair  
Turasoireachta agus Spóirt  
Department of Transport, Tourism and Sport

TII  
Transport Infrastructure Ireland

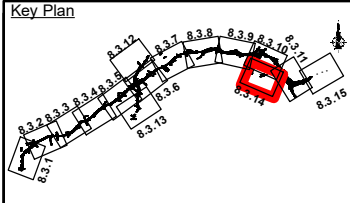

**Consultant**

**ARUP**

Corporate House  
City East Business Park  
Ballybrit, Galway, Ireland

Tel +353 (0)91 460675  
www.N6GalwayCity.ie  
www.arup.ie

**Job Title**  
N6 Galway City Ring Road

**Scale:** 1:5,000

**Date:** September 2018

I1	28/09/2018	AG	MH	EMC
Issue	Date	By	Chkd	Appd

**Drawing Title**  
Mammal Survey Study Area and Results  
Sheet 14 of 15  
Drawing Status

**For Information**

Job No	Drawing No	Issue
233985-00	Figure 8.3.14	11

**EIA REPORT**

- Legend**
- ■ ■ ■ City Boundary
  - Proposed Development Boundary
  - ▬ Proposed Road Development
  - ▭ Mammal Survey Area
  - ▨ Areas of Dense Vegetation- Partially Inaccessible

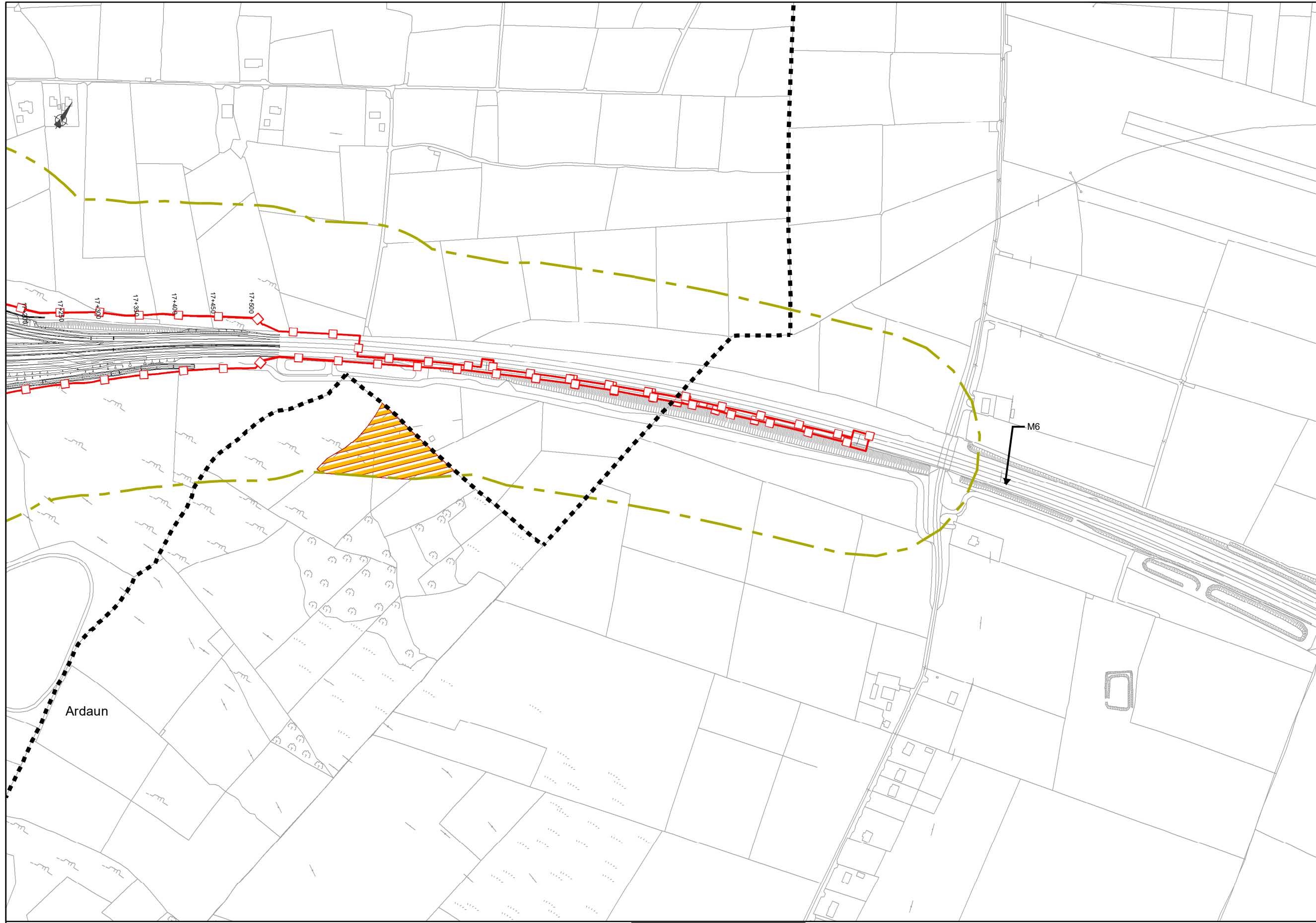

San áireamh tá sonraíocht Shuirbhéireacht Ordánais Éireann arna atáirgeadh faoi Cheadúnas OSI Uimh. 2010/18CCMA/Comhairle Contae na Gaillimhe. Sáraitonn atáirgeadh neamhdáraithe cóipeacht Shuirbhéireacht Ordánais Éireann agus Rialtas na hÉireann. © Suirbhéireacht Ordánais Éireann, 2010.

© Suirbhéireacht Ordánais Éireann. Gach ceart ar chosaint.  
Uimhír cheadúnais 2010/18CCMA/Comhairle Contae na Gaillimhe.

Includes Ordnance Survey Ireland data reproduced under OSI Licence number 2010/18CCMA/Galway County Council.  
Unauthorised reproduction infringes Ordnance Survey Ireland and Government of Ireland copyright. © Ordnance Survey Ireland, 2010.

© Ordnance Survey Ireland. All rights reserved. Licence number 2010/18CCMA/Galway County Council.

**Clients**

Comhairle Chontae na Gaillimhe  
Galway County Council

AN6  
Galway City Transport Project

GA  
An Roinn Iompair  
Turasoireachta agus Spóirt  
Department of Transport, Tourism and Sport

TII  
Transport Infrastructure Ireland

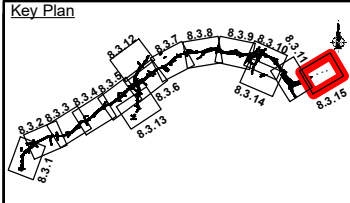

**Consultant**

**ARUP**

Corporate House  
City East Business Park  
Ballybrit, Galway, Ireland

Tel +353 (0)91 460675  
www.N6GalwayCity.ie  
www.arup.ie

**Job Title**  
N6 Galway City Ring Road

**Scale:** 1:5,000

**Date:** September 2018

I1	28/09/2018	AG	MH	EMC
Issue	Date	By	Chkd	Appd

**Drawing Title**  
Mammal Survey Study Area and Results  
Sheet 15 of 15  
Drawing Status

**For Information**

Job No	Drawing No	Issue
233985-00	Figure 8.3.15	I1