

EIA REPORT

Legend

- ■ ■ City Boundary
- Proposed Development Boundary
- ▨ Proposed Road Development
- ▭ Study Area 250m Buffer Zone

Subglacial Striae

↑ Striae

Landform

Indicator erratic source area

San áireamh tá sonraíocht Shuirbhéireacht Ordánais Éireann ama atáirgeadh faoi Cheadúnas OSI Uimh. 2010/18CCMA/Comhairle Contae na Gaillimhe. Sáralonn atáirgeadh neamhdánaithe cóipeacht Shuirbhéireacht Ordánais Éireann agus Rialtas na hÉireann. © Suirbhéireacht Ordánais Éireann, 2010.

©: Suirbhéireacht Ordánais Éireann. Gach ceart ar chosaint. Uimhir cheadúnais 2010/18CCMA/Comhairle Contae na Gaillimhe.

Includes Ordnance Survey Ireland data reproduced under OSI Licence number 2010/18CCMA/Galway County Council. Unauthorised reproduction infringes Ordnance Survey Ireland and Government of Ireland copyright. © Ordnance Survey Ireland, 2010.

©: Ordnance Survey Ireland. All rights reserved. Licence number 2010/18CCMA/Galway County Council.

Clients

Comhairle Chontae na Gaillimhe
Galway County Council

Galway City Transport Project

Galway County Council

Comhairle Chontae na Gaillimhe

Comhairle Chontae na Gaillimhe

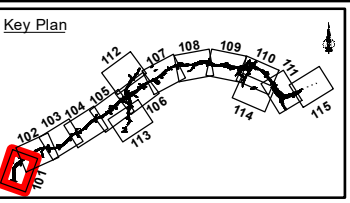

Consultant

ARUP

Corporate House
City East Business Park
Ballybrit, Galway, Ireland

Tel +353 (0)91 460675
www.N6GalwayCity.ie
www.arup.ie

Job Title

N6 Galway City Ring Road

Scale: 1:5,000

Date: September 2018

Issue	Date	By	Chkd	Appd
I1	28/09/2018	KJ	MH	EMC

Drawing Title

Quaternary Geology Mapping
Sheet 01 of 15

FOR INFORMATION

Job No	Drawing No	Issue
233985-00	Figure 9.1.101	I1

EIA REPORT

- Legend**
- ■ ■ ■ City Boundary
 - Proposed Development Boundary
 - ▨ Proposed Road Development
 - ▭ Study Area 250m Buffer Zone
- Landform**
- Indicator erratic source area

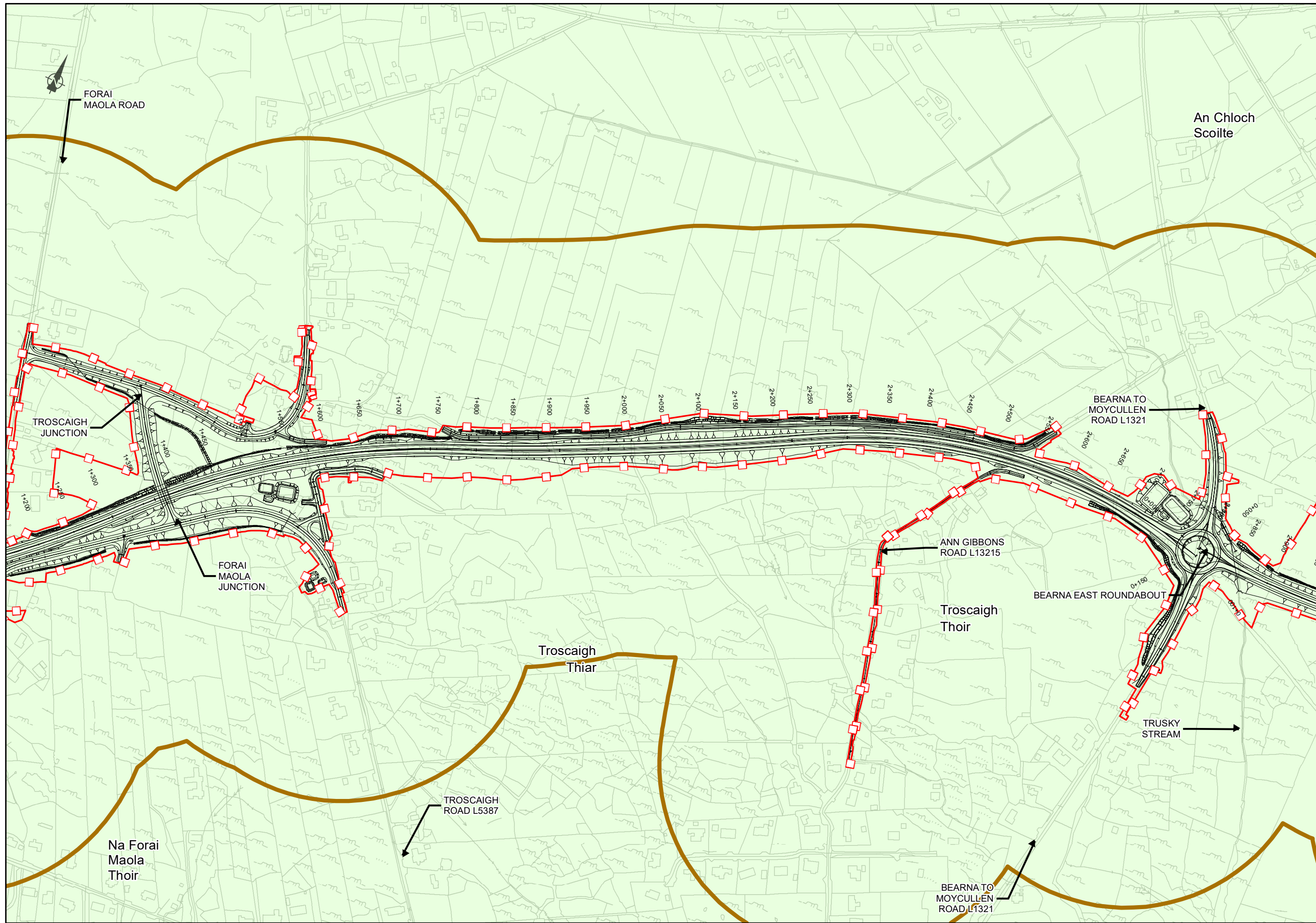

San áireamh tá sonraíocht Shuirbhéireacht Ordánais Éireann ama atáirgeadh faoi Cheadúnas OSI Uimh. 2010/18CCMA/Comhairle Contae na Gaillimhe. Sárailonn atáirgeadh neamhdhánaíthe cóipeacht Shuirbhéireacht Ordánais Éireann agus Rialtas na hÉireann. © Suirbhéireacht Ordánais Éireann, 2010.

©: Suirbhéireacht Ordánais Éireann. Gach ceart ar chosaint. Uimhir cheadúnais 2010/18CCMA/Comhairle Contae na Gaillimhe.

Includes Ordnance Survey Ireland data reproduced under OSI Licence number 2010/18CCMA/Galway County Council. Unauthorised reproduction infringes Ordnance Survey Ireland and Government of Ireland copyright. © Ordnance Survey Ireland, 2010.

©: Ordnance Survey Ireland. All rights reserved. Licence number 2010/18CCMA/Galway County Council.

Clients

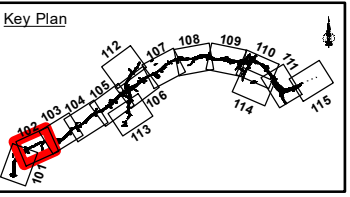

Consultant

Corporate House
City East Business Park
Ballybrit, Galway, Ireland

Tel +353 (0)91 460675
www.N6GalwayCity.ie
www.arup.ie

Job Title
N6 Galway City Ring Road

Scale: 1:5,000

Date: September 2018

Issue	Date	By	Chkd	Appd
I1	28/09/2018	KJ	MH	EMC

Drawing Title
Quaternary Geology Mapping
Sheet 02 of 15

FOR INFORMATION

Job No	Drawing No	Issue
233985-00	Figure 9.1.102	I1

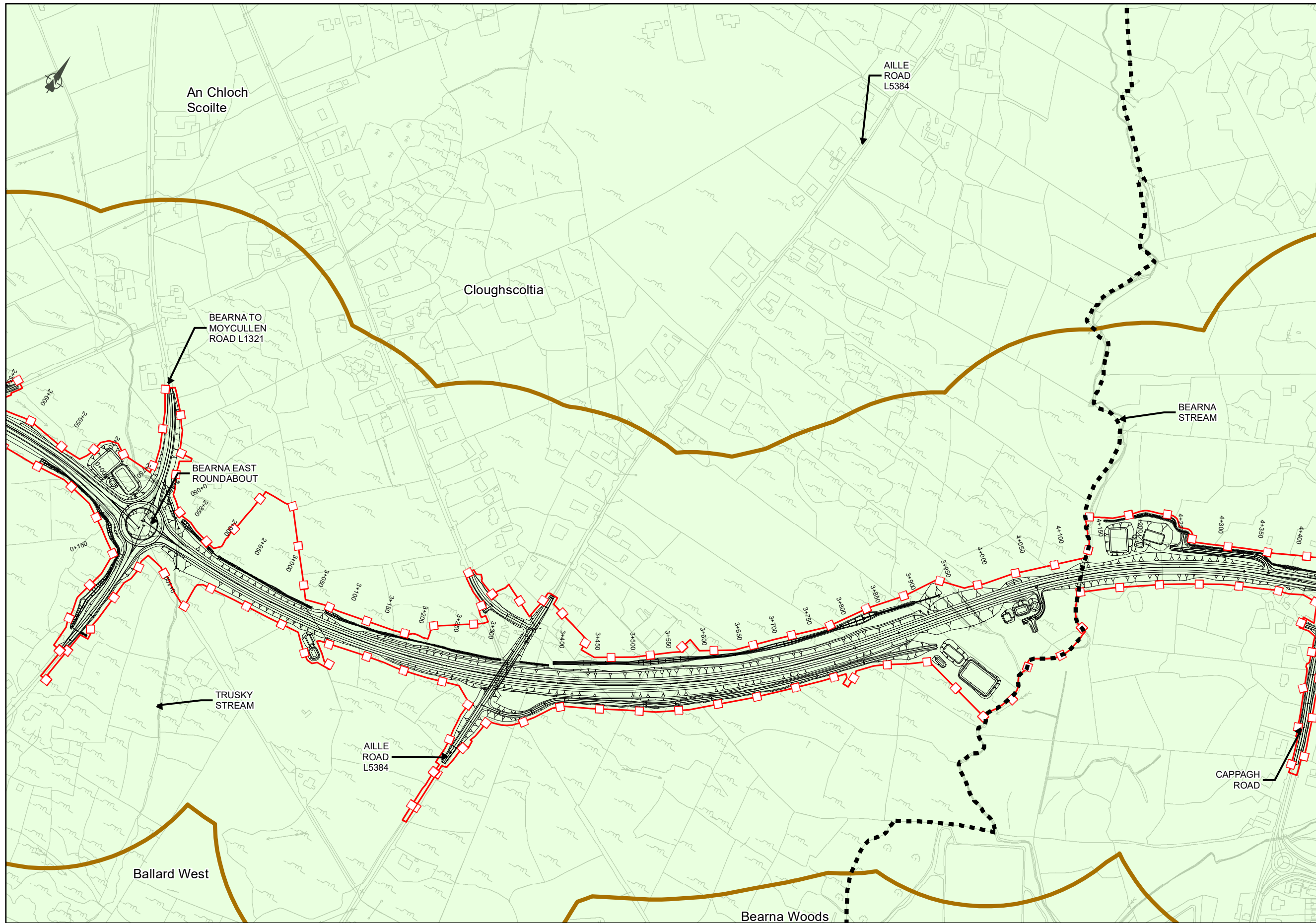

- Legend**
- City Boundary
 - Proposed Development Boundary
 - ▨ Proposed Road Development
 - ▭ Study Area 250m Buffer Zone
- Landform**
- Indicator erratic source area

San áireamh tá sonraíocht Shuirbhéireacht Ordánais Éireann ama atáirgeadh faoi Cheadúnas OSI Uimh. 2010/18CCMA/Comhairle Contae na Gaillimhe. Sáráilonn atáirgeadh neamhdánaithe cóipeacht Shuirbhéireacht Ordánais Éireann agus Rialtas na hÉireann. © Suirbhéireacht Ordánais Éireann, 2010.

©: Suirbhéireacht Ordánais Éireann. Gach ceart ar chosaint. Uimhir cheadúnais 2010/18CCMA/Comhairle Contae na Gaillimhe.

Includes Ordnance Survey Ireland data reproduced under OSI Licence number 2010/18CCMA/Galway County Council. Unauthorised reproduction infringes Ordnance Survey Ireland and Government of Ireland copyright. © Ordnance Survey Ireland, 2010.

©: Ordnance Survey Ireland. All rights reserved. Licence number 2010/18CCMA/Galway County Council.

Clients

Comhairle Chontae na Gaillimhe
Galway County Council

Galway City Transport Project

Galway County Council

Galway City Transport Project

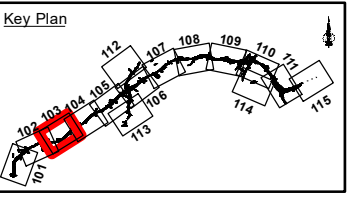

Consultant

ARUP

Corporate House
City East Business Park
Ballybrit, Galway, Ireland

Tel +353 (0)91 460675
www.N6GalwayCity.ie
www.arup.ie

Job Title

N6 Galway City Ring Road

Scale: 1:5,000

Date: September 2018

I1	28/09/2018	KJ	MH	EMC
Issue	Date	By	Chkd	Appd

Drawing Title

Quaternary Geology Mapping
Sheet 03 of 15

FOR INFORMATION

Job No	Drawing No	Issue
233985-00	Figure 9.1.103	11

EIA REPORT

- Legend**
- City Boundary
 - Proposed Development Boundary
 - ▨ Proposed Road Development
 - Study Area 250m Buffer Zone
- Subglacial Lineations**
- ▬ Streamlined Bedrock
- Landform**
- Indicator erratic source area

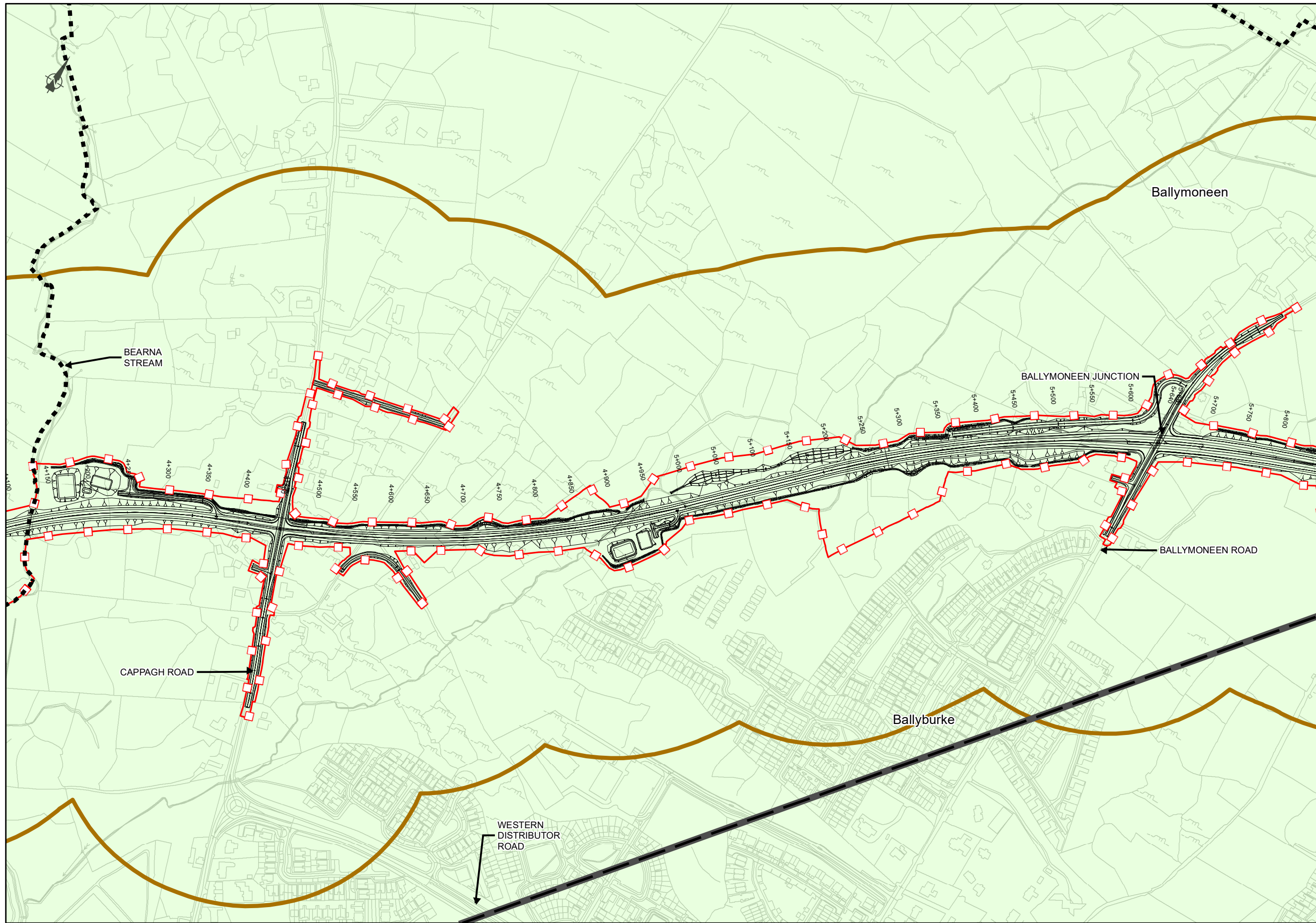

San áireamh tá sonraíocht Shuirbhéireacht Ordánais Éireann ama atáirgeadh faoi Cheadúnas OSI Uimh. 2010/18CCMA/Comhairle Contae na Gaillimhe. Sáralonn atáirgeadh neamhdánaithe cóipeacht Shuirbhéireacht Ordánais Éireann agus Ráilias na hÉireann. © Suirbhéireacht Ordánais Éireann, 2010.

©: Suirbhéireacht Ordánais Éireann. Gach ceart ar chosaint. Uimhir cheadúnais 2010/18CCMA/Comhairle Contae na Gaillimhe.

Includes Ordnance Survey Ireland data reproduced under OSI Licence number 2010/18CCMA/Galway County Council. Unauthorised reproduction infringes Ordnance Survey Ireland and Government of Ireland copyright. © Ordnance Survey Ireland, 2010.

©: Ordnance Survey Ireland. All rights reserved. Licence number 2010/18CCMA/Galway County Council.

Clients

Comhairle Chontae na Gaillimhe
Galway County Council

Galway City Transport Project

Galway County Council

Ar Roinn Iompair Turasóireachta agus Spóirt
Department of Transport, Tourism and Sport

TIIV
Transport Infrastructure and Vehicle

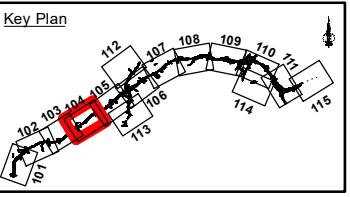

Consultant

ARUP

Corporate House
City East Business Park
Ballybrit, Galway, Ireland

Tel +353 (0)91 460675
www.N6GalwayCity.ie
www.arup.ie

Job Title

N6 Galway City Ring Road

Scale: 1:5,000

Date: September 2018

I1	28/09/2018	KJ	MH	EMC
Issue	Date	By	Chkd	Appd

Drawing Title

Quaternary Geology Mapping
Sheet 04 of 15

Drawing Status

FOR INFORMATION

Job No	Drawing No	Issue
233985-00	Figure 9.1.104	11

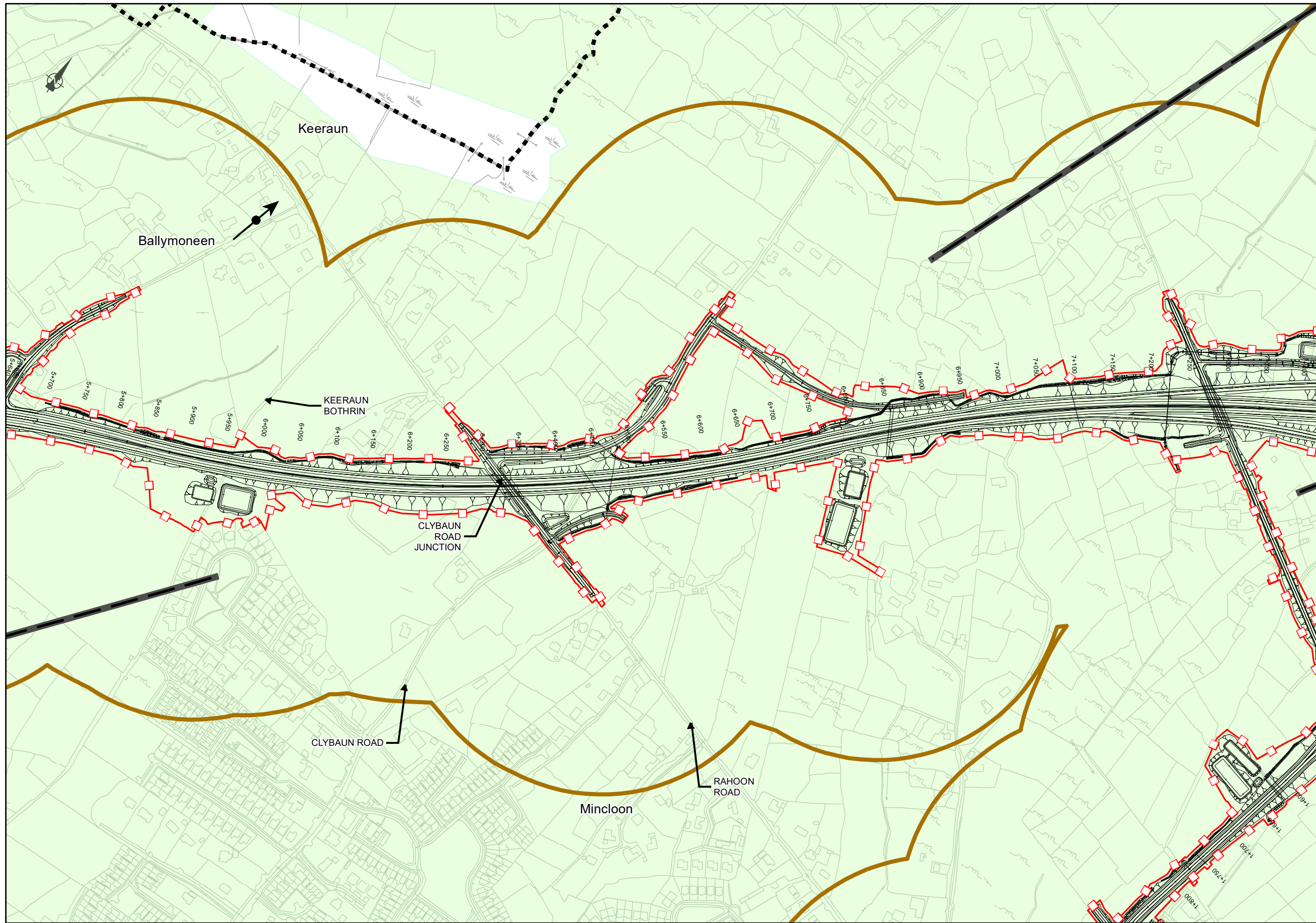

EIA REPORT

Legend

- City Boundary
- - - Proposed Development Boundary
- ▨ Proposed Road Development
- ▭ Study Area 250m Buffer Zone

Subglacial Striae

↑ Striae

Subglacial Lineations

▬ Streamlined Bedrock

Landform

▭ Indicator erratic source area

San áireamh tá sonraíocht Shuirbhéireacht Ordánais Éireann ama atáirgeadh faoi Cheadúnas OSI Uimh. 2010/18CCMA/Comhairle Contae na Gaillimhe. Sáralonn atáirgeadh neamhdánraíthe cóipeacht Shuirbhéireacht Ordánais Éireann agus Ráilias na hÉireann. © Suirbhéireacht Ordánais Éireann, 2010.

© Suirbhéireacht Ordánais Éireann. Gach ceart ar chosaint. Uimhir cheadúnais 2010/18CCMA/Comhairle Contae na Gaillimhe.

Includes Ordnance Survey Ireland data reproduced under OSI Licence number 2010/18CCMA/Galway County Council. Unauthorised reproduction infringes Ordnance Survey Ireland and Government of Ireland copyright. © Ordnance Survey Ireland, 2010.

© Ordnance Survey Ireland. All rights reserved. Licence number 2010/18CCMA/Galway County Council.

Clients

Comhairle Chontae na Gaillimhe
Galway County Council

Galway City Transport Project

Ar Roinn Iompair
Turasóireachta agus Spóirt
Department of Transport, Tourism and Sport

TII

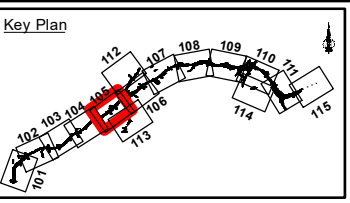

Consultant

ARUP

Corporate House
City East Business Park
Ballybrit, Galway, Ireland

Tel +353 (0)91 460675
www.N6GalwayCity.ie
www.arup.ie

Job Title

N6 Galway City Ring Road

Scale: 1:5,000

Date: September 2018

Drawing Title
Quaternary Geology Mapping
Sheet 05 of 15

FOR INFORMATION

I1	28/09/2018	KJ	MH	EMC
Issue	Date	By	Chkd	Appd

Job No: **233985-00** Drawing No: **Figure 9.1.105** Issue: **11**

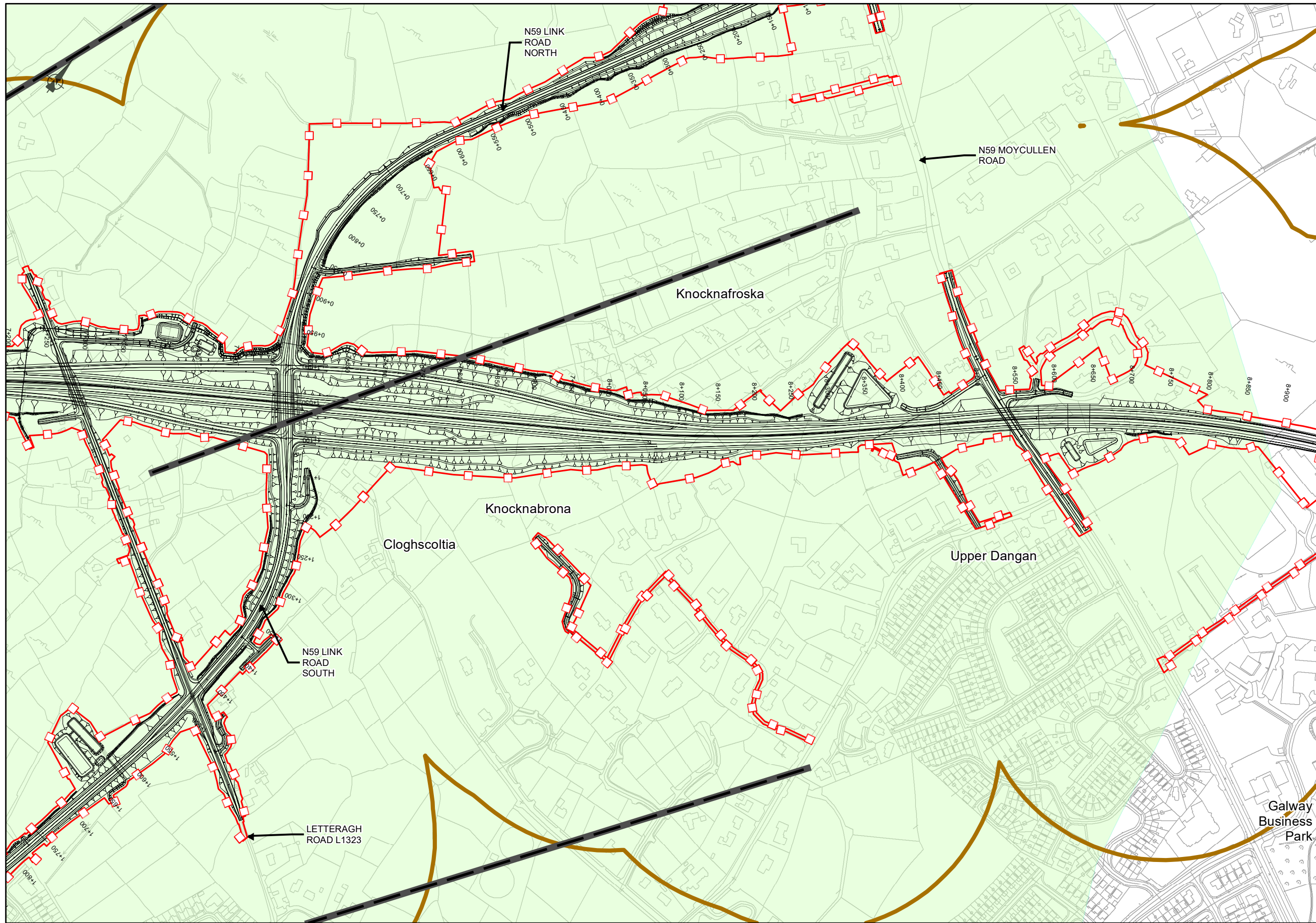

EIA REPORT

Legend

- ■ ■ City Boundary
- □ □ Proposed Development Boundary
- ▨ ▨ ▨ Proposed Road Development
- ▭ Study Area 250m Buffer Zone

Subglacial Lineations

- ▬ Streamlined Bedrock

Landform

- Indicator erratic source area

San áireamh tá sonraíocht Shuirbhéireacht Ordánais Éireann ama atáirgeadh faoi Cheadúnas OSI Uimh. 2010/18CCMA/Comhairle Contae na Gaillimhe. Sáralonn atáirgeadh neamhdánaithe cóipeacht Shuirbhéireacht Ordánais Éireann agus Rialtas na hÉireann. © Suirbhéireacht Ordánais Éireann, 2010.

©: Suirbhéireacht Ordánais Éireann. Gach ceart ar chosaint. Uimhir cheadúnais 2010/18CCMA/Comhairle Contae na Gaillimhe.

Includes Ordnance Survey Ireland data reproduced under OSI Licence number 2010/18CCMA/Galway County Council. Unauthorised reproduction infringes Ordnance Survey Ireland and Government of Ireland copyright. © Ordnance Survey Ireland, 2010.

©: Ordnance Survey Ireland. All rights reserved. Licence number 2010/18CCMA/Galway County Council.

Clients

Comhairle Chontae na Gaillimhe
Galway County Council

Galway City Transport Project

Ar Roinn Iompair
Turasóireachta agus Spóirt
Department of Transport, Tourism and Sport

TIIV
Transport Infrastructure Ireland

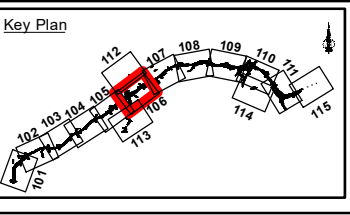

Consultant

ARUP

Corporate House
City East Business Park
Ballybrit, Galway, Ireland

Tel +353 (0)91 460675
www.N6GalwayCity.ie
www.arup.ie

Job Title

N6 Galway City Ring Road

Scale: 1:5,000

Date: September 2018

Issue	Date	By	Chkd	Appd
I1	28/09/2018	KJ	MH	EMC

Drawing Title

Quaternary Geology Mapping
Sheet 06 of 15

FOR INFORMATION

Job No	Drawing No	Issue
233985-00	Figure 9.1.106	I1

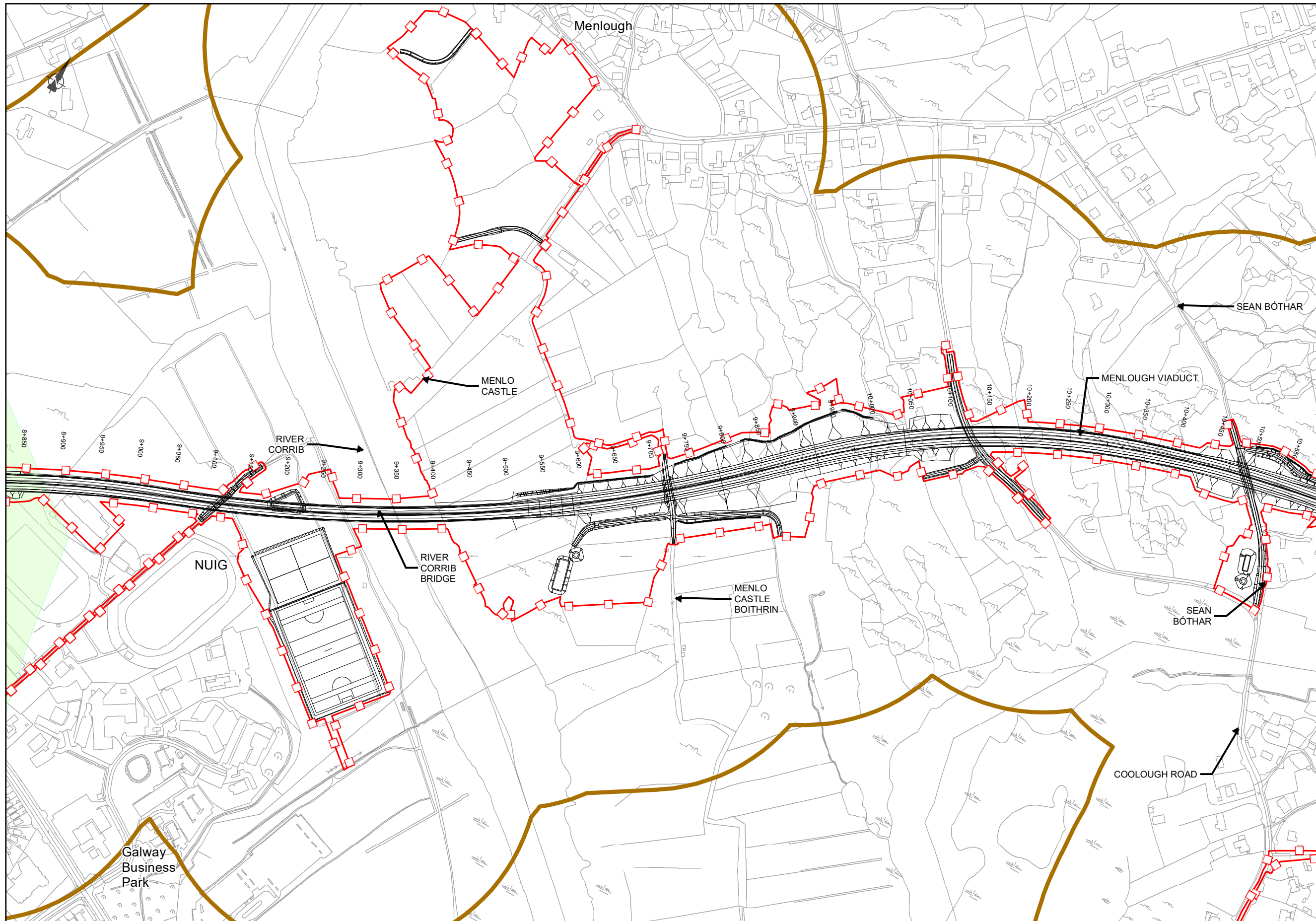

EIA REPORT

Legend

- ■ ■ City Boundary
- Proposed Development Boundary
- ▬ Proposed Road Development
- ▭ Study Area 250m Buffer Zone

Landform

- Indicator erratic source area

San áireamh tá sonraíocht Shuirbhéireacht Ordnáis Éireann ama atáirgeadh faoi Cheadúnas OSI Uimh. 2010/18CCMA/Comhairle Contae na Gaillimhe. Sáralonn atáirgeadh neamhdánaithe cóipeacht Shuirbhéireacht Ordnáis Éireann agus Rialtas na hÉireann. © Suirbhéireacht Ordnáis Éireann, 2010.

© Suirbhéireacht Ordnáis Éireann. Gach ceart ar chosaint. Uimhir cheadúnais 2010/18CCMA/Comhairle Contae na Gaillimhe.

Includes Ordnance Survey Ireland data reproduced under OSI Licence number 2010/18CCMA/Galway County Council. Unauthorised reproduction infringes Ordnance Survey Ireland and Government of Ireland copyright. © Ordnance Survey Ireland, 2010.

© Ordnance Survey Ireland. All rights reserved. Licence number 2010/18CCMA/Galway County Council.

Clients

Comhairle Chontae na Gaillimhe
Galway County Council

Galway City Transport Project

Galway County Council

Ar Roinn Iompair
Turasóireachta agus Spóirt
Department of Transport, Tourism and Sport

TIIV
Transport Infrastructure and Vehicle

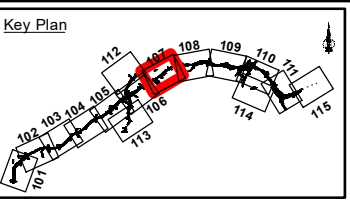

Consultant

ARUP

Corporate House
City East Business Park
Ballybrit, Galway, Ireland

Tel +353 (0)91 460675
www.N6GalwayCity.ie
www.arup.ie

Job Title

N6 Galway City Ring Road

Scale: 1:5,000

Date: September 2018

I1	28/09/2018	KJ	MH	EMC
Issue	Date	By	Chkd	Appd

Drawing Title

Quaternary Geology Mapping
Sheet 07 of 15

FOR INFORMATION

Job No: 233985-00
Drawing No: Figure 9.1.107
Issue: 11

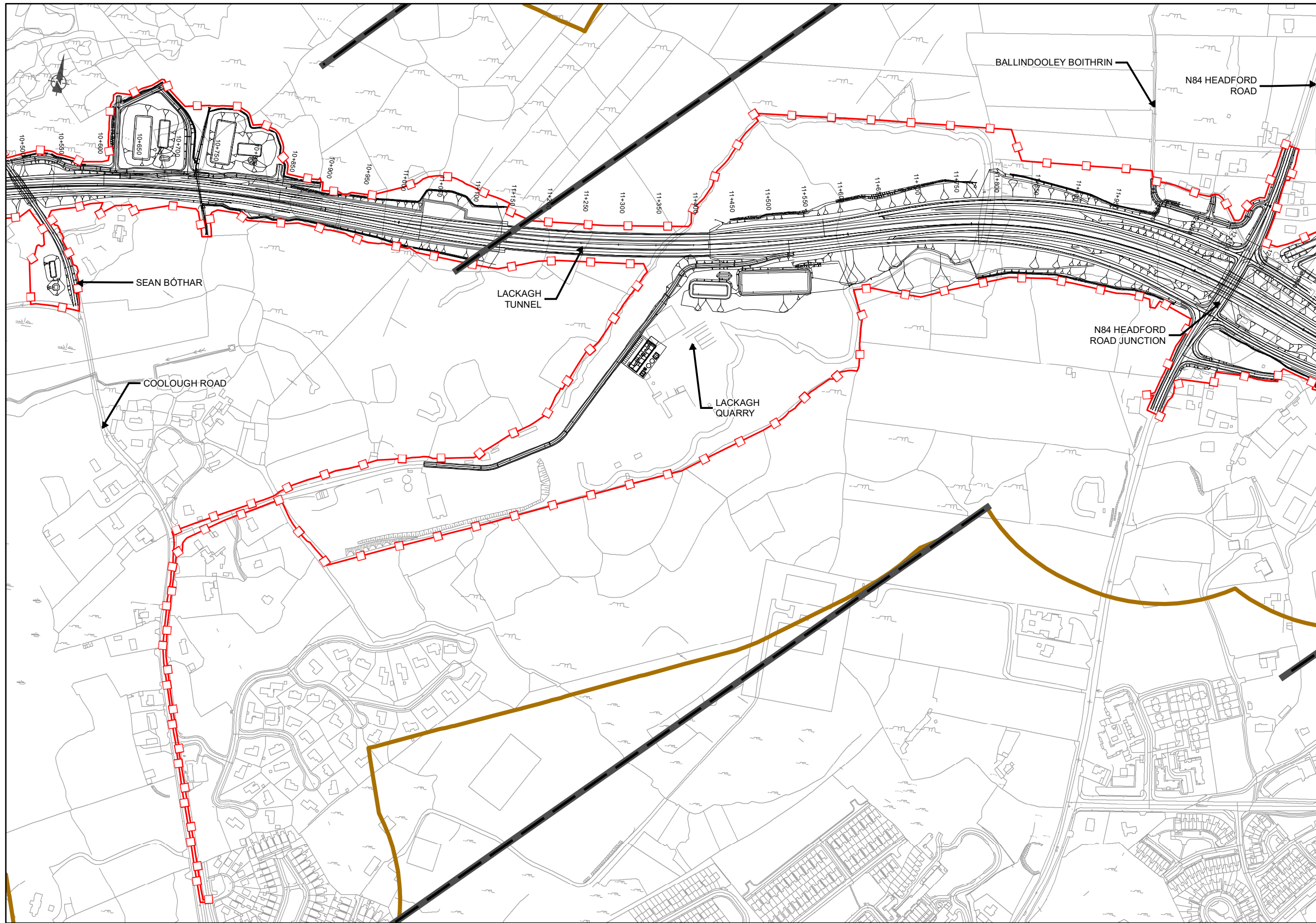

EIA REPORT

Legend

- ■ ■ City Boundary
- □ □ Proposed Development Boundary
- ▨ Proposed Road Development
- Study Area 250m Buffer Zone

Subglacial Lineations

- ▬ Streamlined Bedrock

San áireamh tá sonraíocht Shuirbhéireacht Ordánais Éireann ama atáirgeadh faoi Cheadúnas OSI Uimh. 2010/18CCMA/Comhairle Contae na Gaillimhe. Sáralonn atáirgeadh neamhdánaithe cóipeacht Shuirbhéireacht Ordánais Éireann agus Ráilias na hÉireann. © Suirbhéireacht Ordánais Éireann, 2010.

©: Suirbhéireacht Ordánais Éireann. Gach ceart ar chosaint. Uimhir cheadúnais 2010/18CCMA/Comhairle Contae na Gaillimhe.

Includes Ordnance Survey Ireland data reproduced under OSI Licence number 2010/18CCMA/Galway County Council. Unauthorised reproduction infringes Ordnance Survey Ireland and Government of Ireland copyright. © Ordnance Survey Ireland, 2010.

©: Ordnance Survey Ireland. All rights reserved. Licence number 2010/18CCMA/Galway County Council.

Clients

Comhairle Chontae na Gaillimhe
Galway County Council

AN6
Galway City Transport Project

GA
An Roinn Iompair
Turasóireachta agus Spóirt
Department of Transport, Tourism and Sport

TIIV
Transport Infrastructure
Investment Vehicle

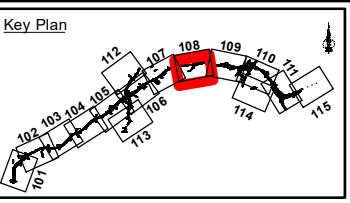

Consultant

ARUP

Corporate House
City East Business Park
Ballybrit, Galway, Ireland

Tel +353 (0)91 460675
www.N6GalwayCity.ie
www.arup.ie

Job Title

N6 Galway City Ring Road

Scale: 1:5,000

Date: September 2018

I1	28/09/2018	KJ	MH	EMC
Issue	Date	By	Chkd	Appd

Drawing Title

Quaternary Geology Mapping
Sheet 08 of 15

FOR INFORMATION

Job No	Drawing No	Issue
233985-00	Figure 9.1.108	11

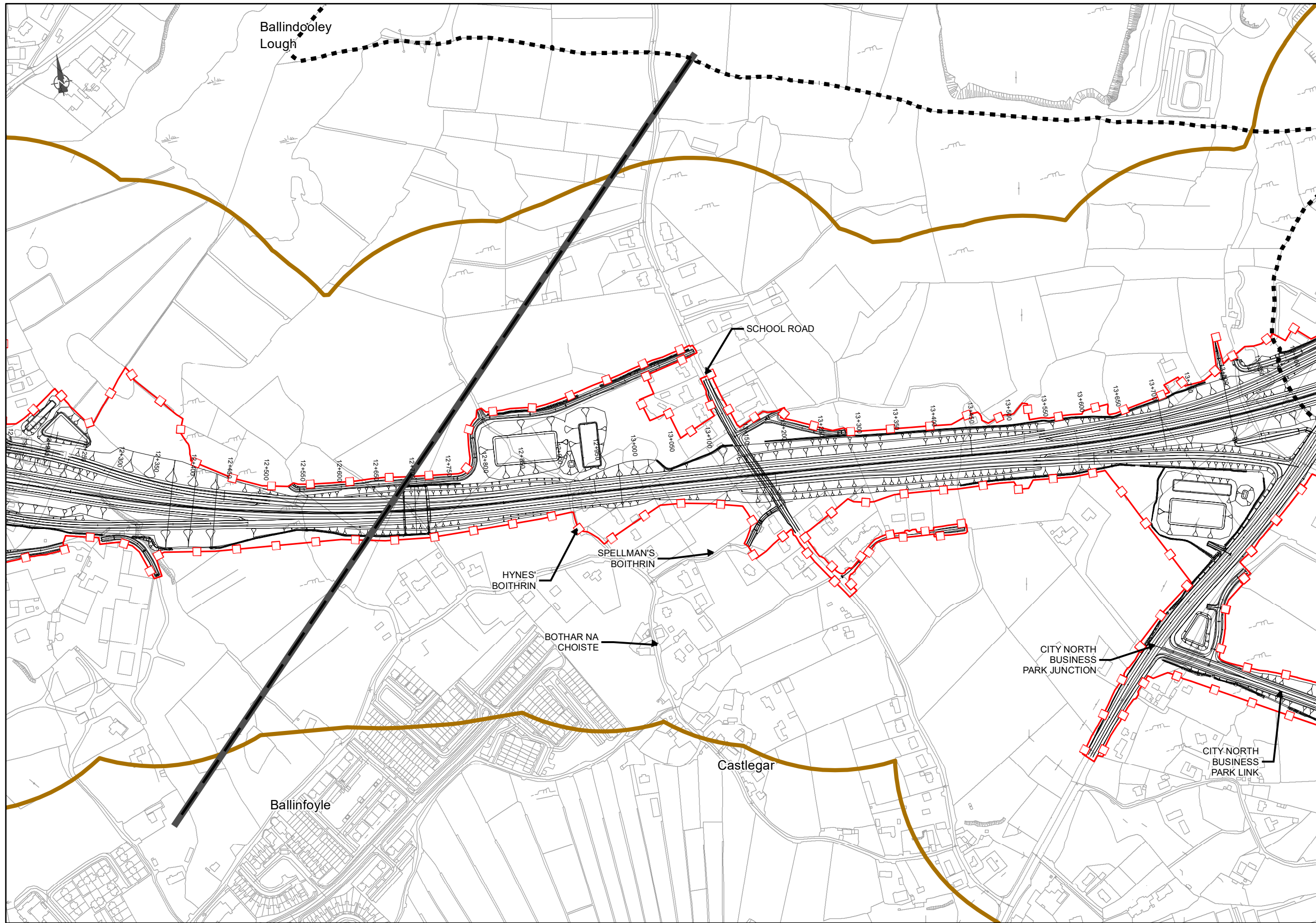

EIA REPORT

Legend

- City Boundary
- Proposed Development Boundary
- ▨ Proposed Road Development
- Study Area 250m Buffer Zone

Subglacial Lineations

- ▬ Streamlined Bedrock

San áireamh tá sonraíocht Shuirbhéireacht Ordánais Éireann ama atáirgeadh faoi Cheadúnas OSI Uimh. 2010/18CCMA/Comhairle Contae na Gaillimhe. Sáralonn atáirgeadh neamhdánaithe cóipeacht Shuirbhéireacht Ordánais Éireann agus Rialtas na hÉireann. © Suirbhéireacht Ordánais Éireann, 2010.

©: Suirbhéireacht Ordánais Éireann. Gach ceart ar chosaint. Uimhir cheadúnais 2010/18CCMA/Comhairle Contae na Gaillimhe.

Includes Ordnance Survey Ireland data reproduced under OSI Licence number 2010/18CCMA/Galway County Council. Unauthorised reproduction infringes Ordnance Survey Ireland and Government of Ireland copyright. © Ordnance Survey Ireland, 2010.

©: Ordnance Survey Ireland. All rights reserved. Licence number 2010/18CCMA/Galway County Council.

Clients

Comhairle Chontae na Gaillimhe
Galway County Council

AN6
Galway City Transport Project

GA
An Roinn Iompair
Tarasóireachta agus Spóirt
Department of Transport, Tourism and Sport

TII
Transport Infrastructure Ireland

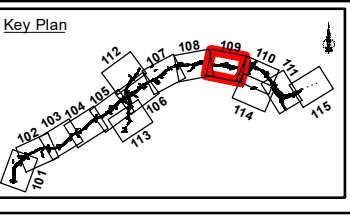

Consultant

ARUP

Corporate House
City East Business Park
Ballybrit, Galway, Ireland

Tel +353 (0)91 460675
www.N6GalwayCity.ie
www.arup.ie

Job Title

N6 Galway City Ring Road

Scale: 1:5,000

Date: September 2018

Issue	Date	By	Chkd	Appd
I1	28/09/2018	KJ	MH	EMC

Drawing Title

Quaternary Geology Mapping
Sheet 09 of 15

FOR INFORMATION

Job No	Drawing No	Issue
233985-00	Figure 9.1.109	I1

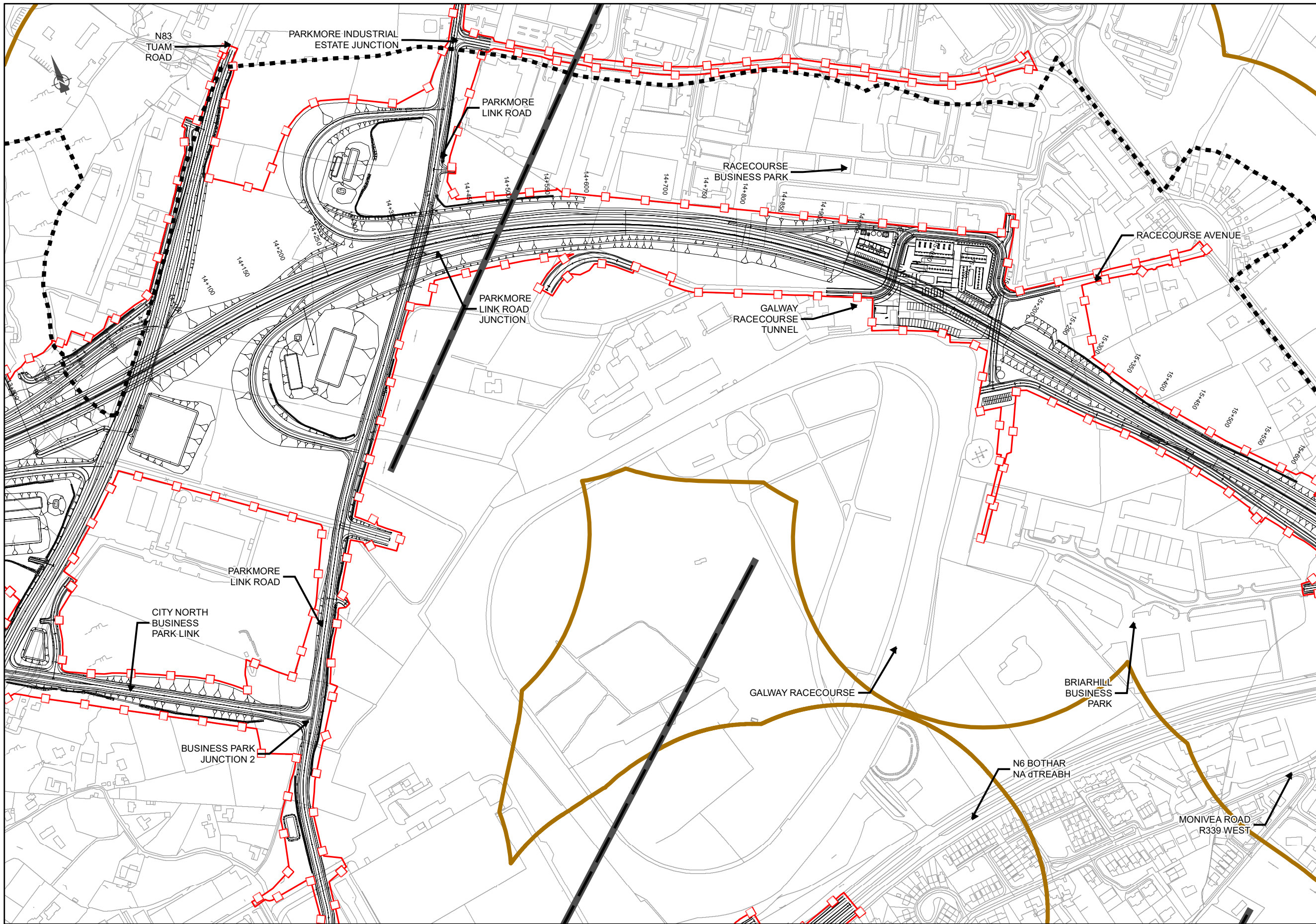

EIA REPORT

Legend

- City Boundary
- - - Proposed Development Boundary
- ▨ Proposed Road Development
- Study Area 250m Buffer Zone

Subglacial Lineations

- ▬ Streamlined Bedrock

San áireamh tá sonraíocht Shuirbhéireacht Ordánais Éireann ama atáirgeadh faoi Cheadúnas OSI Uimh. 2010/18CCMA/Comhairle Contae na Gaillimhe. Sáralonn atáirgeadh neamhdánartha cóipeacht Shuirbhéireacht Ordánais Éireann agus Rialtas na hÉireann. © Suirbhéireacht Ordánais Éireann, 2010.

©: Suirbhéireacht Ordánais Éireann. Gach ceart ar chosaint. Uimhir cheadúnais 2010/18CCMA/Comhairle Contae na Gaillimhe.

Includes Ordnance Survey Ireland data reproduced under OSI Licence number 2010/18CCMA/Galway County Council. Unauthorised reproduction infringes Ordnance Survey Ireland and Government of Ireland copyright. © Ordnance Survey Ireland, 2010.

©: Ordnance Survey Ireland. All rights reserved. Licence number 2010/18CCMA/Galway County Council.

Clients

Comhairle Chontae na Gaillimhe
Galway County Council

N6
Galway City Transport Project

GA
An Roinn Iompair
Tarasóireachta agus Spóirt
Department of Transport, Tourism and Sport

TIIV
Transport Infrastructure Ireland

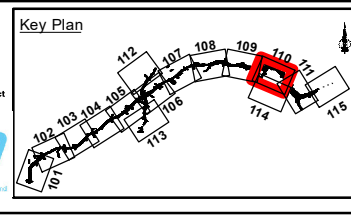

Consultant

ARUP

Corporate House
City East Business Park
Ballybrit, Galway, Ireland

Tel: +353 (0)91 460675
www.N6GalwayCity.ie
www.arup.ie

Job Title

N6 Galway City Ring Road

Scale: 1:5,000

Date: September 2018

Issue	Date	By	Chkd	Appd
I1	28/09/2018	KJ	MH	EMC

Drawing Title

Quaternary Geology Mapping
Sheet 10 of 15

Drawing Status

FOR INFORMATION

Job No	Drawing No	Issue
233985-00	Figure 9.1.110	I1

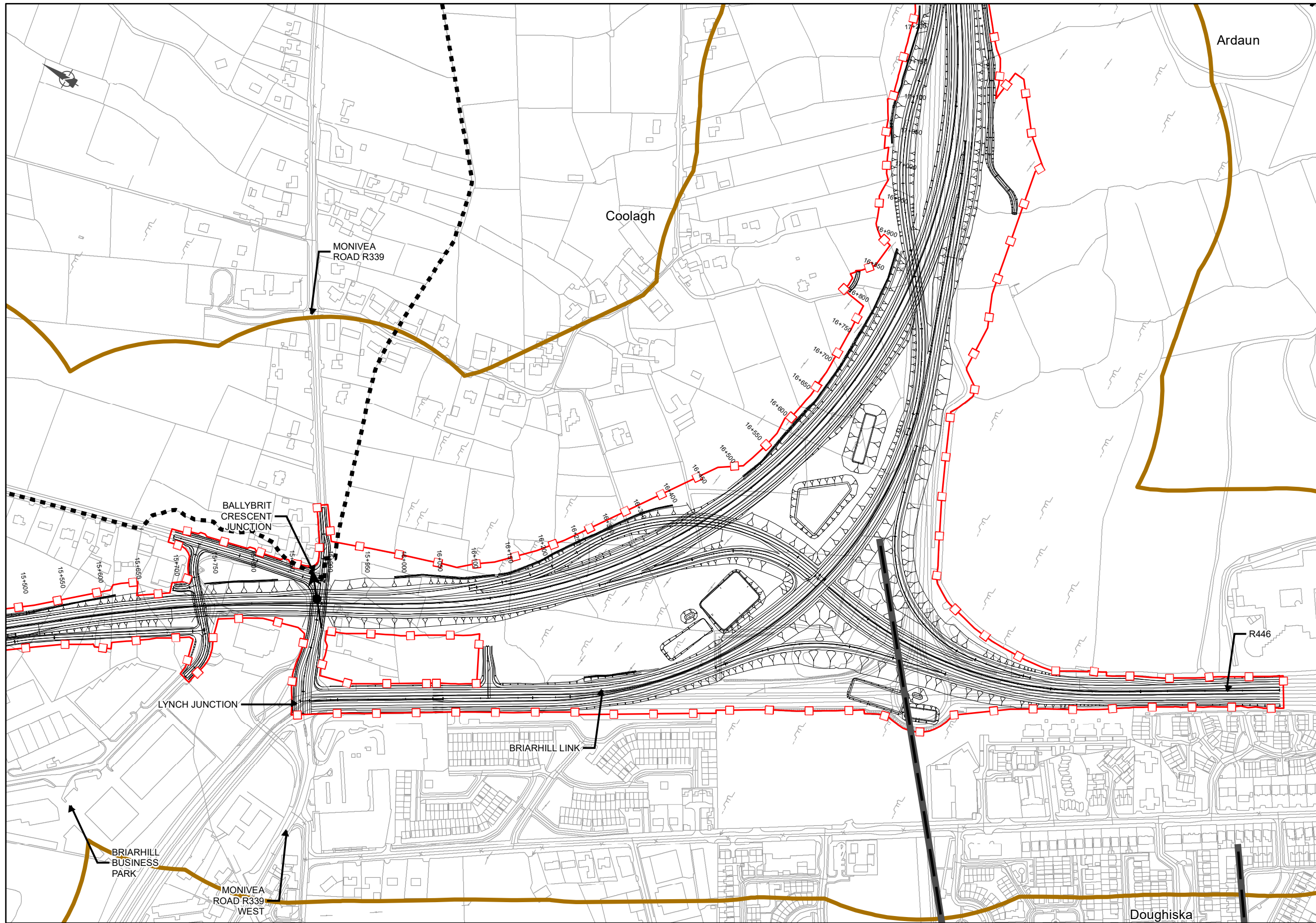

EIA REPORT

Legend

- City Boundary
- - - Proposed Development Boundary
- ▨ Proposed Road Development
- Study Area 250m Buffer Zone

Subglacial Striae

↑ Striae

Subglacial Lineations

▬ Streamlined Bedrock

San áireamh tá sonraíocht Shuirbhéireacht Ordánais Éireann ama atáirgeadh faoi Cheadúnas OSI Uimh. 2010/18CCMA/Comhairle Contae na Gaillimhe. Sáráilonn atáirgeadh neamhdánaithe cóipeacht Shuirbhéireacht Ordánais Éireann agus Rialtas na hÉireann. © Suirbhéireacht Ordánais Éireann, 2010.

©: Suirbhéireacht Ordánais Éireann. Gach ceart ar chosaint. Uimhir cheadúnais 2010/18CCMA/Comhairle Contae na Gaillimhe.

Includes Ordnance Survey Ireland data reproduced under OSI Licence number 2010/18CCMA/Galway County Council. Unauthorised reproduction infringes Ordnance Survey Ireland and Government of Ireland copyright. © Ordnance Survey Ireland, 2010.

©: Ordnance Survey Ireland. All rights reserved. Licence number 2010/18CCMA/Galway County Council.

Clients

Comhairle Chontae na Gaillimhe
Galway County Council

AN6
Galway City Transport Project

GA
An Roinn Iompair
Tarasóireachta agus Spóirt
Department of Transport, Tourism and Sport

TII
Transport Infrastructure Ireland

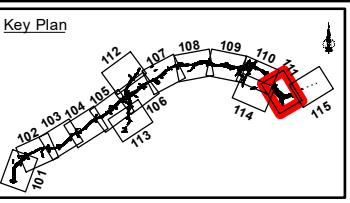

Consultant

ARUP

Corporate House
City East Business Park
Ballybrit, Galway, Ireland

Tel +353 (0)91 460675
www.N6GalwayCity.ie
www.arup.ie

Job Title

N6 Galway City Ring Road

Scale: 1:5,000

Date: September 2018

I1	28/09/2018	KJ	MH	EMC
Issue	Date	By	Chkd	Appd

Drawing Title

Quaternary Geology Mapping
Sheet 11 of 15

FOR INFORMATION

Job No	Drawing No	Issue
233985-00	Figure 9.1.111	11

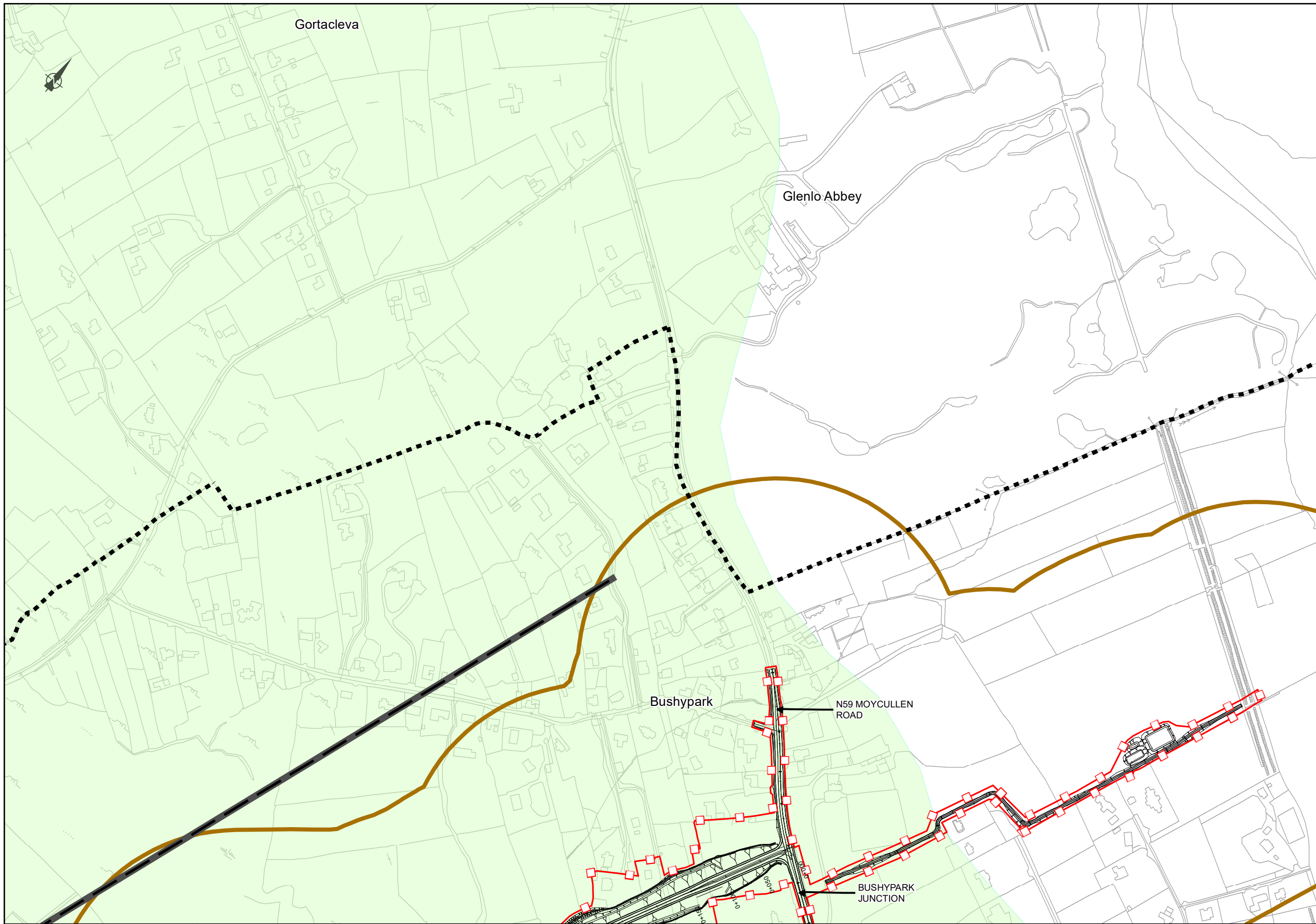

EIA REPORT

Legend

- ■ ■ ■ City Boundary
- — □ Proposed Development Boundary
- ▨ Proposed Road Development
- ▭ Study Area 250m Buffer Zone

Subglacial Lineations

- ▬ Streamlined Bedrock

Landform

- Indicator erratic source area

San áireamh tá sonraíocht Shuirbhéireacht Ordnáis Éireann ama atáirgeadh faoi Cheadúnas OSI Uimh. 2010/18CCMA/Comhairle Contae na Gaillimhe. Sáralonn atáirgeadh neamhdánaithe cóipcheart Shuirbhéireacht Ordnáis Éireann agus Rátaís na hÉireann. © Suirbhéireacht Ordnáis Éireann, 2010.

©: Suirbhéireacht Ordnáis Éireann. Gach ceart ar chosaint. Uimhir cheadúnais 2010/18CCMA/Comhairle Contae na Gaillimhe.

Includes Ordnance Survey Ireland data reproduced under OSI Licence number 2010/18CCMA/Galway County Council. Unauthorised reproduction infringes Ordnance Survey Ireland and Government of Ireland copyright. © Ordnance Survey Ireland, 2010.

©: Ordnance Survey Ireland. All rights reserved. Licence number 2010/18CCMA/Galway County Council.

Clients

Comhairle Chontae na Gaillimhe
Galway County Council

AN6
Galway City Transport Project

GA
An Roinn Iompair
Turasóireachta agus Spóirt
Department of Transport, Tourism and Sport

TIIV
Transport Infrastructure
Investment Vehicle

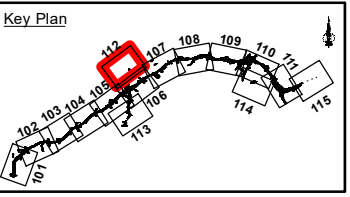

Consultant

ARUP

Corporate House
City East Business Park
Ballybrit, Galway, Ireland

Tel +353 (0)91 460675
www.N6GalwayCity.ie
www.arup.ie

Job Title

N6 Galway City Ring Road

Scale: **1:5,000**

Date: **September 2018**

Issue	Date	By	Chkd	Appd
I1	28/09/2018	KJ	MH	EMC

Drawing Title

Quaternary Geology Mapping
Sheet 12 of 15

Drawing Status

FOR INFORMATION

Job No	Drawing No	Issue
233985-00	Figure 9.1.112	I1



EIA REPORT

Legend

- City Boundary
- Proposed Development Boundary
- Proposed Road Development
- Study Area 250m Buffer Zone

Subglacial Striae

- Striae

Subglacial Lineations

- Streamlined Bedrock

Landform

- Indicator erratic source area

San áireamh tá sonraíocht Shuirbhéireacht Ordánais Éireann ama atáirgeadh faoi Cheadúnas OSI Uimh. 2010/18CCMA/Comhairle Contae na Gaillimhe. Sáralonn atáirgeadh neamhdánaithe cóipcheart Shuirbhéireacht Ordánais Éireann agus Rialtas na hÉireann. © Suirbhéireacht Ordánais Éireann, 2010.

©: Suirbhéireacht Ordánais Éireann. Gach ceart ar chosaint. Uimhir cheadúnais 2010/18CCMA/Comhairle Contae na Gaillimhe.

Includes Ordnance Survey Ireland data reproduced under OSI Licence number 2010/18CCMA/Galway County Council. Unauthorised reproduction infringes Ordnance Survey Ireland and Government of Ireland copyright. © Ordnance Survey Ireland, 2010.

©: Ordnance Survey Ireland. All rights reserved. Licence number 2010/18CCMA/Galway County Council.

Clients

Comhairle Chontae na Gaillimhe
Galway County Council

Comhairle Chontae na Gaillimhe
Galway County Council

Comhairle Chontae na Gaillimhe
Galway County Council

Comhairle Chontae na Gaillimhe
Galway County Council

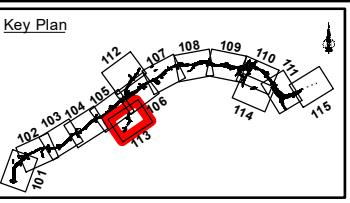

Consultant

ARUP

Corporate House
City East Business Park
Ballybrit, Galway, Ireland

Tel +353 (0)91 460675
www.N6GalwayCity.ie
www.arup.ie

Job Title

N6 Galway City Ring Road

Scale: 1:5,000

Date: September 2018

I1	28/09/2018	KJ	MH	EMC
Issue	Date	By	Chkd	Appd

Drawing Title

Quaternary Geology Mapping
Sheet 13 of 15

FOR INFORMATION

Job No	Drawing No	Issue
233985-00	Figure 9.1.113	11



EIA REPORT

Legend

- ■ ■ City Boundary
- Proposed Development Boundary
- ▨ Proposed Road Development
- Study Area 250m Buffer Zone

Subglacial Lineations

- ▬ Streamlined Bedrock

San áireamh tá sonraíocht Shuirbhéireacht Ordánais Éireann ama atáirgeadh faoi Cheadúnas OSI Uimh. 2010/18CCMA/Comhairle Contae na Gaillimhe. Sáralonn atáirgeadh neamhdánaithe cóipeacht Shuirbhéireacht Ordánais Éireann agus Ráilias na hÉireann. © Suirbhéireacht Ordánais Éireann, 2010.

© Suirbhéireacht Ordánais Éireann. Gach ceart ar chosaint. Uimhir cheadúnais 2010/18CCMA/Comhairle Contae na Gaillimhe.

Includes Ordnance Survey Ireland data reproduced under OSI Licence number 2010/18CCMA/Galway County Council. Unauthorised reproduction infringes Ordnance Survey Ireland and Government of Ireland copyright. © Ordnance Survey Ireland, 2010.

© Ordnance Survey Ireland. All rights reserved. Licence number 2010/18CCMA/Galway County Council.

Clients

Comhairle Chontae na Gaillimhe
Galway County Council

N6
Galway City Transport Project

GA
An Roinn Iompair
Turasóireachta agus Spóirt
Department of Transport, Tourism and Sport

TIU
Transport Infrastructure Unit

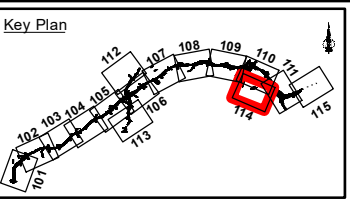

Consultant

ARUP

Corporate House
City East Business Park
Ballybrit, Galway, Ireland

Tel +353 (0)91 460675
www.N6GalwayCity.ie
www.arup.ie

Job Title

N6 Galway City Ring Road

Scale: 1:5,000

Date: September 2018

I1	28/09/2018	KJ	MH	EMC
Issue	Date	By	Chkd	Appd

Drawing Title

Quaternary Geology Mapping
Sheet 14 of 15

Drawing Status

FOR INFORMATION

Job No	Drawing No	Issue
233985-00	Figure 9.1.114	11

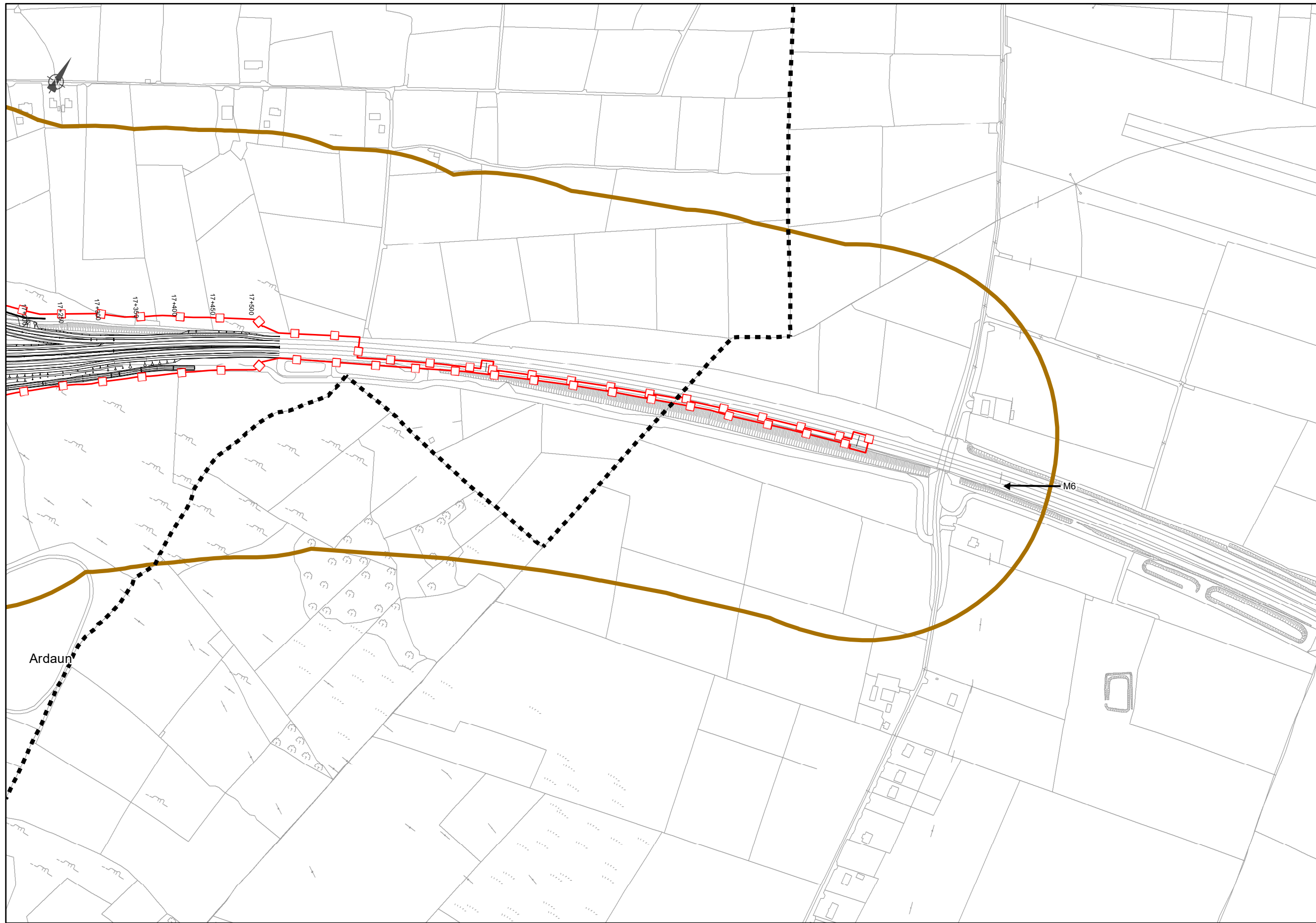

EIA REPORT

Legend

- ■ ■ ■ City Boundary
- — □ Proposed Development Boundary
- ▨ Proposed Road Development
- ▭ Study Area 250m Buffer Zone

San áireamh tá sonraíocht Shuirbhéireacht Ordnáis Éireann ama atáirgeadh faoi Cheadúnas OSI Uimh. 2010/18CCMA/Comhairle Contae na Gaillimhe. Sáralonn atáirgeadh neamhdánaithe cóipeacht Shuirbhéireacht Ordnáis Éireann agus Rialtas na hÉireann. © Suirbhéireacht Ordnáis Éireann, 2010.

©: Suirbhéireacht Ordnáis Éireann. Gach ceart ar chosaint. Uimhir cheadúnais 2010/18CCMA/Comhairle Contae na Gaillimhe.

Includes Ordnance Survey Ireland data reproduced under OSI Licence number 2010/18CCMA/Galway County Council. Unauthorised reproduction infringes Ordnance Survey Ireland and Government of Ireland copyright. © Ordnance Survey Ireland, 2010.

©: Ordnance Survey Ireland. All rights reserved. Licence number 2010/18CCMA/Galway County Council.

Clients

Comhairle Chontae na Gaillimhe
Galway County Council

AN6
Galway City Transport Project

GA
An Roinn Iompair
Turasoireachta agus Spóirt
Department of Transport, Tourism and Sport

TIIV
Transport Infrastructure Ireland

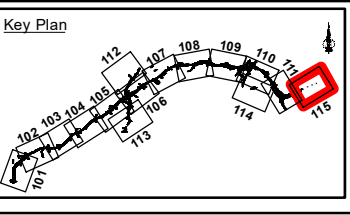

Consultant

ARUP

Corporate House
City East Business Park
Ballybrit, Galway, Ireland

Tel +353 (0)91 460675
www.N6GalwayCity.ie
www.arup.ie

Job Title
N6 Galway City Ring Road

Scale: 1:5,000

Date: September 2018

I1	28/09/2018	KJ	MH	EMC
Issue	Date	By	Chkd	Appd

Drawing Title
Quaternary Geology Mapping
Sheet 15 of 15

Drawing Status
FOR INFORMATION

Job No	Drawing No	Issue
233985-00	Figure 9.1.115	11