

EIA REPORT

Legend

- City Boundary
- Proposed Development Boundary
- ▨ Proposed Road Development
- ▭ Study Area 250m Buffer Zone
- Boundary of igneous intrusion
- Dyke/Sill
- Fault

Bedrock Formations

- ▭ Porphyritic Megacrystic Granite

San áireamh tá sonraíocht Shuirbhéireacht Ordánais Éireann arna atáirgeadh faoi Cheadúnas OSI Uimh. 2010/18CCMA/Comhairle Contae na Gaillimhe. Sáraíonn atáirgeadh neamhdánaithe cóipeacht Shuirbhéireacht Ordánais Éireann agus Rialtas na hÉireann. © Suirbhéireacht Ordánais Éireann, 2010.

©: Suirbhéireacht Ordánais Éireann. Gach ceart ar chosaint. Uimhir cheadúnais 2010/18CCMA/Comhairle Contae na Gaillimhe.

Includes Ordnance Survey Ireland data reproduced under OSI Licence number 2010/18CCMA/Galway County Council. Unauthorised reproduction infringes Ordnance Survey Ireland and Government of Ireland copyright. © Ordnance Survey Ireland, 2010.

©: Ordnance Survey Ireland. All rights reserved. Licence number 2010/18CCMA/Galway County Council.

Clients

Comhairle Chontae na Gaillimhe
Galway County Council

AN6
Galway City Transport Project

GA
An Roinn Iompair
Turasóireachta agus Spóirt
Department of Transport, Tourism and Sport

TII
Transport Infrastructure Ireland

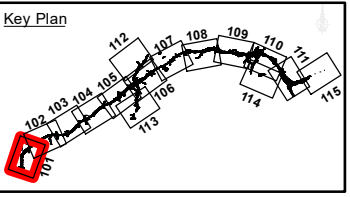

Consultant

ARUP

Corporate House
City East Business Park
Ballybrit, Galway, Ireland

Tel +353 (0)91 460675
www.N6GalwayCity.ie
www.arup.ie

Job Title
N6 Galway City Ring Road

Scale: 1:5,000

Date: September 2018

I1	28/09/2018	KJ	MH	EMC
Issue	Date	By	Chkd	Appd

Drawing Title
Solid Geology Mapping
Sheet 01 of 15

FOR INFORMATION

Job No	Drawing No	Issue
233985-00	Figure 9.5.101	11

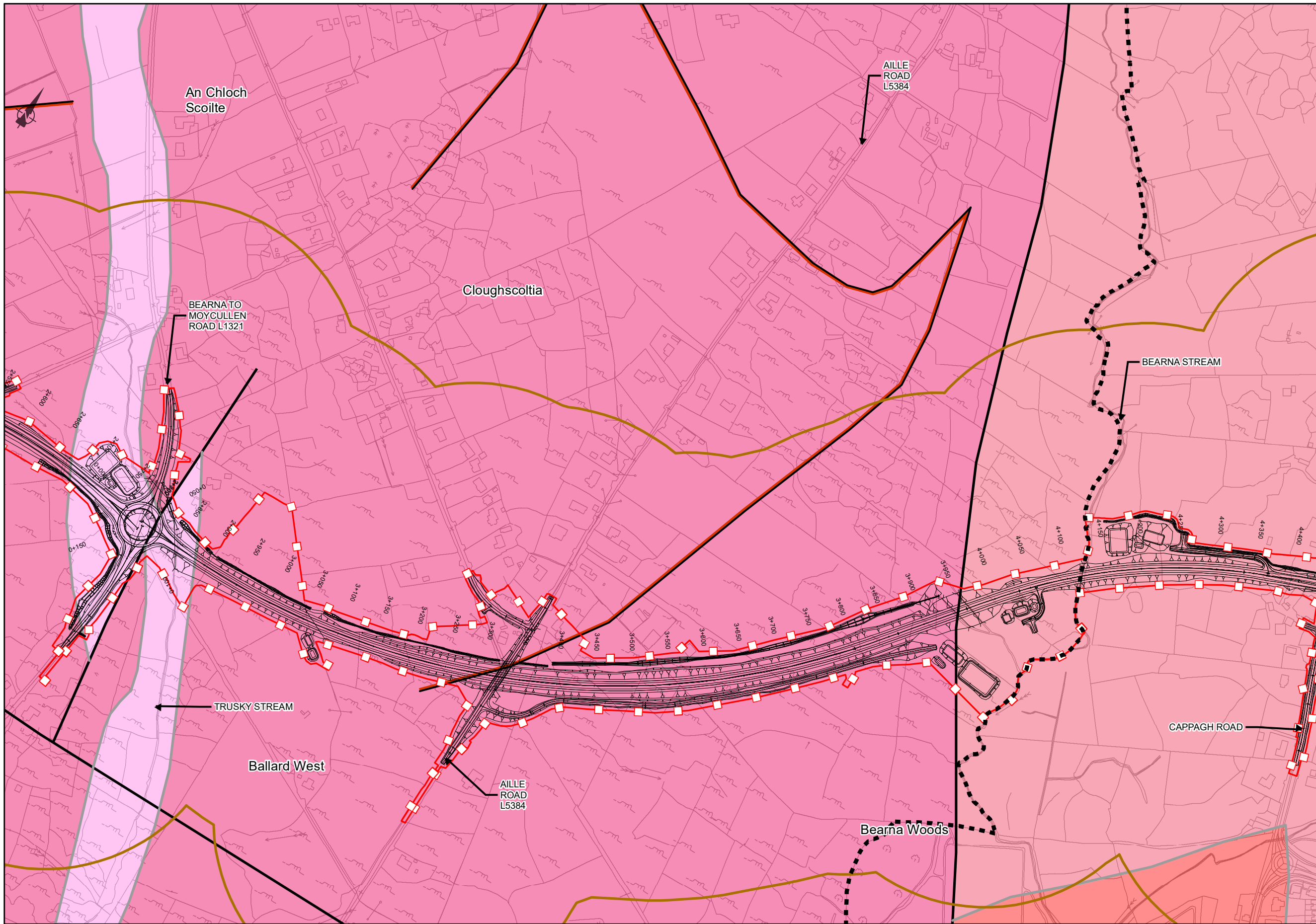

EIA REPORT

Legend

- City Boundary
- Proposed Development Boundary
- ▨ Proposed Road Development
- Study Area 250m Buffer Zone
- Boundary of igneous intrusion
- Dyke/Sill
- Fault

Bedrock Formations

- Errisbeg Townland Granite
- Fine-grained Foliated Granite
- Murvey Granite
- Porphyritic Megacrystic Granite

San áireamh tá sonraíocht Shuirbhéireacht Ordánais Éireann arna áirgeadh faoi Cheadúnas OSI Uimh. 2010/18CCMA/Comhairle Contae na Gaillimhe. Sáraíonn áirgeadh neamhdánaithe cóipeacht Shuirbhéireacht Ordánais Éireann agus Rialtas na hÉireann. © Suirbhéireacht Ordánais Éireann, 2010.

© Suirbhéireacht Ordánais Éireann. Gach ceart ar chosaint. Uimhir cheadúnais 2010/18CCMA/Comhairle Contae na Gaillimhe.

Includes Ordnance Survey Ireland data reproduced under OSI Licence number 2010/18CCMA/Galway County Council. Unauthorised reproduction infringes Ordnance Survey Ireland and Government of Ireland copyright. © Ordnance Survey Ireland, 2010.

© Ordnance Survey Ireland. All rights reserved. Licence number 2010/18CCMA/Galway County Council.

Clients

Comhairle Chontae na Gaillimhe
Galway County Council

AN6
Galway City Transport Project

GA
An Roinn Iompair
Turasóireachta agus Spóirt
Department of Transport, Tourism and Sport

TIIV
Transport Infrastructure and Vehicle

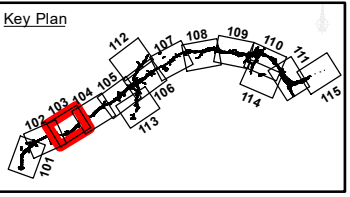

Consultant

ARUP

Corporate House
City East Business Park
Ballybrit, Galway, Ireland

Tel +353 (0)91 460675
www.N6GalwayCity.ie
www.arup.ie

Job Title

N6 Galway City Ring Road

Scale: 1:5,000

Date: September 2018

I1	28/09/2018	KJ	MH	EMC
Issue	Date	By	Chkd	Appd

Drawing Title

Solid Geology Mapping Sheet 03 of 15

FOR INFORMATION

Job No	Drawing No	Issue
233985-00	Figure 9.5.103	11

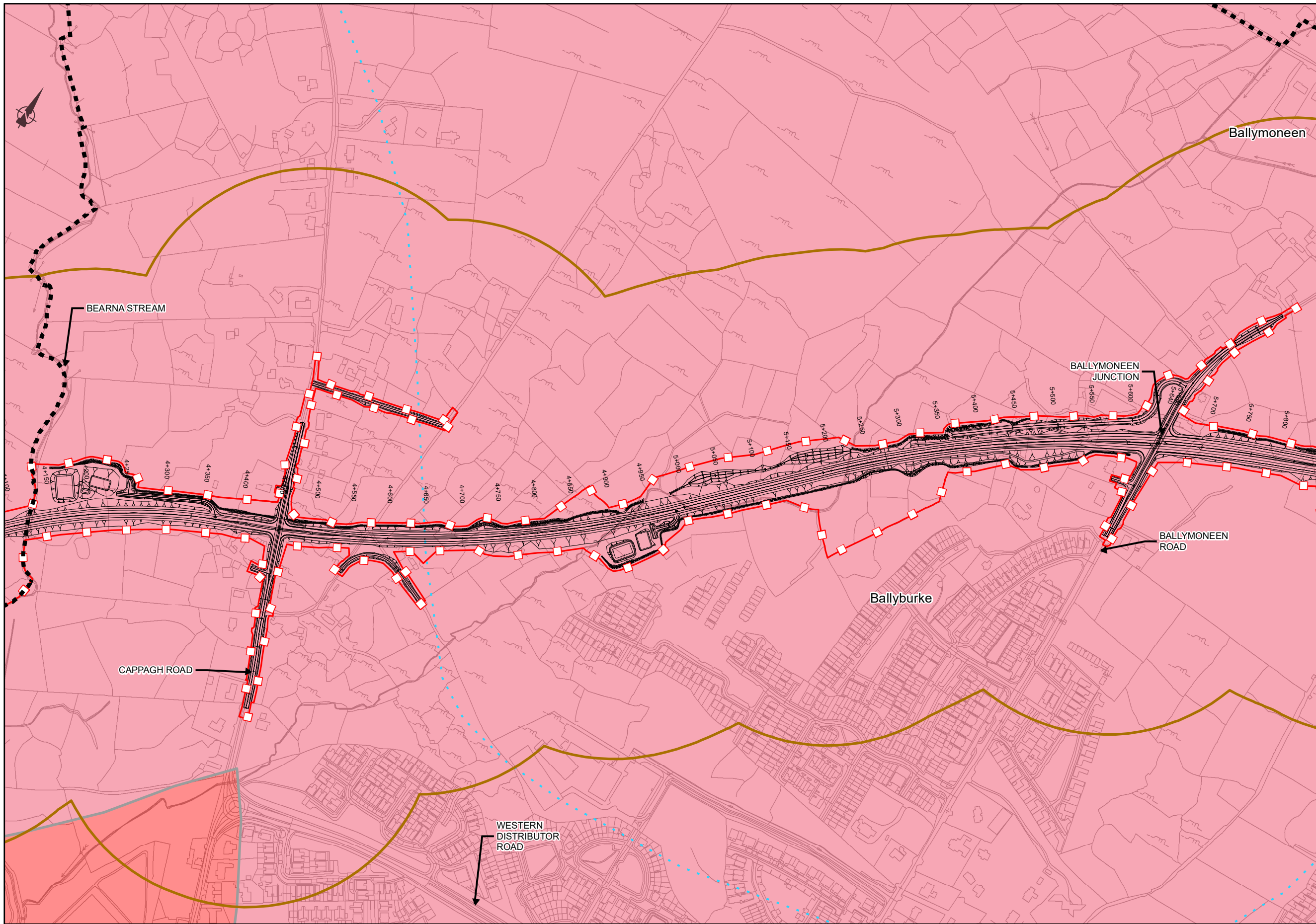

EIA REPORT

Legend

- City Boundary
- Proposed Development Boundary
- ▨ Proposed Road Development
- ▭ Study Area 250m Buffer Zone
- ⋯ Area of abundant P-dykes
- Boundary of igneous intrusion

Bedrock Formations

- █ Errisbeg Townland Granite
- █ Murvey Granite

San áireamh tá sonraíocht Shuirbhéireacht Ordánais Éireann arna atáirgeadh faoi Cheadúnas OSI Uimh. 2010/18CCMA/Comhairle Contae na Gaillimhe. Sáraíonn atáirgeadh neamhdánaithe cóipeacht Shuirbhéireacht Ordánais Éireann agus Rialtas na hÉireann. © Suirbhéireacht Ordánais Éireann, 2010.

©: Suirbhéireacht Ordánais Éireann. Gach ceart ar chosaint. Uimhir cheadúnais 2010/18CCMA/Comhairle Contae na Gaillimhe.

Includes Ordnance Survey Ireland data reproduced under OSI Licence number 2010/18CCMA/Galway County Council. Unauthorised reproduction infringes Ordnance Survey Ireland and Government of Ireland copyright. © Ordnance Survey Ireland, 2010.

©: Ordnance Survey Ireland. All rights reserved. Licence number 2010/18CCMA/Galway County Council.

Clients

Comhairle Chontae na Gaillimhe
Galway County Council

N6
Galway City Transport Project

GA
An Roinn Iompair
Turastóireacht agus Spóirt
Department of Transport, Tourism and Sport

TIIV
Transport Infrastructure Ireland

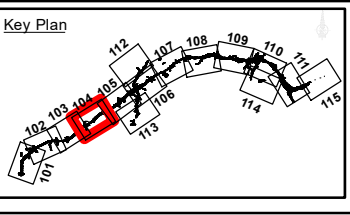

Consultant

ARUP

Corporate House
City East Business Park
Ballybrit, Galway, Ireland

Tel +353 (0)91 460675
www.N6GalwayCity.ie
www.arup.ie

Job Title

N6 Galway City Ring Road

Scale: 1:5,000

Date: September 2018

I1	28/09/2018	KJ	MH	EMC
Issue	Date	By	Chkd	Appd

Drawing Title

**Solid Geology Mapping
Sheet 04 of 15**

Drawing Status

FOR INFORMATION

Job No	Drawing No	Issue
233985-00	Figure 9.5.104	11

EIA REPORT

- Legend**
- City Boundary
 - Proposed Development Boundary
 - ▨ Proposed Road Development
 - ▭ Study Area 250m Buffer Zone
 - ⋯ Area of abundant P-dykes
 - Fault
- Bedrock Formations**
- █ Errisbeg Townland Granite

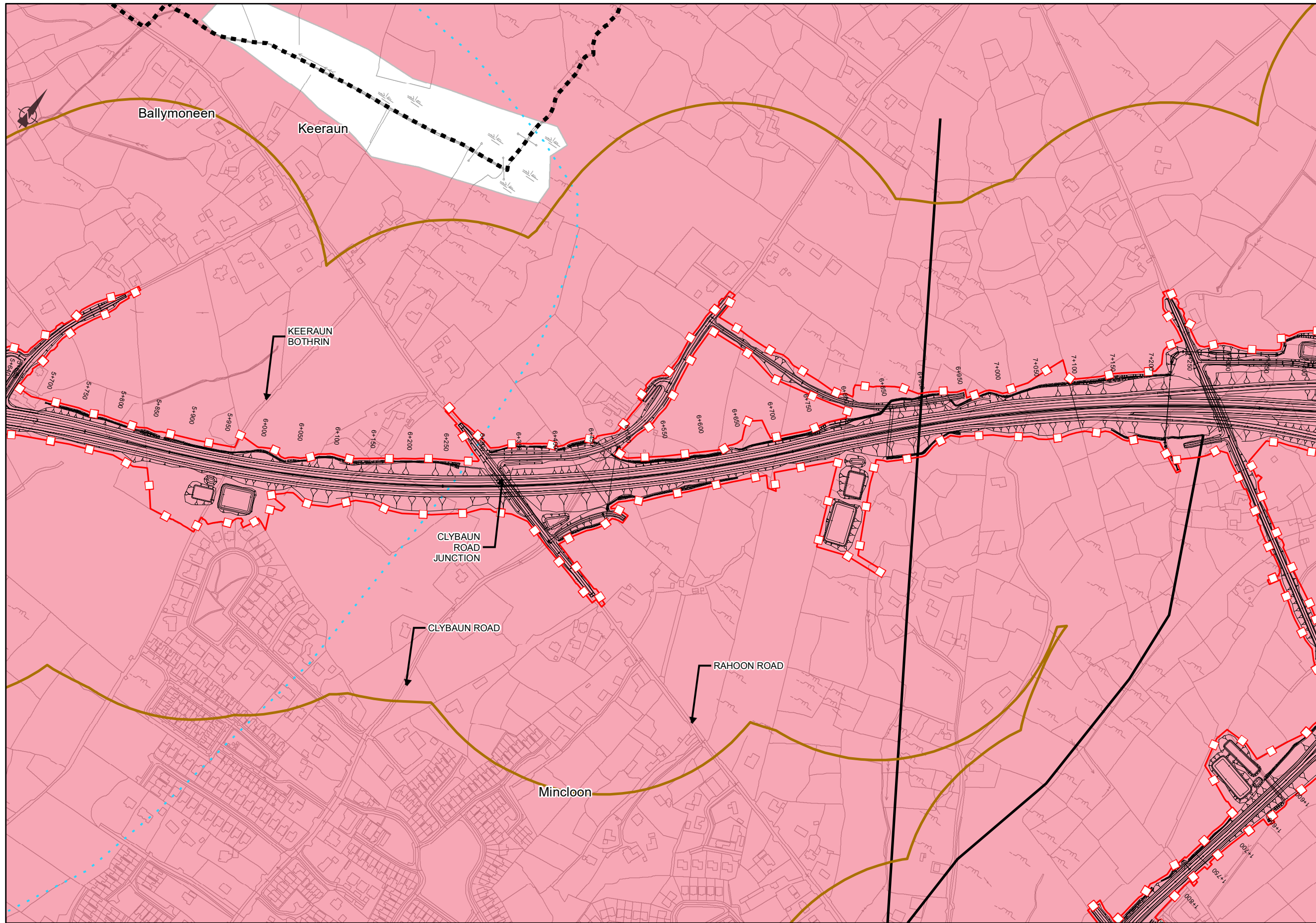

San áireamh tá sonraíocht Shuirbhéireacht Ordánais Éireann arna atáirgeadh faoi Cheadúnas OSI Uimh. 2010/18CCMA/Comhairle Contae na Gaillimhe. Sáralonn atáirgeadh neamhdánaithe cóipeacht Shuirbhéireacht Ordánais Éireann agus Rialtas na hÉireann. © Suirbhéireacht Ordánais Éireann, 2010.

©: Suirbhéireacht Ordánais Éireann. Gach ceart ar chosaint. Uimhir cheadúnais 2010/18CCMA/Comhairle Contae na Gaillimhe.

Includes Ordnance Survey Ireland data reproduced under OSI Licence number 2010/18CCMA/Galway County Council. Unauthorised reproduction infringes Ordnance Survey Ireland and Government of Ireland copyright. © Ordnance Survey Ireland, 2010.

©: Ordnance Survey Ireland. All rights reserved. Licence number 2010/18CCMA/Galway County Council.

Clients

Comhairle Chontae na Gaillimhe
Galway County Council

Galway City Transport Project

Ar Roinn Iompair
Turasóireachta agus Spóirt
Department of Transport, Tourism and Sport

TIIV
Transport Infrastructure Ireland

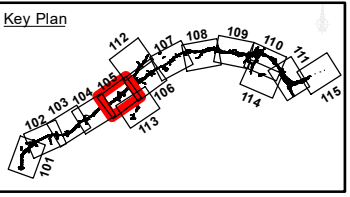

Consultant

ARUP

Corporate House
City East Business Park
Ballybrit, Galway, Ireland

Tel +353 (0)91 460675
www.N6GalwayCity.ie
www.arup.ie

Job Title
N6 Galway City Ring Road

Scale: 1:5,000

Date: September 2018

I1	28/09/2018	KJ	MH	EMC
Issue	Date	By	Chkd	Appd

Drawing Title
Solid Geology Mapping
Sheet 05 of 15

Drawing Status
FOR INFORMATION

Job No	Drawing No	Issue
233985-00	Figure 9.5.105	11

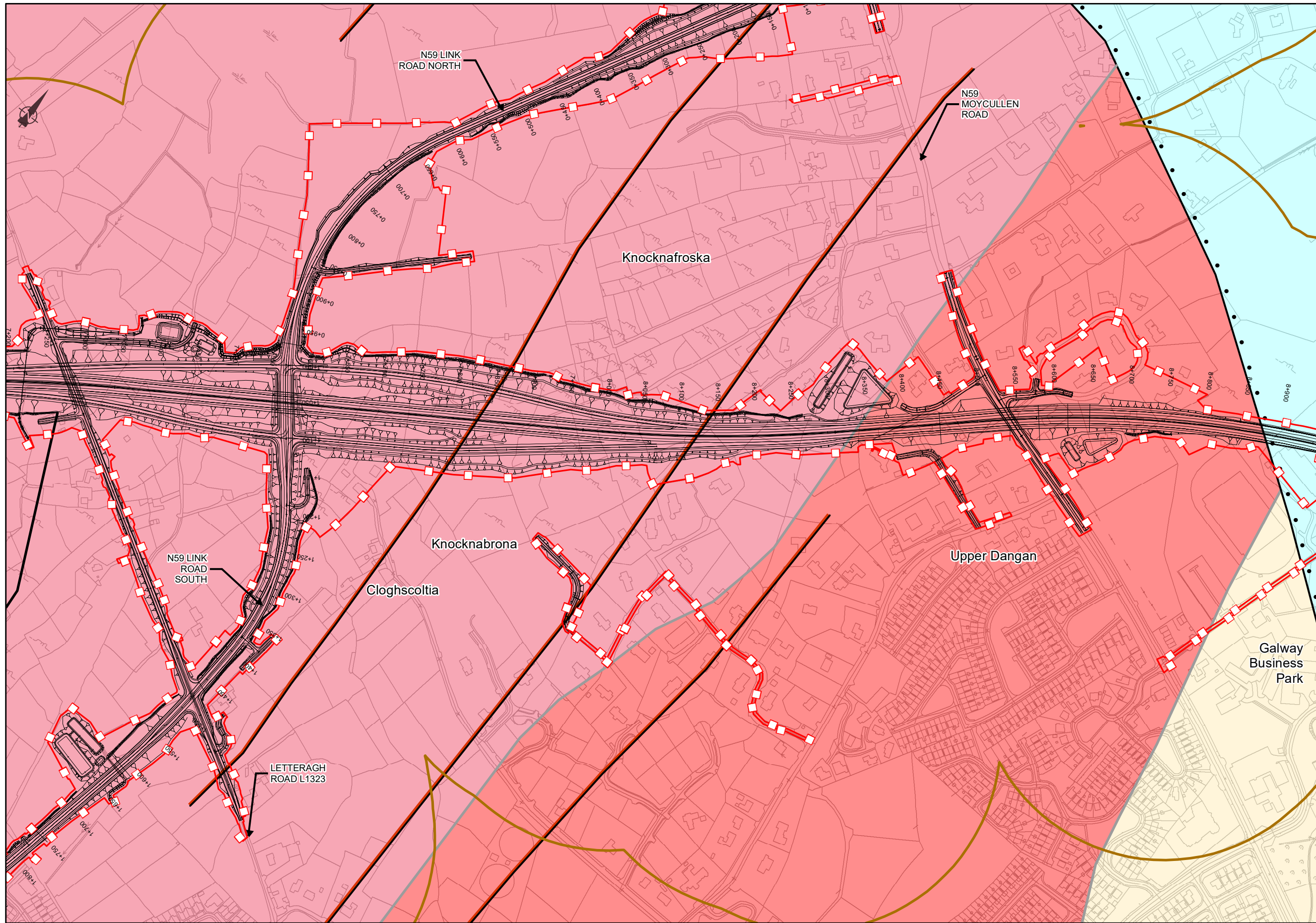

EIA REPORT

Legend

- City Boundary
- Proposed Development Boundary
- Proposed Road Development
- Study Area 250m Buffer Zone
- Boundary of igneous intrusion
- Dyke/Sill
- Unconformity
- Fault

Bedrock Formations

- Errisbeg Townland Granite
- Metagabbro & Orthogneiss Suite
- Murvey Granite
- Visean Limestones (undifferentiated)

San áireamh tá sonraíocht Shuirbhéireacht Ordánais Éireann arna áirgeadh faoi Cheadúnas OSI Uimh. 2010/18CCMA/Comhairle Contae na Gaillimhe. Sáralonn áirgeadh neamhdánaithe cóipeacht Shuirbhéireacht Ordánais Éireann agus Rialtas na hÉireann. © Suirbhéireacht Ordánais Éireann, 2010.

©: Suirbhéireacht Ordánais Éireann. Gach ceart ar chosaint. Uimhir cheadúnais 2010/18CCMA/Comhairle Contae na Gaillimhe.

Includes Ordnance Survey Ireland data reproduced under OSI Licence number 2010/18CCMA/Galway County Council. Unauthorised reproduction infringes Ordnance Survey Ireland and Government of Ireland copyright. © Ordnance Survey Ireland, 2010.

©: Ordnance Survey Ireland. All rights reserved. Licence number 2010/18CCMA/Galway County Council.

Clients

Comhairle Chontae na Gaillimhe
Galway County Council

AN6
Galway City Transport Project

GA
An Roinn Iompair
Turasóireachta agus Spóirt
Department of Transport, Tourism and Sport

TIIV
Transport Infrastructure Ireland

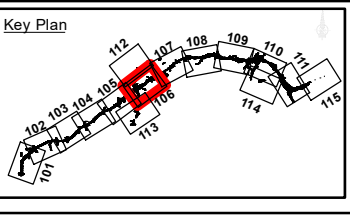

Consultant

ARUP

Corporate House
City East Business Park
Ballybrit, Galway, Ireland

Tel +353 (0)91 460675
www.N6GalwayCity.ie
www.arup.ie

Job Title

N6 Galway City Ring Road

Scale: 1:5,000

Date: September 2018

I1	28/09/2018	KJ	MH	EMC
Issue	Date	By	Chkd	Appd

Drawing Title

**Solid Geology Mapping
Sheet 06 of 15**

FOR INFORMATION

Job No	Drawing No	Issue
233985-00	Figure 9.5.106	11

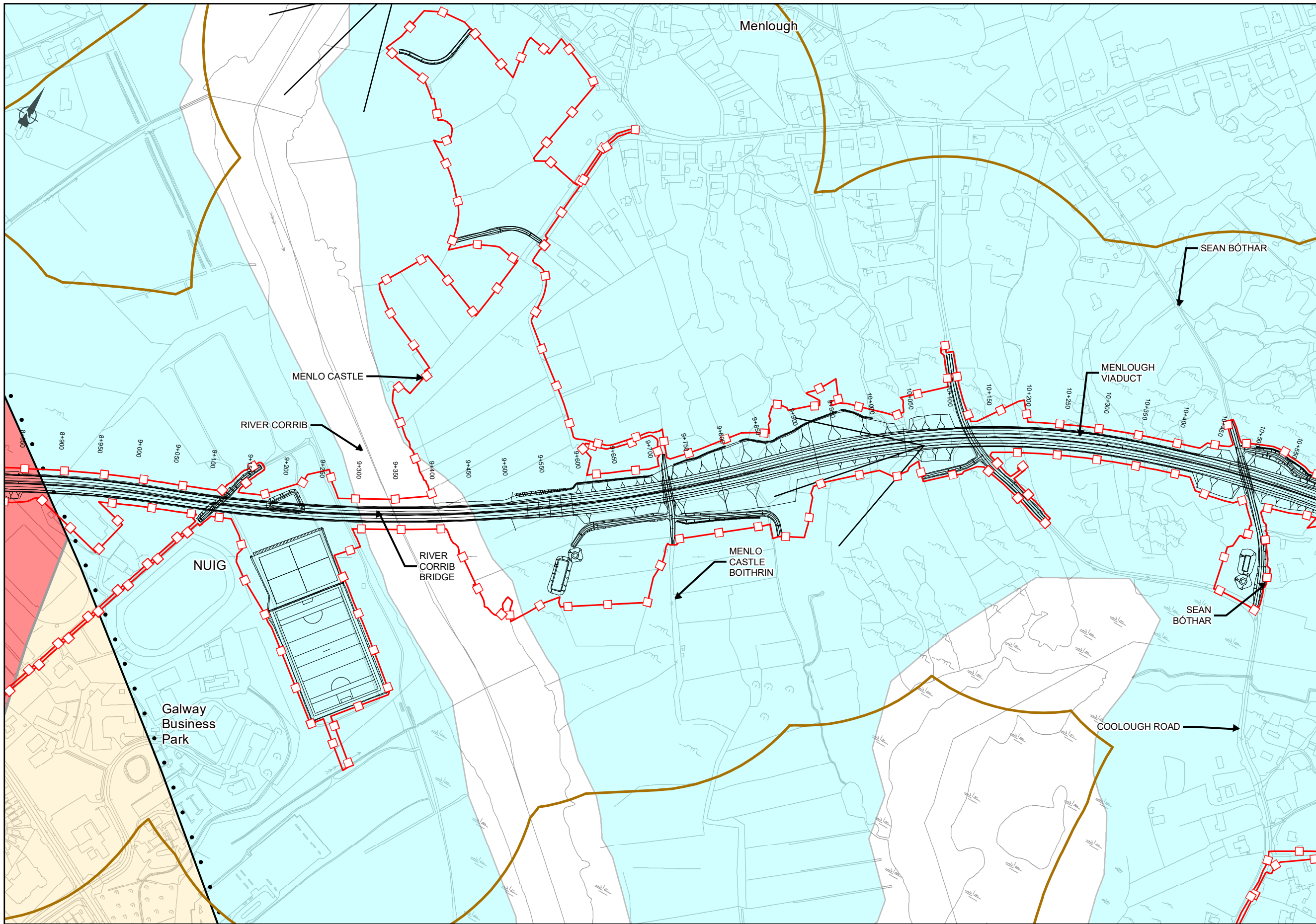

EIA REPORT

Legend

- ■ ■ City Boundary
- Proposed Development Boundary
- ▬ Proposed Road Development
- ▭ Study Area 250m Buffer Zone
- ▬ Boundary of igneous intrusion
- Unconformity
- Symbols 100k

Bedrock Formations

- Metagabbro & Orthogneiss Suite
- Murvey Granite
- Visean Limestones (undifferentiated)

San áireamh tá sonraíocht Shuirbhéireacht Ordánais Éireann arna áirgeadh faoi Cheadúnas OSI Uimh. 2010/18CCMA/Comhairle Contae na Gaillimhe. Sáralonn áirgeadh neamhdánaithe cóipeacht Shuirbhéireacht Ordánais Éireann agus Rialtas na hÉireann. © Suirbhéireacht Ordánais Éireann, 2010.

© Suirbhéireacht Ordánais Éireann. Gach ceart ar chosaint. Uimhir cheadúnais 2010/18CCMA/Comhairle Contae na Gaillimhe.

Includes Ordnance Survey Ireland data reproduced under OSI Licence number 2010/18CCMA/Galway County Council. Unauthorised reproduction infringes Ordnance Survey Ireland and Government of Ireland copyright. © Ordnance Survey Ireland, 2010.

© Ordnance Survey Ireland. All rights reserved. Licence number 2010/18CCMA/Galway County Council.

Clients

Comhairle Chontae na Gaillimhe
Galway County Council

Galway City Transport Project

Galway County Council

Ar Roinn Iompair
Tarasóireachta agus Spóirt
Department of Transport, Tourism and Sport

TIIV
Transport Infrastructure Ireland

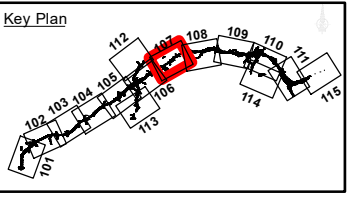

Consultant

ARUP

Corporate House
City East Business Park
Ballybrit, Galway, Ireland

Tel +353 (0)91 460675
www.N6GalwayCity.ie
www.arup.ie

Job Title

N6 Galway City Ring Road

Scale: 1:5,000

Date: September 2018

I1	28/09/2018	KJ	MH	EMC
Issue	Date	By	Chkd	Appd

Drawing Title

**Solid Geology Mapping
Sheet 07 of 15**

FOR INFORMATION

Job No	Drawing No	Issue
233985-00	Figure 9.5.107	11

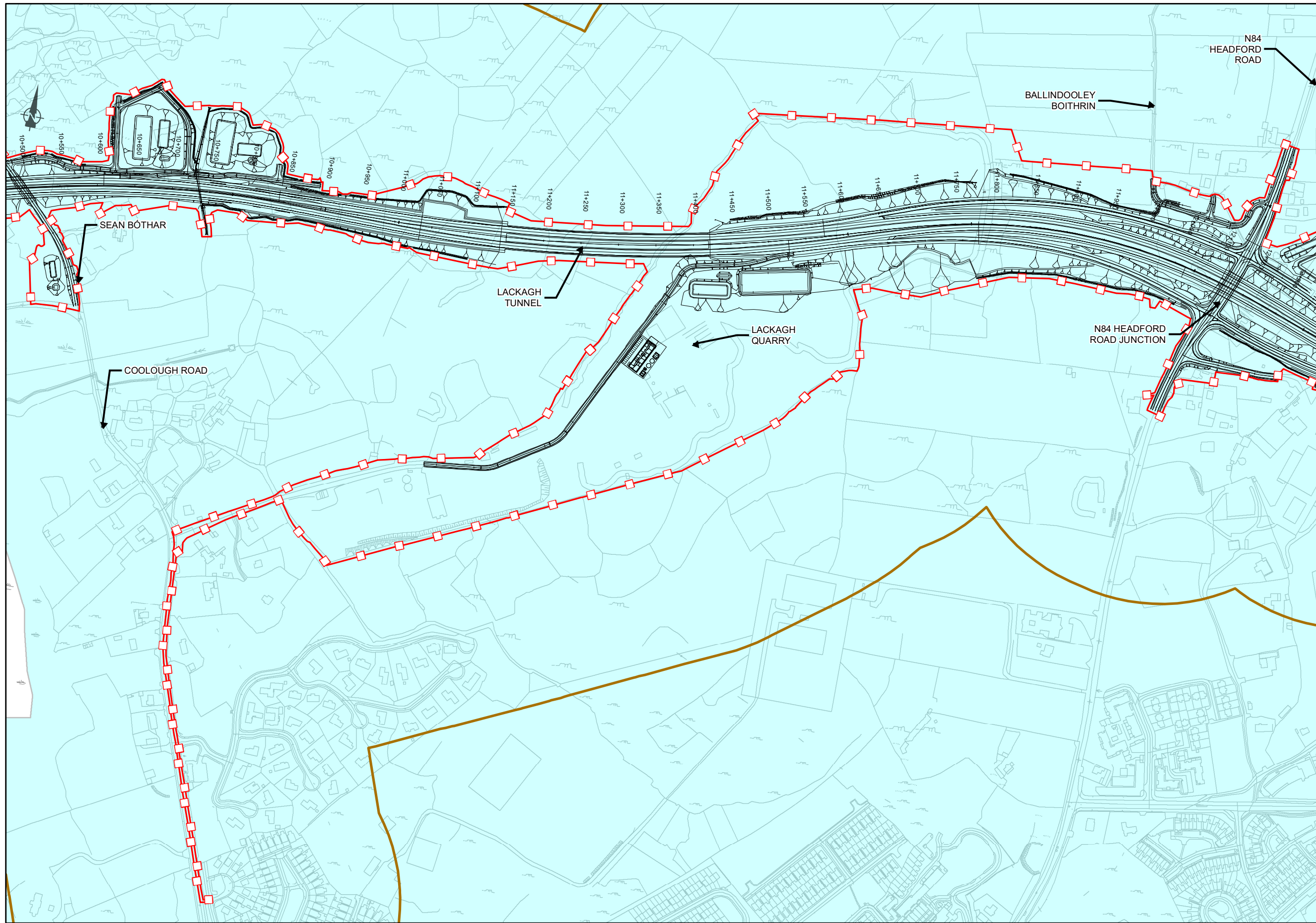

EIA REPORT

Legend

- ■ ■ City Boundary
- Proposed Development Boundary
- ▨ Proposed Road Development
- ▭ Study Area 250m Buffer Zone

Bedrock Formations

- Visean Limestones (undifferentiated)

San áireamh tá sonraíocht Shuirbhéireacht Ordánais Éireann arna atáirgeadh faoi Cheadúnas OSI Uimh. 2010/18CCMA/Comhairle Contae na Gaillimhe. Sáraíonn atáirgeadh neamhdánaithe cóipeacht Shuirbhéireacht Ordánais Éireann agus Rialtas na hÉireann. © Suirbhéireacht Ordánais Éireann, 2010.

©: Suirbhéireacht Ordánais Éireann. Gach ceart ar chosaint. Uimhir cheadúnais 2010/18CCMA/Comhairle Contae na Gaillimhe.

Includes Ordnance Survey Ireland data reproduced under OSI Licence number 2010/18CCMA/Galway County Council. Unauthorised reproduction infringes Ordnance Survey Ireland and Government of Ireland copyright. © Ordnance Survey Ireland, 2010.

©: Ordnance Survey Ireland. All rights reserved. Licence number 2010/18CCMA/Galway County Council.

Clients

Comhairle Chontae na Gaillimhe
Galway County Council

AN6
Galway City Transport Project

GA
An Roinn Iompair
Turasóireachta agus Spóirt
Department of Transport, Tourism and Sport

TIIV
Transport Infrastructure Ireland

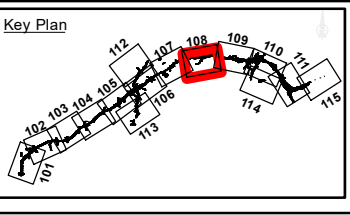

Consultant

ARUP

Corporate House
City East Business Park
Ballybrit, Galway, Ireland

Tel +353 (0)91 460675
www.N6GalwayCity.ie
www.arup.ie

Job Title

N6 Galway City Ring Road

Scale: 1:5,000

Date: September 2018

I1	28/09/2018	KJ	MH	EMC
Issue	Date	By	Chkd	Appd

Drawing Title

**Solid Geology Mapping
Sheet 08 of 15**

Drawing Status

FOR INFORMATION

Job No	Drawing No	Issue
233985-00	Figure 9.5.108	I1

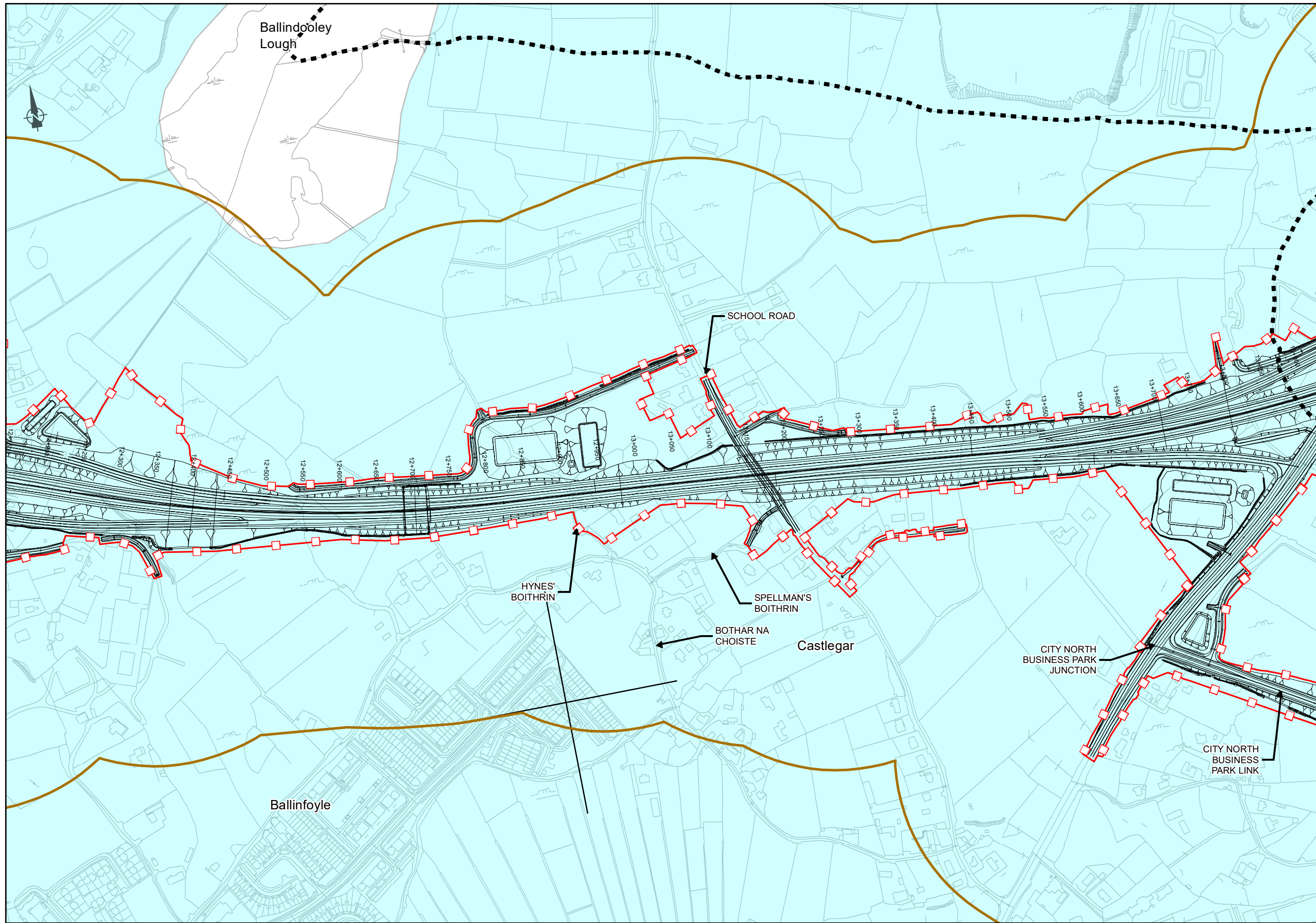

EIA REPORT

Legend

- City Boundary
- Proposed Development Boundary
- Proposed Road Development
- Study Area 250m Buffer Zone
- Symbols 100k

Bedrock Formations

- Visean Limestones (undifferentiated)

San áireamh tá sonraíocht Shuirbhéireacht Ordánais Éireann arna atáirgeadh faoi Cheadúnas OSI Uimhir. 2010/18CCMA/Comhairle Contae na Gaillimhe. Sáralonn atáirgeadh neamhdánaithe cóipeacht Shuirbhéireacht Ordánais Éireann agus Rialtas na hÉireann. © Suirbhéireacht Ordánais Éireann, 2010.

©: Suirbhéireacht Ordánais Éireann. Gach ceart ar chosaint. Uimhir cheadúnais 2010/18CCMA/Comhairle Contae na Gaillimhe.

Includes Ordnance Survey Ireland data reproduced under OSI Licence number 2010/18CCMA/Galway County Council. Unauthorised reproduction infringes Ordnance Survey Ireland and Government of Ireland copyright. © Ordnance Survey Ireland, 2010.

©: Ordnance Survey Ireland. All rights reserved. Licence number 2010/18CCMA/Galway County Council.

Clients

Comhairle Chontae na Gaillimhe
Galway County Council

Galway City Transport Project

Ar Roinn Iompair
Tarasóireachta agus Spóirt
Department of Transport, Tourism and Sport

TIIV
Transport Infrastructure Ireland

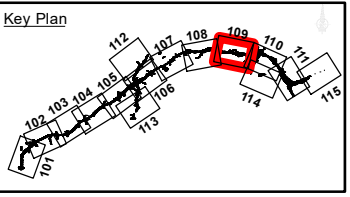

Consultant

ARUP

Corporate House
City East Business Park
Ballybrit, Galway, Ireland

Tel +353 (0)91 460675
www.N6GalwayCity.ie
www.arup.ie

Job Title

N6 Galway City Ring Road

Scale: 1:5,000

Date: September 2018

I1	28/09/2018	KJ	MH	EMC
Issue	Date	By	Chkd	Appd

Drawing Title

**Solid Geology Mapping
Sheet 09 of 15**

Drawing Status

FOR INFORMATION

Job No	Drawing No	Issue
233985-00	Figure 9.5.109	11

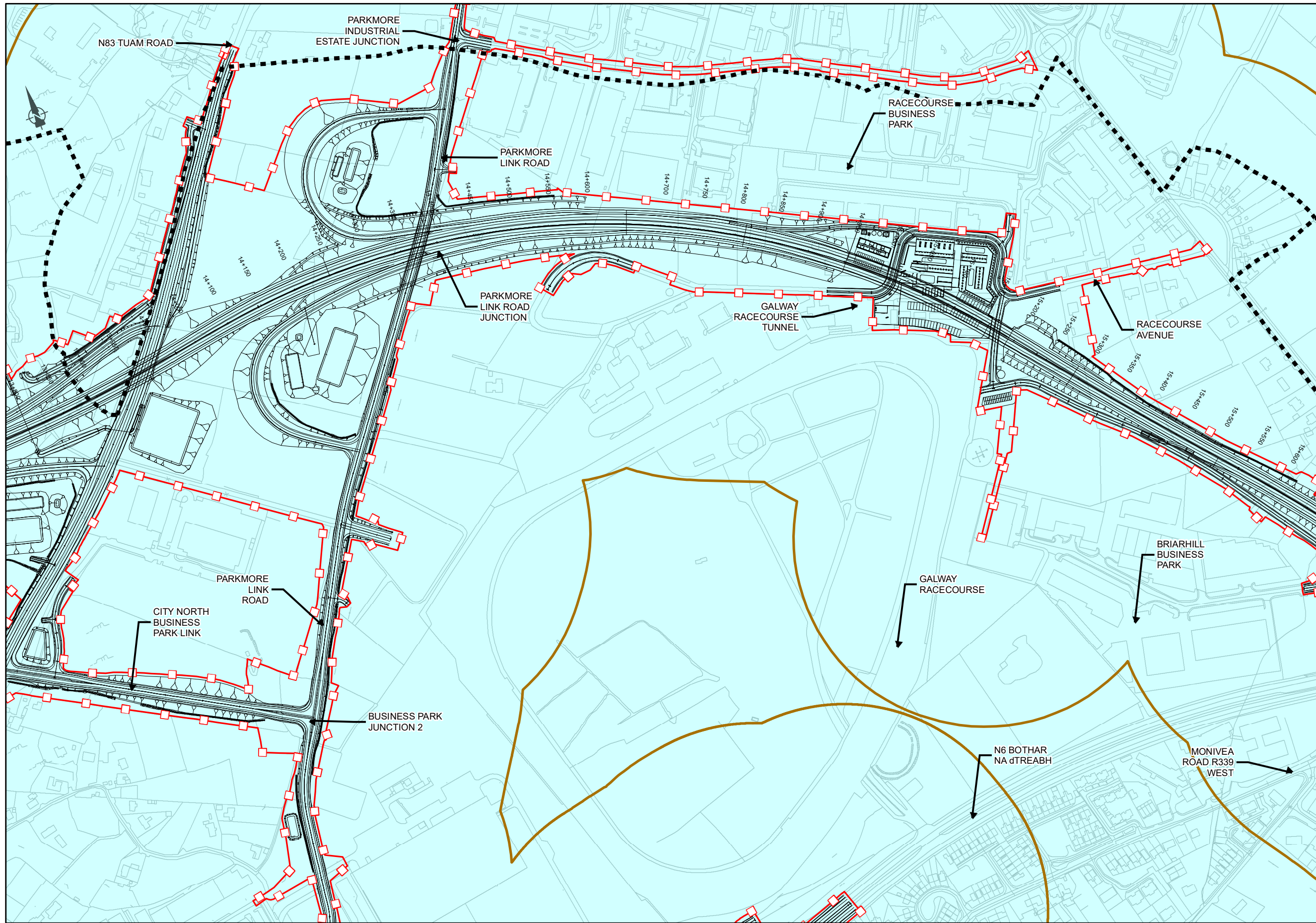

EIA REPORT

Legend

- City Boundary
- Proposed Development Boundary
- Proposed Road Development
- Study Area 250m Buffer Zone

Bedrock Formations

- Visean Limestones (undifferentiated)

San áireamh tá sonraíocht Shuirbhéireacht Ordánais Éireann arna áitgeadh faoi Cheadúnas OSI Uimh. 2010/18CCMA/Comhairle Contae na Gaillimhe. Sáralonn áitgeadh neamhdánaithe cóipeacht Shuirbhéireacht Ordánais Éireann agus Rialtas na hÉireann. © Suirbhéireacht Ordánais Éireann, 2010.

©: Suirbhéireacht Ordánais Éireann. Gach ceart ar chosaint. Uimhir cheadúnais 2010/18CCMA/Comhairle Contae na Gaillimhe.

Includes Ordnance Survey Ireland data reproduced under OSI Licence number 2010/18CCMA/Galway County Council. Unauthorised reproduction infringes Ordnance Survey Ireland and Government of Ireland copyright. © Ordnance Survey Ireland, 2010.

©: Ordnance Survey Ireland. All rights reserved. Licence number 2010/18CCMA/Galway County Council.

Clients

Comhairle Chontae na Gaillimhe
Galway County Council

N6 Galway City Transport Project

GA An Roinn Iompair Tarasóireachta agus Spóirt
Department of Transport, Tourism and Sport

TIIV

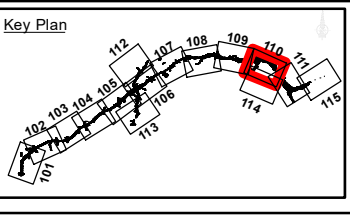

Consultant

ARUP

Corporate House
City East Business Park
Ballybrit, Galway, Ireland

Tel +353 (0)91 460675
www.N6GalwayCity.ie
www.arup.ie

Job Title

N6 Galway City Ring Road

Scale: 1:5,000

Date: September 2018

I1	28/09/2018	KJ	MH	EMC
Issue	Date	By	Chkd	Appd

Drawing Title

**Solid Geology Mapping
Sheet 10 of 15**

FOR INFORMATION

Job No	Drawing No	Issue
233985-00	Figure 9.5.110	11

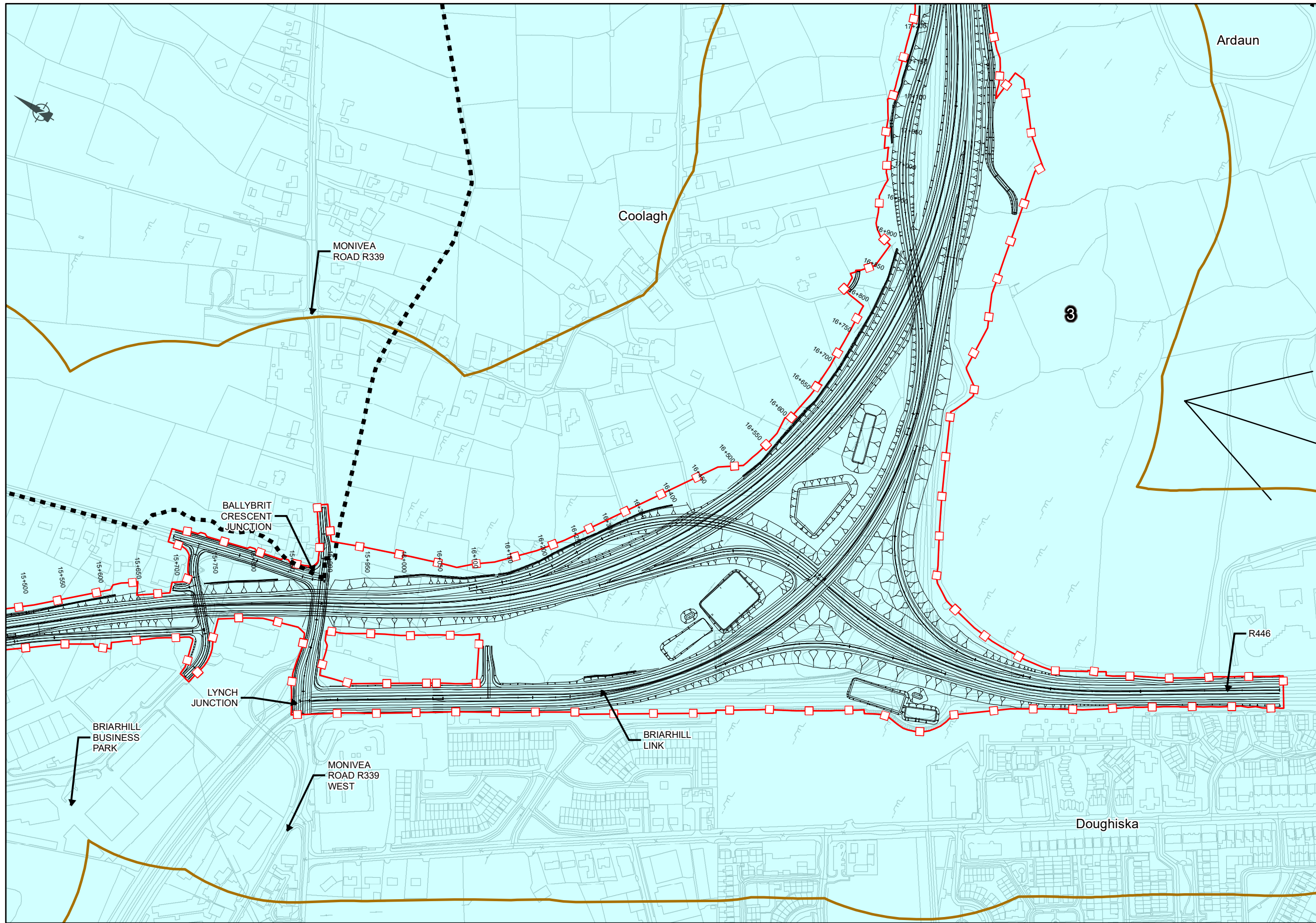

EIA REPORT

Legend

- City Boundary
- Proposed Development Boundary
- ▨ Proposed Road Development
- ▭ Study Area 250m Buffer Zone
- Symbols 100k

Bedrock Formations

- Visean Limestones (undifferentiated)

San áireamh tá sonraíocht Shuirbhéireacht Ordánais Éireann arna áitúigeadh faoi Cheadúnas OSI Uimhir. 2010/18CCMA/Comhairle Contae na Gaillimhe. Sáralonn áitúigeadh neamhdánaithe cóipeacht Shuirbhéireacht Ordánais Éireann agus Rialtas na hÉireann. © Suirbhéireacht Ordánais Éireann, 2010.

©: Suirbhéireacht Ordánais Éireann. Gach ceart ar chosaint. Uimhir cheadúnais 2010/18CCMA/Comhairle Contae na Gaillimhe.

Includes Ordnance Survey Ireland data reproduced under OSI Licence number 2010/18CCMA/Galway County Council. Unauthorised reproduction infringes Ordnance Survey Ireland and Government of Ireland copyright. © Ordnance Survey Ireland, 2010.

©: Ordnance Survey Ireland. All rights reserved. Licence number 2010/18CCMA/Galway County Council.

Clients

Comhairle Chontae na Gaillimhe
Galway County Council

Galway City Transport Project

Galway County Council

Ar Roinn Iompair
Turasóireachta agus Spóirt
Department of Transport, Tourism and Sport

TII
Transport Infrastructure Ireland

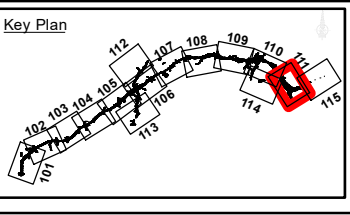

Consultant

ARUP

Corporate House
City East Business Park
Ballybrit, Galway, Ireland

Tel +353 (0)91 460675
www.N6GalwayCity.ie
www.arup.ie

Job Title

N6 Galway City Ring Road

Scale: **1:5,000**

Date: **September 2018**

I1	28/09/2018	KJ	MH	EMC
Issue	Date	By	Chkd	Appd

Drawing Title

**Solid Geology Mapping
Sheet 11 of 15**

FOR INFORMATION

Job No	Drawing No	Issue
233985-00	Figure 9.5.111	11

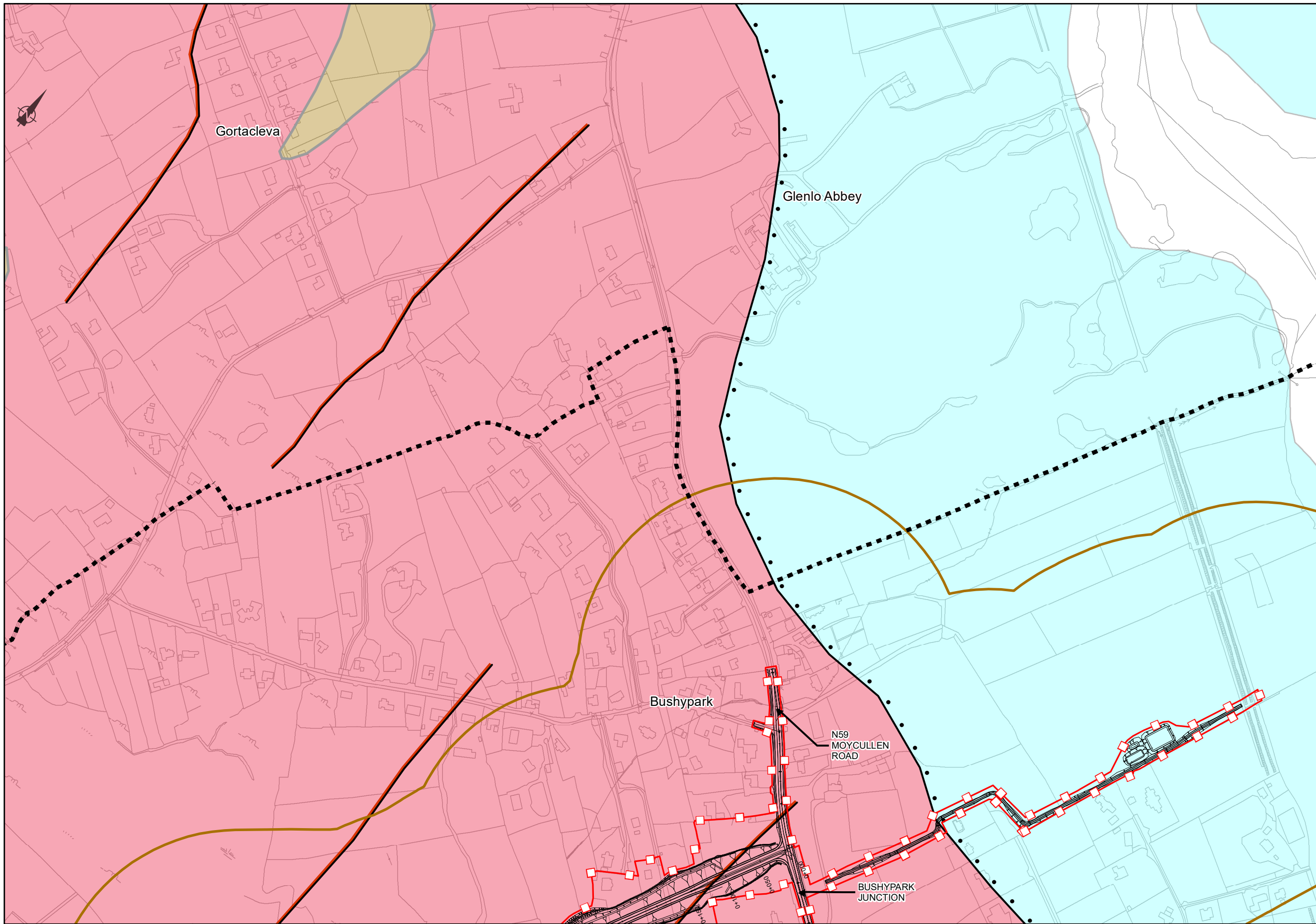

EIA REPORT

Legend

- City Boundary
- Proposed Development Boundary
- ▨ Proposed Road Development
- ▭ Study Area 250m Buffer Zone
- Boundary of igneous intrusion
- Dyke/Sill
- Unconformity

Bedrock Formations

- █ Errisbeg Townland Granite
- █ Quartz Porphyry & Felsite
- █ Visean Limestones (undifferentiated)

San áireamh tá sonraíocht Shuirbhéireacht Ordánais Éireann arna atáirgeadh faoi Cheadúnas OSI Uimh. 2010/18CCMA/Comhairle Contae na Gaillimhe. Sáralonn atáirgeadh neamhdánaithe cóipcheart Shuirbhéireacht Ordánais Éireann agus Rialtas na hÉireann. © Suirbhéireacht Ordánais Éireann, 2010.

©: Suirbhéireacht Ordánais Éireann. Gach ceart ar chosaint. Uimhir cheadúnais 2010/18CCMA/Comhairle Contae na Gaillimhe.

Includes Ordnance Survey Ireland data reproduced under OSI Licence number 2010/18CCMA/Galway County Council. Unauthorised reproduction infringes Ordnance Survey Ireland and Government of Ireland copyright. © Ordnance Survey Ireland, 2010.

©: Ordnance Survey Ireland. All rights reserved. Licence number 2010/18CCMA/Galway County Council.

Clients

Comhairle Chontae na Gaillimhe
Galway County Council

AN6
Galway City Transport Project

GA
An Roinn Iompair
Tarasóireacht agus Spóirt
Department of Transport, Tourism and Sport

TIIV
Transport Infrastructure and Vehicle

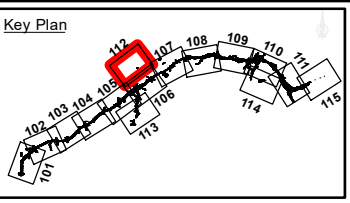

Consultant

ARUP

Corporate House
City East Business Park
Ballybrit, Galway, Ireland

Tel +353 (0)91 460675
www.N6GalwayCity.ie
www.arup.ie

Job Title

N6 Galway City Ring Road

Scale: 1:5,000

Date: September 2018

I1	28/09/2018	KJ	MH	EMC
Issue	Date	By	Chkd	Appd

Drawing Title

**Solid Geology Mapping
Sheet 12 of 15**

Drawing Status

FOR INFORMATION

Job No	Drawing No	Issue
233985-00	Figure 9.5.112	11

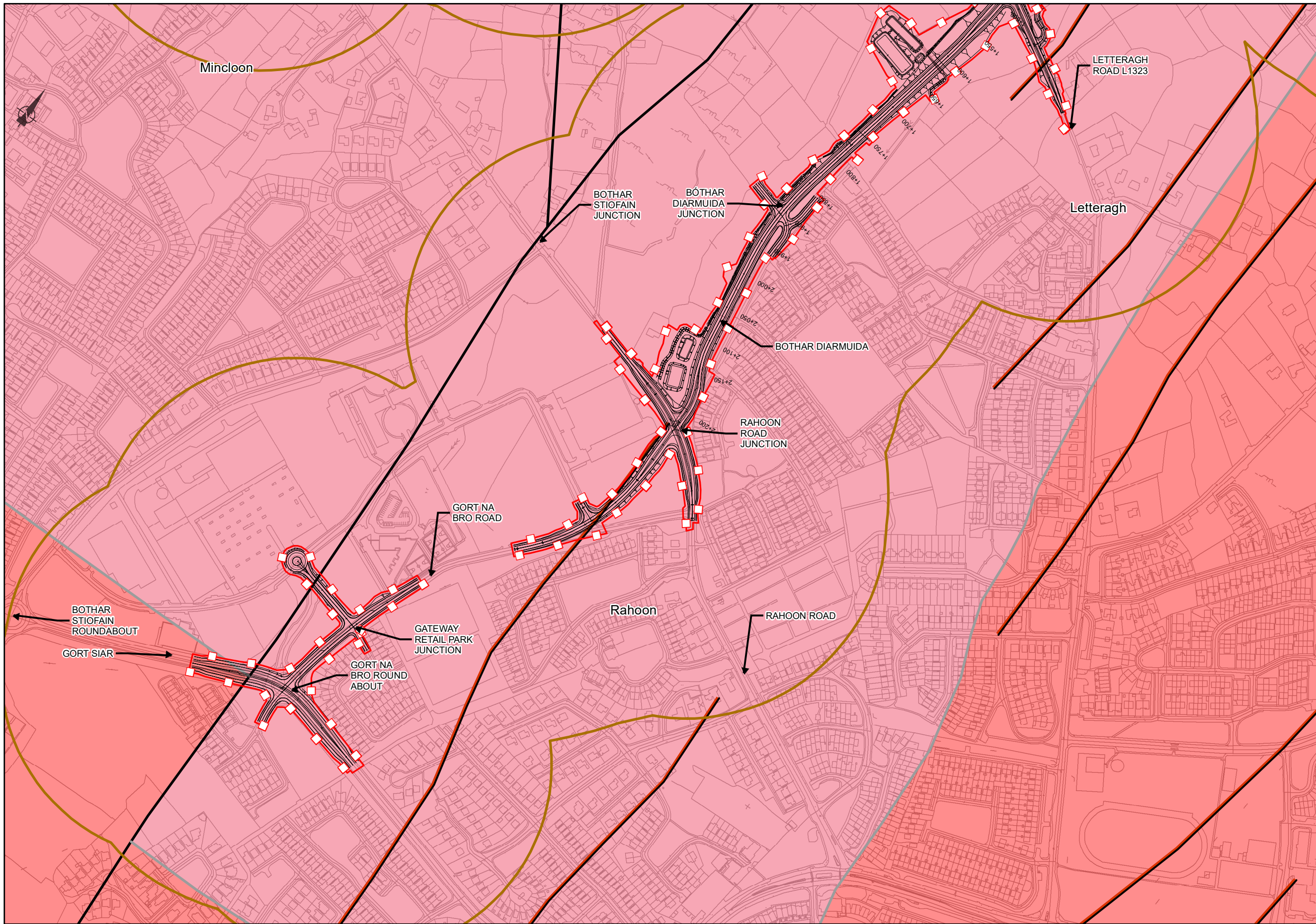

EIA REPORT

Legend

- City Boundary
- Proposed Development Boundary
- Proposed Road Development
- Study Area 250m Buffer Zone
- Boundary of igneous intrusion
- Dyke/Sill
- Fault

Bedrock Formations

- Errisbeg Townland Granite
- Murvey Granite

San áireamh tá sonraíocht Shuirbhéireacht Ordánais Éireann arna atáirgeadh faoi Cheadúnas OSI Uimh. 2010/18CCMA/Comhairle Contae na Gaillimhe. Sáraíonn atáirgeadh neamhdánaithe cóipeacht Shuirbhéireacht Ordánais Éireann agus Rialtas na hÉireann. © Suirbhéireacht Ordánais Éireann, 2010.

© Suirbhéireacht Ordánais Éireann. Gach ceart ar chosaint. Uimhir cheadúnais 2010/18CCMA/Comhairle Contae na Gaillimhe.

Includes Ordnance Survey Ireland data reproduced under OSI Licence number 2010/18CCMA/Galway County Council. Unauthorised reproduction infringes Ordnance Survey Ireland and Government of Ireland copyright. © Ordnance Survey Ireland, 2010.

© Ordnance Survey Ireland. All rights reserved. Licence number 2010/18CCMA/Galway County Council.

Clients

Comhairle Chontae na Gaillimhe
Galway County Council

AN6
Galway City Transport Project

GA
An Roinn Iompair
Turasoireachta agus Spóirt
Department of Transport, Tourism and Sport

TIIV
Transport Infrastructure and Vehicle

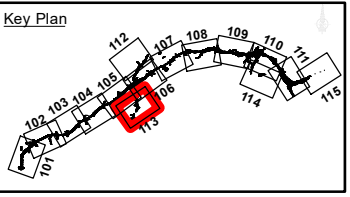

Consultant

ARUP

Corporate House
City East Business Park
Ballybrit, Galway, Ireland

Tel +353 (0)91 460675
www.N6GalwayCity.ie
www.arup.ie

Job Title

N6 Galway City Ring Road

Scale: 1:5,000

Date: September 2018

I1	28/09/2018	KJ	MH	EMC
Issue	Date	By	Chkd	Appd

Drawing Title

**Solid Geology Mapping
Sheet 13 of 15**

Drawing Status

FOR INFORMATION

Job No	Drawing No	Issue
233985-00	Figure 9.5.113	I1

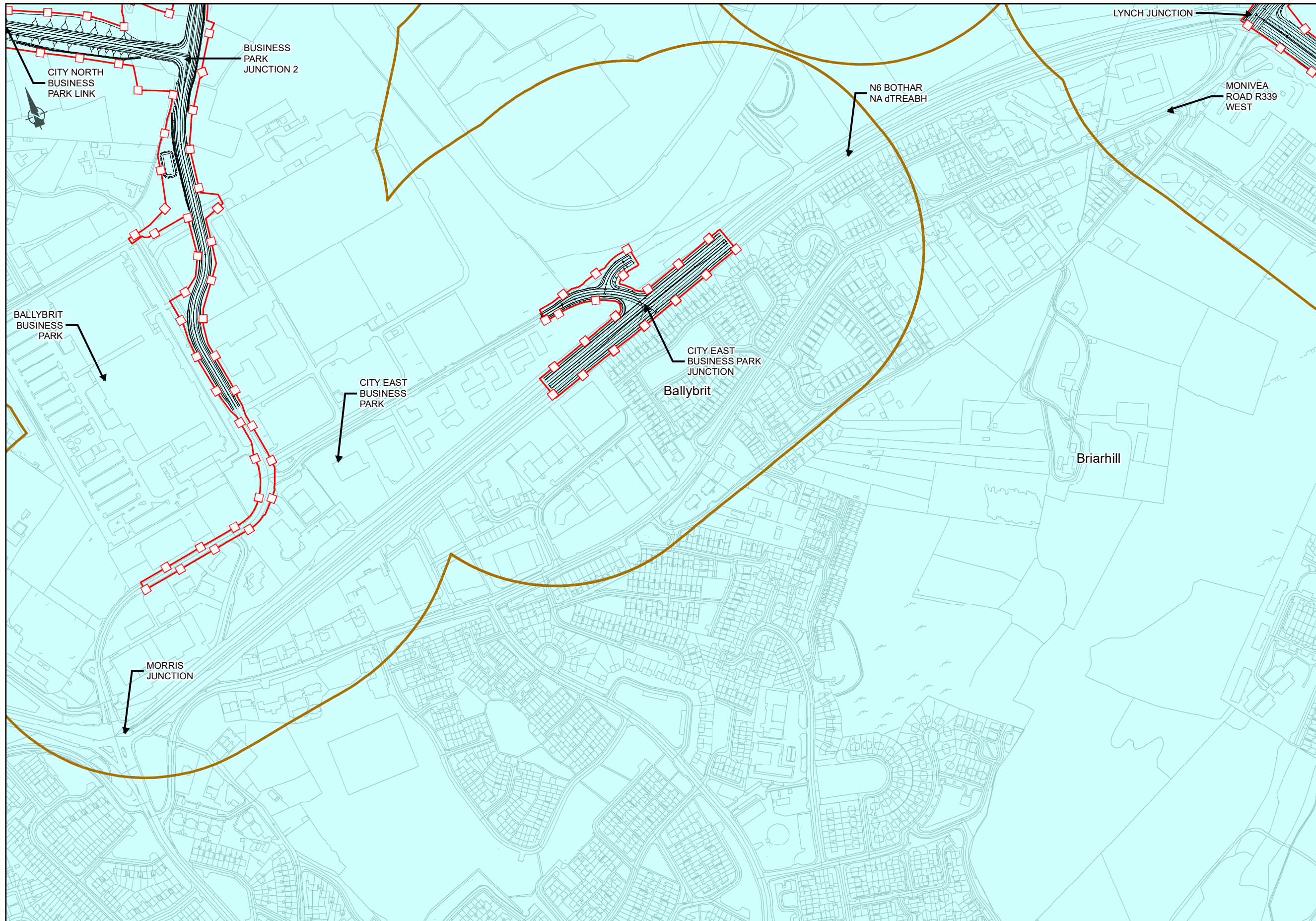

EIA REPORT

Legend

- City Boundary
- - - Proposed Development Boundary
- ▬▬▬ Proposed Road Development
- ▭ Study Area 250m Buffer Zone

Bedrock Formations

- ▭ Visean Limestones (undifferentiated)

San áireamh tá sonraíocht Shuirbhéireacht Ordánais Éireann arna atáirgeadh faoi Cheadúnas OSI Uimh. 2010/18CCMA/Comhairle Contae na Gaillimhe. Sáraíonn atáirgeadh neamhdánaithe cóipeacht Shuirbhéireacht Ordánais Éireann agus Rialtas na hÉireann. © Suirbhéireacht Ordánais Éireann, 2010.

©: Suirbhéireacht Ordánais Éireann. Gach ceart ar chosaint. Uimhir cheadúnais 2010/18CCMA/Comhairle Contae na Gaillimhe.

Includes Ordnance Survey Ireland data reproduced under OSI Licence number 2010/18CCMA/Galway County Council. Unauthorised reproduction infringes Ordnance Survey Ireland and Government of Ireland copyright. © Ordnance Survey Ireland, 2010.

©: Ordnance Survey Ireland. All rights reserved. Licence number 2010/18CCMA/Galway County Council.

Clients

Comhairle Chontae na Gaillimhe
Galway County Council

AN6
Galway City Transport Project

GA
An Roinn Iompair
Tarasóireacht agus Spóirt
Department of Transport, Tourism and Sport

TIIV
Transport Infrastructure Ireland

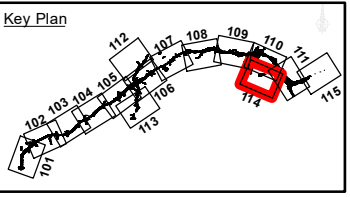

Consultant

ARUP

Corporate House
City East Business Park
Ballybrit, Galway, Ireland

Tel +353 (0)91 460675
www.N6GalwayCity.ie
www.arup.ie

Job Title

N6 Galway City Ring Road

Scale: 1:5,000

Date: September 2018

I1	28/09/2018	KJ	MH	EMC
Issue	Date	By	Chkd	Appd

Drawing Title

**Solid Geology Mapping
Sheet 14 of 15**

Drawing Status

FOR INFORMATION

Job No	Drawing No	Issue
233985-00	Figure 9.5.114	11

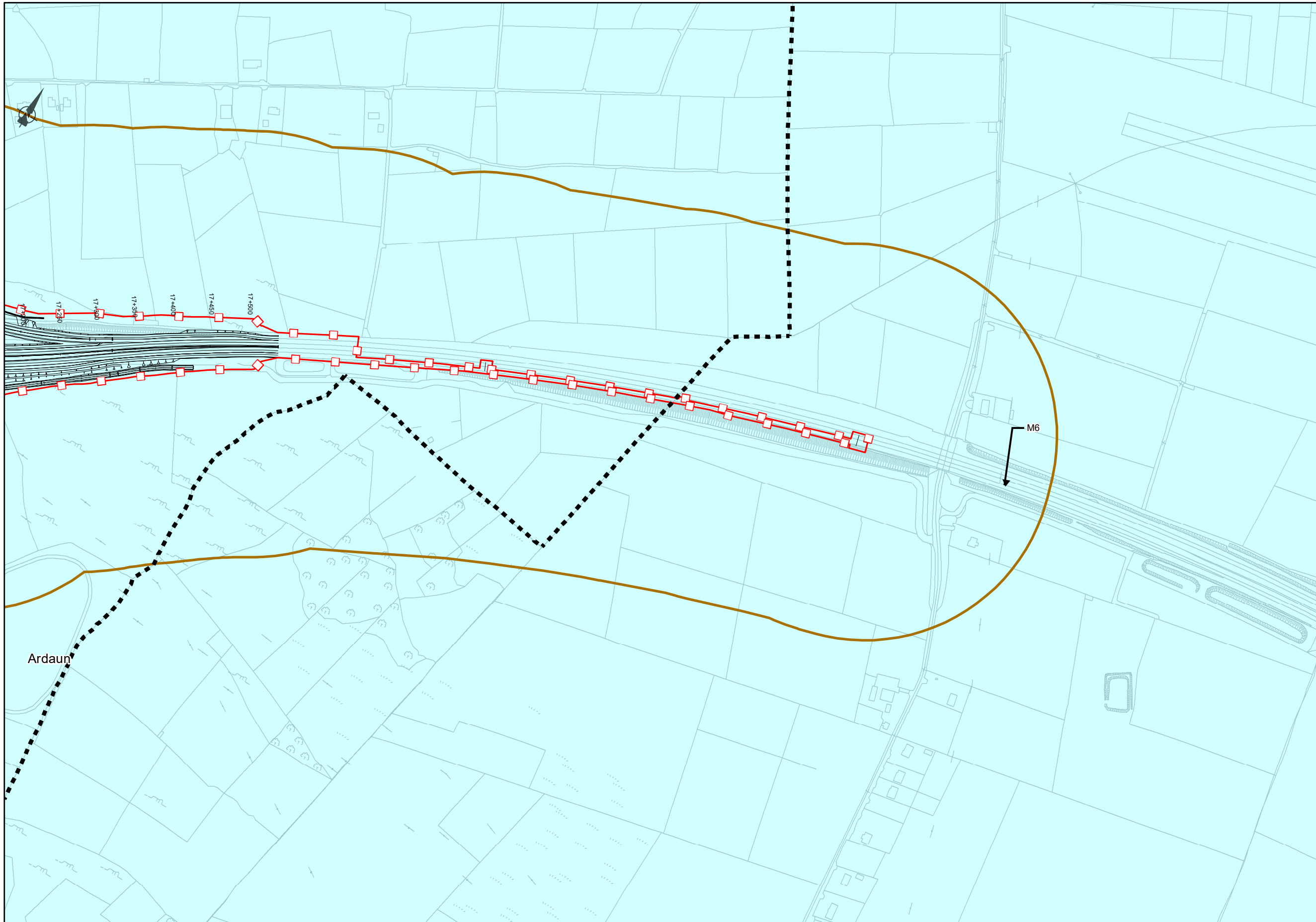

EIA REPORT

Legend

- ■ ■ ■ City Boundary
 - Proposed Development Boundary
 - ▨ Proposed Road Development
 - ▭ Study Area 250m Buffer Zone
- Bedrock Formations**
- ▭ Visean Limestones (undifferentiated)

San áireamh tá sonraíocht Shuirbhéireacht Ordánais Éireann arna áiríteadh faoi Cheadúnas OSI Uimh. 2010/18CCMA/Comhairle Contae na Gaillimhe. Sáralonn áiríteadh neamhdánaithe cóipeacht Shuirbhéireacht Ordánais Éireann agus Rialtas na hÉireann. © Suirbhéireacht Ordánais Éireann, 2010.

©: Suirbhéireacht Ordánais Éireann. Gach ceart ar chosaint. Uimhir cheadúnais 2010/18CCMA/Comhairle Contae na Gaillimhe.

Includes Ordnance Survey Ireland data reproduced under OSI Licence number 2010/18CCMA/Galway County Council. Unauthorised reproduction infringes Ordnance Survey Ireland and Government of Ireland copyright. © Ordnance Survey Ireland, 2010.

©: Ordnance Survey Ireland. All rights reserved. Licence number 2010/18CCMA/Galway County Council.

Clients

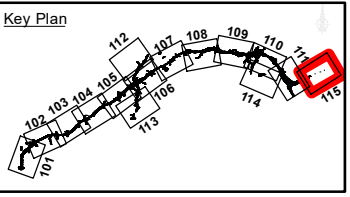

Consultant

Corporate House
City East Business Park
Ballybrit, Galway, Ireland

Tel +353 (0)91 460675
www.N6GalwayCity.ie
www.arup.ie

Job Title
N6 Galway City Ring Road

Scale: 1:5,000

Date: September 2018

I1	26/07/2018	KJ	MH	EMC
Issue	Date	By	Chkd	Appd

Drawing Title
Solid Geology Mapping
Sheet 15 of 15

Drawing Status
FOR INFORMATION

Job No	Drawing No	Issue
233985-00	Figure 9.5.115	11