

ROUTE SELECTION

- Legend:**
- Plan**
 - Proposed Geometry Plan
 - Route Corridor
 - Profile**
 - Existing Ground
 - Proposed Geometry Profile
 - FILL 15+m
 - FILL 10m - 15m
 - FILL 05m - 10m
 - FILL 00m - 05m
 - CUT 00m - 05m
 - CUT 05m - 10m
 - CUT 10m - 15m
 - CUT 15+m
 - TUNNEL

San díreamh tá sonraíocht Shuirbhíreacht Ordois Éireann arna eiligiú le fíor Cheadúnas OSI Uimh. 2010/15CCMA/Comhairle Contae na Gaillimhe. Sárailinn atáirgeadh neamhdáraithe cóipeacht Shuirbhíreacht Ordois Éireann agus Riailtas na hÉireann. © Suirbhíreacht Ordois Éireann, 2010.
 Includes Ordnance Survey Ireland data reproduced under OSI Licence number 2010/15CCMA/Galway County Council. Unauthorised reproduction infringes Ordnance Survey Ireland and Government of Ireland copyright. © Ordnance Survey Ireland, 2010.

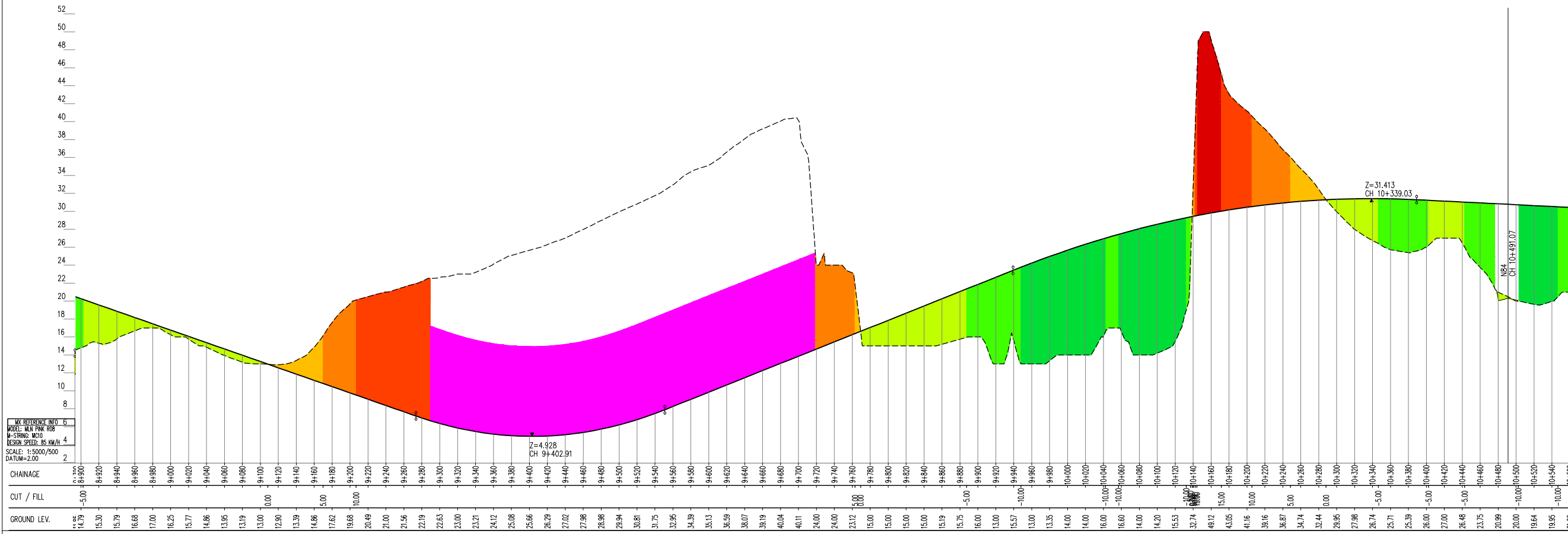

CHAINAGE	CUT / FILL	GROUND LEV.
8+900	-5.00	14.79
8+920	-5.00	15.30
8+940	-5.00	15.79
8+960	-5.00	16.68
8+980	-5.00	17.00
9+000	-5.00	16.25
9+020	-5.00	15.77
9+040	-5.00	14.86
9+060	-5.00	13.95
9+080	-5.00	13.19
9+100	-5.00	13.00
9+120	-5.00	12.90
9+140	-5.00	13.39
9+160	-5.00	14.08
9+180	-5.00	17.62
9+200	10.00	19.68
9+220	10.00	20.49
9+240	10.00	21.00
9+260	10.00	21.58
9+280	10.00	22.19
9+300	10.00	22.63
9+320	10.00	23.00
9+340	10.00	23.27
9+360	10.00	24.12
9+380	10.00	25.08
9+400	10.00	25.66
9+420	10.00	26.29
9+440	10.00	27.02
9+460	10.00	27.98
9+480	10.00	28.98
9+500	10.00	29.94
9+520	10.00	30.81
9+540	10.00	31.75
9+560	10.00	32.95
9+580	10.00	34.39
9+600	10.00	35.13
9+620	10.00	36.59
9+640	10.00	38.07
9+660	10.00	39.19
9+680	10.00	40.04
9+700	10.00	40.11
9+720	10.00	24.00
9+740	10.00	24.12
9+760	10.00	15.00
9+780	10.00	15.00
9+800	10.00	15.00
9+820	10.00	15.00
9+840	10.00	15.00
9+860	10.00	15.19
9+880	10.00	15.75
9+900	10.00	16.00
9+920	10.00	13.00
9+940	10.00	15.57
9+960	10.00	13.00
9+980	10.00	13.35
10+000	10.00	14.00
10+020	10.00	14.00
10+040	10.00	16.00
10+060	10.00	16.60
10+080	10.00	14.00
10+100	10.00	14.20
10+120	10.00	15.53
10+140	10.00	32.74
10+160	10.00	49.12
10+180	10.00	43.05
10+200	10.00	41.16
10+220	10.00	39.16
10+240	10.00	36.87
10+260	10.00	34.74
10+280	10.00	32.44
10+300	10.00	29.95
10+320	10.00	27.98
10+340	10.00	26.74
10+360	10.00	25.71
10+380	10.00	25.39
10+400	10.00	26.00
10+420	10.00	27.00
10+440	10.00	26.48
10+460	10.00	23.75
10+480	10.00	20.99
10+500	10.00	20.00
10+520	10.00	19.64
10+540	10.00	19.95

Disclaimer Note:
 The constraints and options shown are draft only and subject to change. More detailed assessments, on-going studies and the information received from the public may result in changes to these constraints and options.

Nóta Séanta:
 Tá na srianta agus na roghanna atá léirithe ina bhfoirm dréacht, d'fhéadfaí athraithe teacht orthu. Is mar thoradh ar mheasúnaithe níos mionchruinne, ar staidéar leanúnach agus ar eolas ón bpobal go ndéanfar athruithe ar na srianta agus na roghanna seo.

Clients

Galway City Transport Project

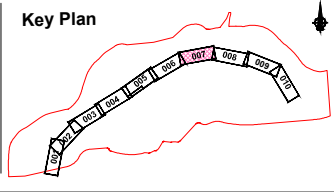

Consultant

Corporate House
 City East Business Park
 Ballybrit, Galway, Ireland.

Tel +353 (0)91 460675
 www.N6GalwayCity.ie
 www.arup.ie

Job Title
N6 Galway City Transport Project

Scale
 1:5000 @ A3

Date
 August 2015

Issue	Date	By	Chkd	Appd
I1	28/08/2015	KJ	MH	EMC

Drawing Title
 Stage 2 Pink Route Option
 Mainline Plan /Profile - CH.8+900 to CH.10+550
 Sheet 7 of 10

Drawing Status
Route Selection

Job No
233985

Drawing No
Figure 7.3.5.7

Issue
11